

BOOK 2396

# FIELD NOTES

MAY 18 1913

OF THE SURVEY OF THE

Subdivision and Meanders of

T. 3 N., R. 7 E.,

SALT RIVER INDIAN RESERVATION,

Of the Gila and Salt River Principal Meridian,

In the State of Arizona,

EXECUTED BY

Robert A. Farmer,

Topographer,

In the capacity of U. S. Surveyor, under instructions dated October 11-, 1910,

issued by the ~~United States Surveyor General to govern surveys included in~~

~~Group No.~~                     , which were approved by the Commissioner of the General Land

to A. F. Dunnington, Topographer in Charge.

Office,                     , ~~191-~~, pursuant to authority contained in the Act of

~~Congress dated~~                     , ~~-- 191-~~

Survey commenced February 18-, 1911.

Survey completed March 9-, 1911.

1A

75

BOOK 2396

# INDEX DIAGRAM.

Township 3 N., Range 7 E.

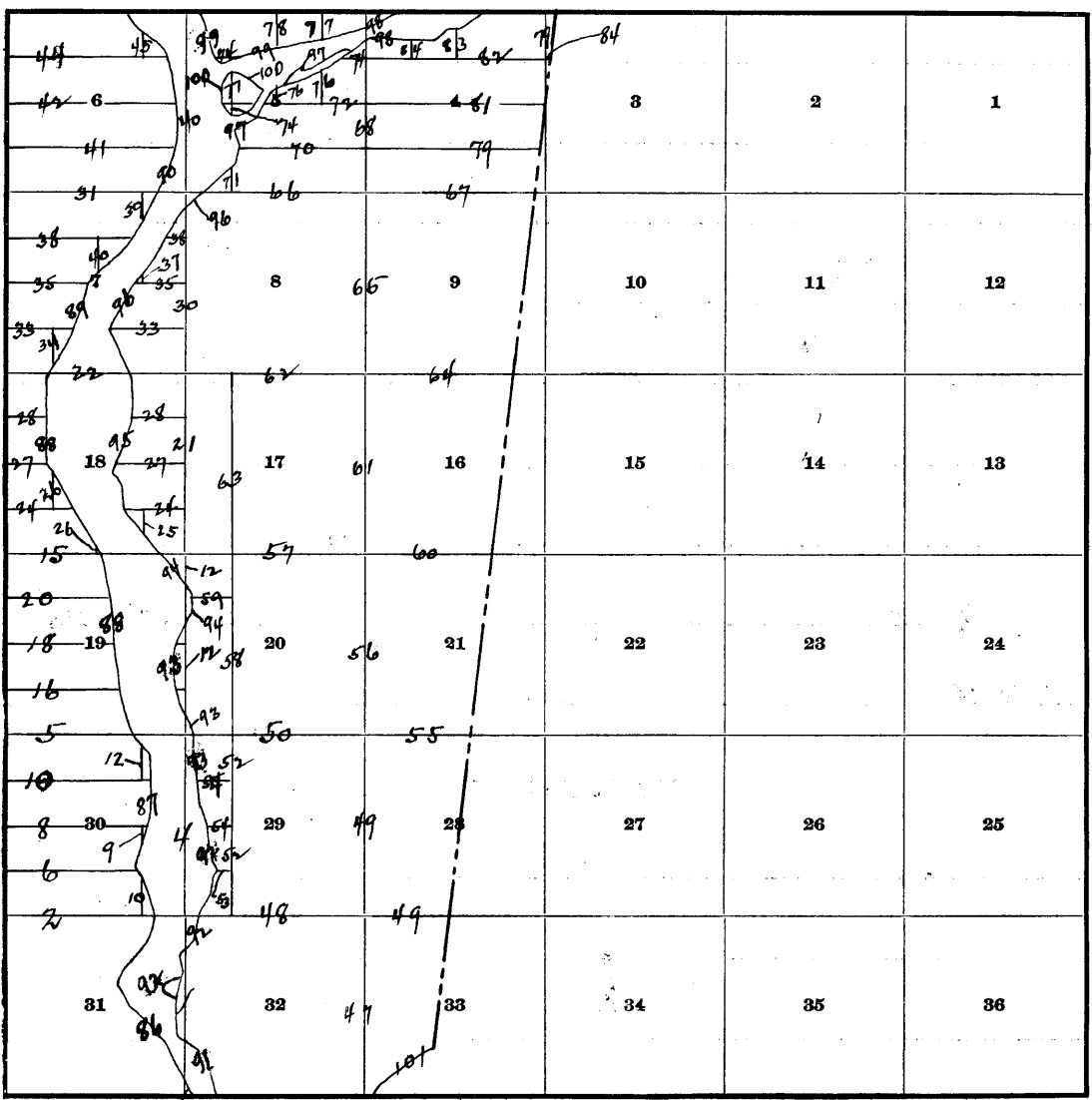

BOOK 2396

Diagram of a section, illustrating the numbering system of the 1/16 section corners.

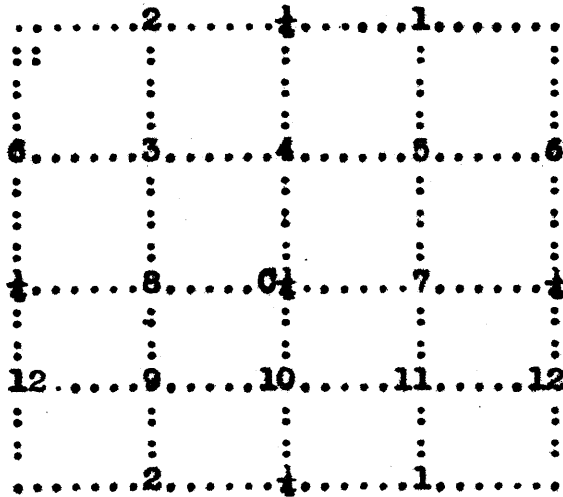

Subdivision T. 3 N., R. 7 E.

Lucas 2200  
77  
10

Chains

February 18, 1911, survey commenced by Robert A. Farmer, Topographer and U. S. Surveyor, and executed with Young & Sons transit No. 8300, with solar attachment. The horizontal limb is provided with double verniers, placed opposite each other, reading to single minutes of arc, which is also the least count of the verniers of the latitude and declination arcs.

Instrument tested and found to be correct on meridian established at camp in sec. 6, T. 3 N., R. 7 E.; for notes of meridian, see Book "A" - Exterior Lines. - The SE. cor. of this tp. is in Lat.  $33^{\circ}33'8''$  N., Long.  $111^{\circ}40'55''$  W. The iron posts used in this survey are 3 ft. long, 1 inch in diam. (unless otherwise described), and are set 26 ins. in the ground. The posts are filled with cement, pointed and driven. Posts which are 3 ins. in diam. are flanged and spread at the bottom ends.

February 18, 1911, at 8h., a.m., l.m.t., I set off  $33^{\circ}33'$  N. on the latitude arc,  $11^{\circ}50'$  S. on the declination arc, and determine a meridian with the solar at the cor. of secs. 5, 6, 31 and 32, on the S. bdy. of the tp., previously described. *Latitude* *Longitude*

Thence I run

N. 0. 1' E. bet. secs. 31 and 32

Over level land,

Through mesquite brush.

3.36 Right bank of Verde River, course SE.

Set an iron post for M. C. of secs. 31 and 32, with brass cap stamped

M C in N.  
1911 in S.  
T 3 N S 31 in SW. quadrant  
R 7 E S 32 " SE. "  
5 notches on the E. edge.

From which -

Palo verde, 12 ins. in diam., hrs. S.  $43^{\circ}$  W., 77 lks. dist., mtd. T 3 N R 7 E S 31 M C B T  
Palo verde, 10 ins. in diam., hrs. N.  $46^{\circ}30'$  W., 182 lks. dist., mtd. T 3 N R 7 E S SE M C B T

Enter shallow channel of Verde River, ~~XXXXXXXXXX~~ 1 ft. deep, course SE.

8.00 Leave channel; thence across sand bar, parallel to bank.

Subdivision T. 3 N., R. 7 E.

Chains

15.00 The right bank of main channel, course SE.

21.90 The left bank of Verde River, 8 ft. high.

Set an iron post for M. C. of secs. 31 and 32, with brass cap stamped

M C 1911 in S.  
T 3 N S 32 in NE. quadrant  
R 7 E S 31 " NW. "  
5 notches on the E. edge.

From which -

Mesquite, 18 ins. in diam., hrs. N. 52° 45' E., 33 lks. dist., mkd. T 3 N R 7 E S 32 M C B T  
Mesquite, 10 ins. in diam., hrs. N. 66° W., 35 lks. dist., mkd. T 3 N R 7 E S 31 M C B T

Thence over flat land, through brush,

23.00 Leave flat land; begin ascent, hrs. NW. and SE.

30.00 Drain, course S. 20° W.

40.00 Set an iron post for  $\frac{1}{2}$  sec. cor. bet. secs. 31 and 32, with brass cap stamped

$\frac{1}{2}$  S 31 in W.  
S 32 " E.  
1911 " S.

Raise mound of stone 2 ft. base,  $1\frac{1}{2}$  ft. high, W. of cor.

No B.T.'s available.

41.00 Top of ascent, hrs. N. 80° E. and S. 80° W.

Begin descent of NW. slope of hill.

62.00 Foot of descent, hrs. N. 60° E. and S. 60° W.

Thence over flat land.

70.00 Left bank of Verde River, course SW.

Set an iron post for M. C. of secs. 31 and 32, with brass cap stamped

M C in N.  
1911 in S.  
T 3 N S 31 in SW. quadrant  
R 7 E S 32 " SE. "  
5 notches on the E. edge.

From which -

Mesquite, 12 ins. in diam., hrs. N. 65° 45' E., 167 lks. dist., mkd. T 3 N R 7 E S 32 M C B T

Dig a pit 36x36x12 ins. 8 ft. S. of post, and raise mound of earth 4 ft. base, 2 ft. high, S. of cor.

Thence across dry channel.

80.00 Point for cor. of secs. 29, 30, 31 and 32, falls on sand bar. I set stake for temp. cor. from which to run

## Chains

both easterly and westerly, bet. secs. 29 and 32, and  
secs. 30 and 31.

Land, flat and rolling.  
Soil, loam, 2nd rate, and rocky, 4th rate.  
Brush, mesquite and greasewood, with scattered palo verde  
bushes.  
Rolling, rocky land, 39.00 chs.

From temp. cor. of secs. 29, 30, 31 and 32, I run  
West on a random line bet. secs. 30 and 31.

20.00 Set temp. 1/16 sec. cor. No. 1.

40.00 Set temp. 1/16 sec. cor.

60.00 Set temp. 1/16 sec. cor. No. 2.

80.00 Intersect the cor. of secs. 25, 30, 31 and 36, on the W.  
bdy. of the tp., previously described.

Thence I run

East on a true line bet. secs. 30 and 31,

Over rolling land, through brush.  
flat

12.00 Leave rolling land; enter table land, brs. N. 15° W. and  
S. 15° E.

20.00 Set an iron post for 1/16 sec. cor. No. 2 bet. secs. 30  
and 31, W $\frac{1}{2}$ , with brass cap stamped

No 2 1/16 S 30 in N.  
S 31 1911 in S.

Dig pits 18x18x12 ins. E. and W. of post 3 ft. dist., and  
raise mound of earth 3 $\frac{1}{2}$  ft. base, 1 $\frac{1}{2}$  ft. high, N. of cor.

No B.T.'s available.

40.00 Set an iron post for 1/4 sec. cor. bet. secs. 30 and 31,  
with brass cap stamped

1/4 S 30 in N.  
S 31 1911 in S.

from which -

Palo verde, 6 ins. in diam., brs. S. 78° 30' E., 26  
lks. dist., mkd. 1/4 S 31 B T  
Palo verde, 6 ins. in diam., brs. N. 87° W., 60 lks.  
dist., mkd. 1/4 S 30 B T

After diligent search, find no trace of old cor.

53.88 Wire fence brs. N. and S.

Leave flat table land and brush; enter field in bottom  
land, brs. N. and S.

60.00 Set an iron post for 1/16 sec. cor. No. 1 bet. secs. 30

Subdivision T. 3 N., R. 7 E.

Chains

and 31,  $\frac{1}{2}$ , with brass cap stamped

No 1  $\frac{1}{16}$  S 30 in N.  
S 31 1911 in S.

Dig pits 18x18x12 ins. E. and W. of post 3 ft. dist.; and raise mound of earth  $3\frac{1}{2}$  ft. base,  $1\frac{1}{2}$  ft. high, N. of cor.

65.80 Wire fence hrs. N. and S.

Leave field; enter brush, hrs. N. and S.

67.59 Right bank of Verde River, course SW.

Set an iron post for M. C. of secs. 30 and 31, with brass cap stamped

M C in N.  
1911 in S.  
T 3 N S 31 in SW. quadrant  
R 7 E S 30 " NW. "  
1 notch on the S.

From which -

Cottonwood, 60 ins. in diam., hrs. N.  $70^{\circ} 15'$  E., 44  
lks. dist., mkd. T 3 N R 7 E S 30 M C B T  
Mesquite, 10 ins. in diam., hrs. N.  $24^{\circ} 30'$  W., 131  
lks. dist., mkd. T 3 N R 7 E S 30 M C B T

Descend 10 ft. bank.

Thence over sand bar.

73.00 Middle of channel, 3 chs. wide.  
80.00 Temp. cor. of secs. 29, 30, 31 and 32.

Land, rolling, flat table, and bottom.  
Soil, 2nd and 3rd rate.  
Rolling, 12 chs. flat table, 41.88 chs. Field, 11.92 chs.  
Brushy bottom, 1.79 chs.  
Brush, greasewood and mesquite, scattered palo verde and cottonwood along river bank.

From the temp. cor. of secs. 29, 30, 31 and 32, I run  
N.  $0^{\circ} 1'$  E. bet. secs. 29 and 30,

On sand bar in Verde River, inside meander lines,

Setting temp. points at intervals of 20.00 chs. on sand  
bar, from which to subdivide secs. 29 and 30.

20.00 Set temp.  $\frac{1}{16}$  sec. cor. No. 12.

40.00 Set temp.  $\frac{1}{2}$  sec. cor.

60.00 set temp.  $\frac{1}{16}$  sec. cor. No. 6.

80.00 Set temp. cor. of secs. 19, 20, 29 and 30, on sand bar.

West on a random line bet. secs. 19 and 30.

20.00 Set temp.  $\frac{1}{16}$  sec. cor. No. 1.

40.00 Set temp.  $\frac{1}{2}$  sec. cor.

Subdivision T. 3 N., R. 7 E.,

Chains

60.00 get temp. 1/16 sec. cor. No. 2.

80.00 Ball 4 lks. N. of cor. of secs. 19, 24, 25 and 30, on the  
W. bdy. of the tp., previously described.

Thence I run  
N. 89° 58' E. on a true line bet. secs. 19 and 30,  
Over flat land, through brush.

18.50 Road hrs. N. and S.

20.00 get an iron post for 1/16 sec. cor. No. 2 bet. secs. 19  
and 30, W $\frac{1}{2}$ , with brass cap stamped  
No 2 1/16 S 19 in N.  
S 30 1911 in S.

From which -  
Mesquite, 8 ins. in diam., hrs. N. 83° E., 167 lks.  
dist., mkd. 1/16 S 19 B T  
Mesquite, 6 ins. in diam., hrs. S. 1° W., 223 lks.  
dist., mkd. 1/16 S 30 B T

32.00 Irrigation ditch, 10 lks. wide, course S.

33.00 Wire fence hrs. N. 45° E. and S. 45° W.  
Leave brush; enter field, hrs. N. and S.

39.70 Wire fence, hrs. N. and S.  
Leave field; enter brush, hrs. N. and S.

40.00 Set an iron post for  $\frac{1}{4}$  sec. cor. bet. secs. 19 and 30,  
with brass cap stamped  
 $\frac{1}{4}$  S 19 in N.  
S 30 1911 in S.

From which -  
Mesquite, 6 ins. in diam., hrs. N. 76° E., 115 lks.  
dist., mkd.  $\frac{1}{4}$  S 19 B T  
Cottonwood, 8 ins. in diam., hrs. S. 74° 15' E., 353  
lks. dist., mkd.  $\frac{1}{4}$  S 30 B T

After diligent search, find no trace of old cor.

44.00 Leave brush, enter cottonwood timber, hrs. N. and S.

53.00 Middle of slough, 2 chs. wide, hrs. N. and S.

58.10 Right bank of verde river, course SE.  
Set an iron post for M. C. of secs. 19 and 30, with brass  
cap stamped  
M C in N.  
1911 in S.  
T 3 N S 30 in SW. quadrant  
R 7 E S 19 " NW. "  
2 notches on the S.

From which -



Subdivision T. 3 N., R. 7 E.

Chains

Mesquite, 12 ins. in diam., hrs. N. 82° W., 103 lks. dist.,  
mkd. T 3 N R 7 E S 19 M C B T  
Cottonwood, 4 ins. in diam., hrs. S. 36° 30' E., 214 lks.  
dist., mkd. T 3 N R 7 E S 30 M C B T

Descend 7 ft. bank to channel of verde River.

Thence over sand bar.

60.00 Point for 1/16 sec. cor. No. 1 bet. secs. 19 and 30, S $\frac{1}{2}$ ,  
falls in river.

64.00 Middle of main channel of Verde River, 2 ft. deep, course  
SE.

80.00 Temp. cor. of secs. 19, 20, 29 and 30, on sand bar.

Land, rolling and level.

Soil, 2nd and 3rd rate.

Brush, greasewood and mesquite; scattered palo verde trees.  
Cottonwood timber, 14-10 chs.

February 18, 1911, at this cor., I set off 11° 48' S. on  
the declination arc, and at 12h. 14m. 10s., D.M.A.M.T.,  
observe the sun on the meridian; the resulting latitude  
is 33° 35' N., or within 1' of the correct latitude.

From point on sand bar for temp. 1/16 sec. cor. No. 12  
bet. secs. 29 and 30, S $\frac{1}{2}$ , I run

West on a random line through S.  $\frac{1}{4}$  of sec. 30.

20.00 Set temp. 1/16 sec. cor. No. 11.

40.00 Set temp. 1/16 sec. cor. No. 10.

60.00 Set temp. 1/16 sec. cor. No. 9.

80.00 Intersect 1/16 sec. cor. No. 12 bet. secs. 25 and 30, S $\frac{1}{2}$ ,  
on the W. bdy. of the tp., previously described.

Thence I run

East on a true line through the S.  $\frac{1}{4}$  of sec. 30

Over rolling land,

Through scattered brush.

20.00 Set an iron post for 1/16 sec. cor. No. 9 ~~km~~ in the center  
of the SW.  $\frac{1}{4}$  of sec. 30, with brass cap stamped

No 9 in N.  
1/16 S 30 in center  
1911 in S.

Raise mound of stone 2 ft. base, 1 $\frac{1}{2}$  ft. high, N. of cor.

No B.T.'s available.

32.00 Leave rolling land; enter level land, hrs. N. and S.

40.00 Set an iron post for 1/16 sec. cor. No. 10 bet. the SE.

Subdivision T. 3 N., R. 7 E.

2398

7  
83

Chains

and SW.  $\frac{1}{4}$ s of sec. 30, with brass cap stamped

No 10 in N.  
1/16 S 30 in center  
1911 in S.

From which -

Palo verde, 10 ins. in diam., brs. S. 76° E., 179 lks. dist., mkd. 1/16 S 30 B T  
Palo verde, 12 ins. in diam., brs. N. 81° 15' W., 160 lks. dist., mkd. 1/16 S 30 B T

41.00 Road brs. N. and S.

42.09 Irrigation ditch, 10 lks. wide, course S.

53.00 Dry wash, 30 lks. wide, course SE.

57.88 Right bank of Verde River, course SE.

Set an iron post for M. C. of sec. 30, with brass cap stamped

M C in E.  
1911 in S.  
1/16 S 30 in W.

Raise mound of stone 2 ft. base, 1 $\frac{1}{2}$  ft. high, W. of cor.

No B.T.'s available.

Descend bluff bank, 20 ft. high, to channel of Verde River, course SE.

Thence over sand bar.

60.00 Point for 1/16 sec. cor. No. 11 falls in river.

76.00 Middle of main channel of Verde River, course SE., 3 ft. deep. 4 chs. wide.

80.00 Temp. 1/16 sec. cor. No. 12, bet. secs. 29 and 30, S $\frac{1}{2}$  on sand bar.

Land, rolling, 32.00 chs.; level, 25.88 chs.; river bed, 22.12 chs.

Soil, 2nd and 3rd rate.

Brush, greasewood, mesquite and scattered palo verde.

-----  
From temp. cor. for  $\frac{1}{4}$  sec. cor. bet. secs. 29 and 30, on sand bar, I run

West on a random line through middle of sec. 30.

20.00 set temp. 1/16 sec. cor. No. 7.

40.00 Set temp. C.  $\frac{1}{4}$  sec. cor.

60.00 Set temp. 1/16 sec. cor. No. 8.

80.00 Fall 2 lks. N. of  $\frac{1}{4}$  sec. cor. bet. secs. 25 and 30, on the W. bdy. of the tp., previously described.

Subdivision T. 3 N., R. 7 E.

Chains

Thence I run  
N. 89° 59' E. on a true line through the middle of sec. 30,  
Over rolling land,  
Through scattered brush and trees.

20.00 Set an iron post for 1/16 sec. cor. No. 8 bet. the NW. and  
SW. 1/4 of sec. 30, with brass cap stamped

No 8 in N.  
1/16 S 30 in center  
1911 in S.

Dig pits 18x18x12 ins. E. and W. of post 3 ft. dist.; and  
raise mound of earth 3 1/2 ft. base, 1 1/2 ft. high, N. of cor.  
No B.T.'s available.

36.00 Road brs. N. 20° W. and S. 20° E.

40.00 Set an iron post for E. 1/4 sec. cor. of sec. 30, with brass  
cap stamped

C 1/4 S 30 in center  
1911 in S.

From which -

Mesquite, 10 ins. in diam., brs. N. 13° 30' E., 106  
lks. dist., mkd. C 1/4 S 30 B T  
Mesquite, 12 ins. diam., brs. S. 24° 30' E., 85 lks.  
dist., mkd. C 1/4 S 30 B T

No other B.T.'s available.

Raise mound of stone 2 ft. base, 1 1/2 ft. high, N. of cor.

47.20 begin descent, brs. N. and S.

47.50 Irrigation ditch, 8 lks. wide, course S.

48.00 Foot of descent; thence over level bottom land, brs. N.  
and S.

56.00 Leave brush; enter cottonwood timber, brs. N. and S.

58.00 Middle of slough, 2 chs. wide, brs. N. and S.

60.00 Set an iron post for 1/16 sec. cor. No. 7 bet. the NE. and  
SE. 1/4 of sec. 30, with brass cap stamped

No 7 in N.  
1/16 S 30 in center  
1911 in S.

From which -

Cottonwood, 24 ins. in diam., brs. N. 4° E., 63 lks.  
dist., mkd. 1/16 S 30 B T  
Cottonwood, 20 ins. in diam., brs. S. 44° 15' E., 80  
lks. dist., mkd. 1/16 S 30 B T

61.82 Rightbank of Verde River, course SE.

**Chains**

Set an iron post for M. C. of sec. 30, with brass cap stamped

M C in E.  
1911 in S.  
1/16 S 30 in N.

From which -

Cottonwood, 18 ins. in diam., brs. S. 13° 15' E., 52 lks. dist., mkd. 1/16 S 30 M C B T  
Cottonwood, 36 ins. in diam., brs. N. 79° 45' W., 44 lks. dist., mkd. 1/16 S 30 M C B T

Descend 8 ft. bank to bed of Verde River.

Thence over sand bar.

76.00 Middle of mainchannel of Verde River, 3 ft. deep, 6 chs. wide, course SE.

80.00 Temp. 1/4 sec. cor. bet. secs. 29 and 30, on sand bar.

Land, rolling and level.  
Soil, 2nd and 3rd rate.  
Brush, greasewood and mesquite.  
Scattered palo verde trees.  
Cottonwood timber, 5.82 chs.

From the 1/16 sec. cor. No. 7 bet. the NE. and SE. 1/4s of sec. 30, I run

South on a true line through the middle of the SE. 1/4 of sec. 30,

Over level bottom land,

Through cottonwood timber.

3.00 Middle of slough, 2 chs. wide, brs. N. 40° W. and S. 40° E.

7.00 Right bank of Verde River.

Set an iron post for M. C. of sec. 30, with brass cap stamped

M C 1911 in S.  
1/16 S 30 in N.

From which -

Cottonwood, 12 ins. in diam., brs. S. 35° W., 90 lks. dist., mkd. 1/16 S 30 M C B T  
Cottonwood, 8 ins. in diam., brs. N. 27° 15' W., 41 lks. dist., mkd. 1/16 S 30 M C B T

Land, level and sandy.  
Soil, 2nd rate.  
Timber, cottonwood.

From 1/16 sec. cor. No. 1 bet. secs. 30 and 31, N 1/2, I run

## Subdivision T. 3 N., R. 7 E.

Chains	
	North on a true line through middle of SE. $\frac{1}{4}$ of sec. 30, Over level land Through field.
12.80	Fence brs. N. 80° W. and S. 80° E. Leave field. Enter dense mesquite brush and scattered timber.
16.00	Right bank of Verde River, course SE. Set an iron post for M. C. of sec. 30, with brass cap stamped  1/16 S 30 M C in N. 1911 in S.  From which -  Mesquite, 10 ins, in diam., brs. S. 8° E., 72 lks. dist., mkd. 1/16 S 30 M C B T Mesquite, 10 ins. in diam., brs. N. 78° 45' W., 14 lks. dist., mkd. 1/16 S 30 M C B T  Land, level. Soil, 2nd rate. Field, 12.80 chs. Brush, 3.20 chs. Mesquite, with scattered cottonwood timber.
<hr/>	
	From the temp. 1/16 sec. cor. No. 6 bet. secs. 29 and 30, N $\frac{1}{2}$ , on sand bar, I run West on a random line through N. $\frac{1}{4}$ of sec. 30.
20.00	Set temp. 1/16 sec. cor. No. 5.
40.00	Set temp. 1/16 sec. cor. No. 4.
60.00	Set temp. 1/16 sec. cor. No. 3.
80.00	Fall 4 lks. N. of 1/16 sec. cor. No. 6 bet. secs. 25 and 30, N $\frac{1}{2}$ , on the W. bdy. of the tp., previously described. Thence I run N. 89° 58' E. on a true line through N. $\frac{1}{4}$ of sec. 30, Over rolling land, Through scattered brush.
12.20	Road brs. NE. and SW.
20.00	Set an iron post for 1/16 sec. cor. No. 3 in the center of the NW. $\frac{1}{4}$ of sec. 30, with brass cap stamped  No 3 in N. 1/16 S 30 in center 1911 in S.

Chains	
	Raise mound of stone 2 ft. base, $1\frac{1}{2}$ ft. high, N. of cor. No B.T.'s available.
29.10	Road brs. NW. and SE.
29.30	Fence brs. NW. and SE.
33.00	Irrigation ditch, 8 lks. wide, course SE.  Leave rolling land; enter level land and cottonwood timber, brs. NW. and SE.
39.40	Fence brs. N. $80^{\circ}$ E. and S. $80^{\circ}$ W.
40.00	Set an iron post for $1/16$ sec. cor. No. 4 bet. the NE. and NW. $\frac{1}{4}$ s of sec. 30, with brass cap stamped  No 4 in N. $1/16$ S 30 in center 1911 in S.  From which -  Cottonwood, 8 ins. in diam., brs. N. $72^{\circ} 30'$ E., 38 lks. dist., mkd. $1/16$ S 30 B T Cottonwood, 10 ins. in diam., brs. N. $41^{\circ}$ W., 10 lks. dist., mkd. $1/16$ S 30 B T
43.35	Fence brs. N. and S.
56.00	Middle of slough, 2 chs. wide, brs. N. and S.
60.00	Set an iron post for $1/16$ sec. cor. No. 5 in the center of the NE. $\frac{1}{4}$ of sec. 30, with brass cap stamped  No 5 in N. $1/16$ S 30 in center 1911 in S.  From which -  Mesquite, 12 ins. in diam., brs. S. $73^{\circ}$ W., 8 lks. dist., mkd. $1/16$ S 30 B T Mesquite, 10 ins. in diam., brs. N. $2^{\circ}$ W., 56 lks. dist., mkd. $1/16$ S 30 B T
62.40	Right bank of Verde River, course SW.  Set an iron post for M. C. of sec. 30, with brass cap stamped  M C in E. 1911 in S. $1/16$ S 30 in W.  From which -  Cottonwood, 12 ins. in diam., brs. N. $24^{\circ}30'$ E., 88 lks. dist., mkd. $1/16$ S 30 M C B T Cottonwood, 10 ins. in diam., brs. S. $45^{\circ}$ W., 38 lks. dist., mkd. $1/16$ S 30 M C B T  Descend 7 ft. bank to bed of Verde River. Thence over sand bar.

## Subdivision T. 3 N., R. 7 E.

## Chains

72.00 Middle of main channel of Verde River, 4 chs. wide,  $2\frac{1}{2}$  ft. deep, course SE.

80.00 Temp.  $1/16$  sec. cor. No. 6 bet. secs. 29 and 30,  $N\frac{1}{2}$ , on sand bar.

Land, rolling and level.  
Soil, 2nd and 4th rate.  
Brush, greasewood and mesquite.  
Scattered pale verde trees. Cottonwood timber.

From the  $1/16$  sec. cor. No. 5 in the center of the NE.  $\frac{1}{4}$  of sec. 30, I run

North on a true line through the middle of the NE.  $\frac{1}{4}$  of sec. 30.

Over level land, through cottonwood timber.

18.40 Right bank of Verde River, course SE.

Set an iron post for M. C. of sec. 30 $\frac{1}{4}$  with brass cap **xx** stamped

M C in N.  
 $1/16$  in NW.  
S 30 1911 in S.

From which -

Cottonwood, 8 ft. diam., brs. S.  $38^{\circ} 30'$  E., 276 lks.  
dist., mkd.  $1/16$  S 30 M C B T  
Cottonwood, 4 ft. diam., brs. S.  $76^{\circ}$  W., 56 lks.  
dist., mkd.  $1/16$  S 30 M C B T

Land, level and sandy.  
Soil, 2nd rate.  
Timber, cottonwood.

- February 18, 1911.

February 20, 1911, at 8h., a.m., l.m.t., I set off  $33^{\circ} 35'$  N. on the latitude arc,  $11^{\circ} 8'$  S. on the declination arc, and determine a meridian with the solar at the temp. cor. of secs. 19, 20, 29 and 30, on sand bar in Verde River.

Thence I run

N.  $0^{\circ} 1'$  E. bet. secs. 19 and 20,

Over sand bar in bed of Verde River.

6.90 Left bank of Verde River, course SE.

Set an iron post for M. C. of secs. 19 and 20, with brass cap stamped

M C 1911 in S.

Subdivision T. 3 N., R. 7 E.

Chains

T 3 N S 20 in NE. quadrant  
R 7 E S 19 " NW. "  
5 notches on the E. edge.

From which -

Cottonwood, 18 ins. in diam., brs. S. 27° 45' E., 104  
lks. dist., mkd. T 3 N E 7 E S 20 M C B T  
Cottonwood, 8 ins. in diam., brs. S. 88° 30' E., 31  
lks. dist., mkd. T 3 N E 7 E S 20 M C B T

Thence over level land, through mesquite brush,

20.00 Set an iron post for 1/16 sec. cor. No. 12 bet. secs. 19  
and 20, 8 1/2, with brass cap stamped

No 12 in N.  
1/16 S 19 in W.  
S 20 " E.  
1911 " S.

From which -

Mesquite, 8 ins. in diam., brs. N. 68° 30' W., 165  
lks. dist., mkd. 1/16 S 19 B T

No other B. T. available.

Dig pits 18x18x12 ins. N. and S. of post 3 ft. dist.; and  
raise mound of earth 3 1/2 ft. base, 1 1/2 ft. high, W. of cor.

40.00 Set an iron post for 1/4 sec. cor. bet. secs. 19 and 20,  
with brass cap stamped

1/4 S 19 in W.  
S 20 " E.  
1911 " S.

From which -

Cottonwood, 24 ins. in diam., brs. N. 20° 15' W., 93  
lks. dist., mkd. 1/4 S 19 B T  
Mesquite, 24 ins. in diam., brs. S. 71° 45' W., 150  
lks. dist., mkd. 1/4 S 19 B T

After diligent search, find no trace of old cor.

46.70 Left bank of Verde River, course SW.

Set an iron post for M. C. of secs. 19 and 20, with brass  
cap stamped

M C in N.  
1911 in S.  
T 3 N S 19 in SW. quadrant  
R 7 E S 20 " SE. "  
5 notches on the E. edge.

Dig a pit 36x36x12 ins. 8 ft. S. of post and raise mound  
of earth 4 ft. base, 2 ft. high, S. of cor.

To pass bend in river, I offset as follows:

East 3.10 chs.

N. 0° 1' E. 13.30 " to a point on bank of river,

3.10 chs. East of point on sand



Subdivision T. 3 N., R. 7 E.

Chains

60.00 bar in river bed, at  
get temp. stake for temp. 1/16 sec. cor. No. 6 bet. secs.  
19 and 20, N 1/4, on sand bar., 3.10 chs. West.

Continue offset line,

N. 0° 1' E. 8.17 chs.

West 3.10 " to a point on line bet. secs. 19  
and 20, on left bank of Verde  
River, course SE., at

68.17 Set an iron post for M. C. of secs. 19 and 20, with brass  
cap stamped

M C 1911 in S.  
T 3 N S 20 in NE. quadrant  
R 7 E S 19 " NW. "  
5 notches on the E. edge.

From which \*

Mesquite, 12 ins. in diam., brs. N. 3° 45' E., 199  
lks. dist., mkd. T 3 N R 7 E S 20 M C B T  
Cottonwood, 10 ins. in diam., brs. S. 68° E., 344  
lks. dist., mkd. T. 3 N R 7 E S 20 M C B T

Thence N.0° 1' E. bet. secs. 19 and 20.

80.00 Set an iron post for cor. of secs. 17, 18, 19 and 20, with  
brass cap stamped

T 3 N S 17 in NE. quadrant  
R 7 E S 20 " SE. "  
S 19 " SW. "  
S 18 " NW. "  
1911 " S.

3 notches on the S. and 5 on the E. edge.

from which -

Mesquite, 20 ins. in diam., brs. N. 51° 30' E., 46  
lks. dist., mkd. T 3 N R 7 E S 17 B T  
Mesquite, 20 ins. in diam., brs. S. 75° 45' W., 150  
lks. dist., mkd. T 3 N R 7 E S 19 B T  
Cottonwood, 18 ins. in diam., brs. N. 42° 30' W., 118  
lks. dist., mkd. T 3 N R 7 E S 18 B T

Raise mound of stone 2 ft. base, 1 1/2 ft. high, W. of cor.

Land, level; has been cultivated at some former time.  
Soil, 2nd rate.  
Brush, mesquite, with scattered cottonwood trees.

From this cor., the old cor., a mesquite post 8 ins. in  
diam., brs. S. 63° 30' W., 4.50 chs. dist. I destroy  
all trace of this old cor.

---

S. 89° 58' W. on a random line bet. secs. 18 and 19.  
20.00 Set temp. 1/16 sec. cor. No. 1.  
40.00 Set temp. 1/4 sec. cor.  
60.00 Set temp. 1/16 sec. cor. No. 2.

## Subdivision T. 3 N., R. 7 E.

## Chains

20.04 Intersect cor. of secs. 13, 18, 19 and 24, on the W. bdy. of the tp., previously described.

Thence I run

N. 89° 58' E. on a true line bet. secs. 18 and 19,

Over rolling land,

Through greasewood brush.

16.00 Leave rolling land, hrs. N. and S.

Enter level land, covered with mesquite brush.

18.30 McDowell road hrs. N. and S.

20.01 Set an iron post for 1/16 sec. cor. No. 2 bet. secs. 18 and 19, W $\frac{1}{2}$ , with brass cap stamped

No 2 1/16 S 18 in N.  
S 19 1911 in S.

From which -

Mesquite, 8 ins. in diam., hrs. S. 57° E., 135 lks.  
dist., mkd. 1/16 S 19 B T

Mesquite, 10 ins. in diam., hrs. N. 12° 30' E., 282 lks.  
dist., mkd. 1/16 S 18 B T

21.00 Drain, course S.

40.02 Set an iron post for  $\frac{1}{4}$  sec. cor. bet. secs. 18 and 19, with brass cap stamped

$\frac{1}{4}$  S 18 in N.  
S 19 1911 in S.

From which -

Mesquite, 10 ins. in diam., hrs. S. 51° 15' E., 160 lks.  
dist., mkd.  $\frac{1}{4}$  S 19 B T

Mesquite, 14 ins. in diam., hrs. N. 60° W., 146 lks.  
dist., mkd.  $\frac{1}{4}$  S 18 B T

40.63 Right bank of Verde River, course SE.

Set an iron post for M. C. of secs. 18 and 19, with brass cap stamped

M C in E.  
1911 in S.  
T 3 N S 19 in SW. quadrant  
R 7 E S 18 " NW. "  
5 notches on the S.

From which -

Ash, 18 ins. in diam., hrs. S. 21° 45' E., 115 lks.  
dist., mkd. T 3 N R 7 E S 19 M C B T

Mesquite, 12 ins. in diam., hrs. N. 37° W., 138 lks.  
dist., mkd. T 3 N R 7 E S 18 M C B T

Descend 8 ft. bank to bed of Verde River.

60.03 Point for 1/16 sec. cor. No. 1 bet. secs. 18 and 19, E $\frac{1}{2}$ ,

Subdivision T. 3 N., R. 7 E.

Chains

falls in bed of river.

63.50 Middle of main channel of verde River, course SE. Water  
2½ ft. deep, 4 chs. wide.

68.24 Left bank of Verde River, course SE.  
set an iron post for M. C. of secs. 18 and 19, with brass  
cap stamped

M C in W.  
1911 in S.  
T 3 N 8 18 in NE. quadrant  
R 7 E 8 19 " SE. "  
3 notches on the S.

From which -

Mesquite, 8 ins. in diam., brs. N. 14° 45' E., 165  
lks. dist., mkd. T 3 N R 7 E S 18 M C B T  
Mesquite, 12 ins. in diam., brs. S. 75° 15' E., 180  
lks. dist., mkd. T 3 N R 7 E S 19 M C B T

Thence over level land, through mesquite brush.

80.04 The cor. of secs. 17, 18, 19 and 20.

Land, level and rolling.  
Soil, 2nd and 3rd rate.  
Brush, greasewood and mesquite. Rolling land, 16.00 chs.  
Level " 64.04 "

From the 1/16 sec. cor. No. 12 bet. secs. 19 and 20, S½,

I run

S. 89° 58' W. on a random line through the S. ¼ of sec. 19.

20.00 set temp. 1/16 sec. cor. No. 11.

40.00 Set temp. 1/16 sec. cor. No. 10.

60.00 Set temp. 1/16 sec. cor. No. 9.

80.00 Intersect 1/16 sec. cor. No. 12 bet. secs. 19 and 24, S½,

on the W. bdy. of the tp., previously described.

Thence I run

N. 89° 58' E. on a true line through S. ¼ of sec. 19.

Over level land,

Through scattered mesquite brush.

1.65 Drain, course NE.

4.35 McDowell Road, brs. N. 10° E. and S. 10° W.

20.00 Set an iron post for 1/16 sec. cor. No. 9 in the center  
of the SW. ¼ of sec. 19, with brass cap stamped

No 9 in N.  
1/16 S 19 in center  
1911 in S.

Subdivision T. 3 N., R. 7 E.

1886

Chains

From which -

Palo verde, 6 ins. in diam., brs. S. 68° E., 225 lks. dist., mkd. 1/16 S 19 B T  
Palo verde, 6 ins. in diam., brs. S. 32° 15' W., 187 lks. dist., mkd. 1/16 S 19 B T

21.75 Fence brs. N. and S.

27.15 Adobe house brs. S., 1 chain dist.

28.85 Irrigation ditch, 3 lks. wide, course S. 10° W.

Leave level land; enter bottom land, brs. N. and S.

34.10 Fence brs. N. and S.

39.25 Fence brs. N. and S.

40.00 Set an iron post for 1/16 sec. cor. No. 10 bet. the SE. and SW. 1/4 of sec. 19, with brass cap stamped

N o 10 in N.  
1/16 S 19 in center  
1911 in S.

From which -

Cottonwood, 5 ins. in diam., brs. S. 60° 30' E., 340 lks. dist., mkd. 1/16 S 19 B T  
Cottonwood, 5 ins. in diam., brs. S. 77° E., 235 lks. dist., mkd. 1/16 S 19 B T

48.00 Leave brush; enter cottonwood timber, brs. N. 10° E. and S. 10° W.

50.30 Right bank of Verde River, course SE.

Set an iron post for M. C. of sec. 19, with brass cap stamped

M C in E.  
1911 in S.  
1/16 S 19 in W.

From which -

Cottonwood, 10 ins. in diam., brs. S. 47° 30' W., 37 lks. dist., mkd. 1/16 S 19 M C B T  
Cottonwood, 10 ins. in diam., brs. N. 58° 30' W., 60 lks. dist., mkd. 1/16 S 19 M C B T

Descend 3 ft. bank to bed of Verde River.

59.00 Middle of main channel, course SE., 6 chs. wide, course SE.

60.00 Point for 1/16 sec. cor. No. 11, in center of SE. 1/4 of sec. 19, falls in river channel.

76.69 Left bank of Verde River.

Set an iron post for M. C. of sec. 19, with brass cap stamped

1/16 M C in W.  
1911 in S.  
S 19 in E.

Subdivision T. 3 N., R. 7 E.

Chains

from which -

Cottonwood, 2 ft. in diam., hrs. S. 45° W., 67 lks.  
dist., mkd. 1/16 S 19 M C B T  
Mesquite, 2 ft. diam., hrs. S. 18° 45' E., 97 lks.  
dist., mkd. 1/16 S 19 M C B T

Thence over level land, through mesquite brush.

80.00 The 1/16 sec. cor. No. 12 bet. secs. 19 and 20, S 1/2.

Land, level.  
Soil, 2nd rate.  
Brush, mesquite and cottonwood timber along river.

Feb. 20, 1911, at the 1/4 sec. cor. bet. secs. 19 and 20, I  
set off 11° 5' S. on the declination arc, and at 12h.  
13m. 59s., p.m., l.m.t., observe the sun on the meridian;  
the resulting latitude is 33° 36' N., which is within 1'  
of the correct latitude.

Thence I run

S. 89° 58' W. on a random line through middle of sec. 19.

20.00 Set temp. 1/16 sec. cor. No. 7.

40.00 Set temp. C. 1/4 sec. cor.

60.00 Set temp. 1/16 sec. cor. No. 8.

80.00 Fall 4 lks. S. of 1/4 sec. cor. bet. secs. 19 and 24, on  
the W. bdy. of the tp., previously described.

Thence I run

East on a true line through the middle of sec. 19,

Over level land, through brush.

12.00 McDowell road, hrs. N. 25° E. and S. 25° W.

20.00 get an iron post for 1/16 sec. cor. No. 8 bet. the NW.  
and SW. 1/4 of sec. 19, with brass cap stamped

No 8 in N.  
1/16 S 19 in center  
1911 in S.

From which -

Mesquite, 18 ins. in diam., hrs. N. 60° 15' E., 158  
lks. dist., mkd. 1/16 S 19 B T  
Mesquite, 8 ins. in diam., hrs. S. 6° 45' E., 132 lks.  
dist., mkd. 1/16 S 19 B T

20.50 Drain, course SE.

28.70 fence hrs. N. and S.

Enter small field.

34.10 Irrigation ditch, 10 lks. wide, course S.

40.00 Set an iron post for C. 1/4 sec. cor. of sec. 19, with  
brass cap stamped

## Subdivision T. 3 N., R. 7 E.

## Chains

C  $\frac{1}{4}$  S 19 in center  
1911 in S.

From which -

Mesquite, 14 ins. in diam., brs. N. 21°45' E., 174  
lks. dist., mkd. C  $\frac{1}{4}$  S 19 B T  
Mesquite, 12 ins. in diam., brs. S 87° E., 84 lks.  
dist., mkd. C  $\frac{1}{4}$  S 19 B T  
Cottonwood, 36 ins. in diam., brs. S. 8°30' W., 95  
lks. dist., mkd. C  $\frac{1}{4}$  S 19 B T  
Cottonwood, 30 ins. in diam., brs. N. 27° 30' W., 374  
lks. dist., mkd. C  $\frac{1}{4}$  S 19 B T

45.50 Fence brs. N. and S.

Leave field; enter brush, brs. N. and S.

47.15 Right bank of Verde River, course SE.

Set an iron post for M. C. of sec. 19, with brass cap  
stamped

M C in E.  
1911 in S.  
1/16 S 19 in W.

From which -

Mesquite, 12 ins. in diam., brs. S. 13°30' E., 83  
lks. dist., mkd. 1/16 S 19 M C B T  
Mesquite, 10 ins. in diam., brs. N. 27° 30' W., 14  
lks. dist., mkd. 1/16 S 19 M C B T

Descend 4 ft. bank to bed of Verde River, course SE.

60.00 Point for 1/16 sec. cor. No. 7 bet. the NE. and SE.  $\frac{1}{4}$ s of  
sec. 19, falls in bed of Verde River.

72.00 Middle of main channel of Verde River, 4 chs. wide, 3 ft.  
deep, course S. 10° W.

77.90 Left bank of Verde River.

Set an iron post for M. C. of sec. 19, with brass cap  
stamped

1/16 M C in W.  
1911 in S.  
S 19 in E.

From which -

Mesquite, 36 ins. in diam., brs. S. 40° E., 53 lks.  
dist., mkd. 1/16 S 19 M C B T  
Mesquite, 28 ins. in diam., brs. S. 9° W., 90 lks.  
dist., mkd. 1/16 S 19 M C B T

Thence over level land, through mesquite brush.

80.00 The  $\frac{1}{4}$  sec. cor. bet. secs. 19 and 20.

Land, level.

Soil, 2nd rate.

Brush, greasewood, mesquite. Scattered trees along river.

Subdivision T. 3 N., R. 7 E.

Chains

From temp. 1/16 sec. cor. No. 6 bet. secs. 19 and 20, N $\frac{1}{2}$ ,  
on sand bar, I run

S. 89° 58' W. on a random line through the N.  $\frac{1}{4}$  of sec. 19.

20.00 Set temp. 1/16 sec. cor. No. 5.

40.00 Set temp. 1/16 sec. cor. No. 4.

60.00 Set temp. 1/16 sec. cor. No. 3.

80.00 Intersect 1/16 sec. cor. No. 6 bet. secs. 19 and 24, N $\frac{1}{2}$ ,  
on the W. bdy. of the tp., previously described.

Thence I run

N. 89° 58' E. on a true line through the N.  $\frac{1}{4}$  of sec. 19,  
Over rolling land, through brush.

14.00 Leave rolling land; enter level land, hrs. N. and S.  
Drain, course SE.

16.00 McDowell road, hrs. N. and S.

20.00 Set an iron post for 1/16 sec. cor. No. 3 in the center of  
the NW.  $\frac{1}{4}$  of sec. 19, with brass cap stamped

No 3 in N.  
1/16 S 19 in center  
1911 in S.

From which -

Mesquite, 6 ins. in diam., hrs. N. 88° 30' E., 69 lks.  
dist., mkd. 1/16 S 19 B T  
Mesquite, 8 ins. in diam., hrs. S. 12° W., 32 lks.  
dist., mkd. 1/16 S 19 B T

23.60 Drain, course SE.

38.50 Irrigation ditch, 8 lks. wide, course S. 10° W.

40.00 set an iron post for 1/16 sec. cor. No. 4 bet. the NE.  
and NW.  $\frac{1}{4}$ s of sec. 19, with brass cap stamped

No 4 in N.  
1/16 S 19 in center  
1911 in S.

From which -

Cottonwood, 36 ins. in diam., hrs. S. 38° W., 103  
lks. dist., mkd. 1/16 S 19 B T  
Mesquite, 16 ins. in diam., hrs. E. 30° E., 70 lks.  
dist., mkd. 1/16 S 19 B T

45.55 Right bank of Verde River, course SW.

Set an iron post for M. C. of sec. 19, with brass cap  
stamped

M C in E.  
1911 in S.  
1/16 S 19 in W.

## Subdivision T. 3 N., R. 7 E.

## Chains

From which -

Willow, 12 ins. in diam., brs. N. 1° E., 76 lks.  
dist., mkd. 1/16 S 19 M C B TWillow, 10 ins. in diam., brs. S. 47° 30' E., 84 lks.  
dist., mkd. 1/16 S 19 M C B T60.00 Point for 1/16 sec. cor. No. 5 in the center of the NE.  $\frac{1}{4}$   
of sec. 19 falls in Verde River.78.00 Middle of main channel of Verde River, course SW., 4 chs.  
wide, 2 $\frac{1}{2}$  ft. deep.80.00 Temp. cor. for 1/16 sec. cor. No. 6 bet. secs. 19 and 20,  
N.  $\frac{1}{4}$ , on sand bar.

Land, rolling and level.

Soil, 2nd and 3rd rate.

Brush, greasewood and mesquite. Scattered palo verde and  
cottonwood trees.

- February 20, 1911.

February 21, 1911, at 8h., a.m., l.m.t., I set off 33° 36'  
N. on the latitude arc, 10° 46' S. on the declination  
arc, and determine a meridian with the solar at the cor.  
of secs. 17, 18, 19 and 20.

Thence I run

N. 0° 1' E. bet. secs. 17 and 18,

Over level land, through dense mesquite brush.

0.50 Deserted adobe house, brs. W., 15 lks. dist.

20.00 Set an iron post for 1/16 sec. cor. No. 12 bet. secs. 17  
and 18, S $\frac{1}{2}$ , with brass cap stamped

No 12 in N.  
1/16 S 18 in W.  
S 17 " E.  
1911 " S.

From which -

Cottonwood, 24 ins. in diam., brs. S. 56° 45' E., 266  
lks. dist., mkd. 1/16 S 17 B TCottonwood, 18 ins. in diam., brs. S. 3° W., 213 lks.  
dist., mkd. 1/16 S 18 B T

23.00 Old irrigation ditch, 10 lks. wide, course SE.

40.00 Set an iron post for  $\frac{1}{4}$  sec. cor. bet. secs. 17 and 18,  
with brass cap stamped

$\frac{1}{4}$  S 18 in W.  
S 17 " E.  
1911 " S.

From which -

Cottonwood, 10 ins. in diam., brs. N. 50° 15' E.,  
142 lks. dist., mkd.  $\frac{1}{4}$  S 17 B TMesquite, 30 ins. in diam., brs. N. 66° 15' W., 322  
lks. dist., mkd.  $\frac{1}{4}$  S 18 B T



Subdivision T. 3 N., R. 7 E.

Chains

After diligent search, find no trace of old cor.

43.91 Drain, 8 lks. wide, course W.

60.00 Set an iron post for 1/16 sec. cor. No. 6 bet. secs. 17 and 18, N $\frac{1}{2}$ , with brass cap stamped

No 6 in N.  
1/16 S 18 in W.  
S 17 " E.  
1911 " S.

From which -

Mesquite, 24 ins. in diam., hrs. N. 79° 15' E., 178 lks. dist., mkd. 1/16 S 17 B T  
Mesquite, 18 ins. in diam., hrs. S. 74° W., 48 lks. dist., mkd. 1/16 S 18 B T

80.00 Set an iron post for cor. of secs. 7, 8, 17 and 18, with brass cap stamped

T 3 N S 8 in NE. quadrant  
R 7 E S 17 " SE. "  
S 18 " SW. "  
S 7 " NW. "  
1911 " S.

4 notches on the S. and 5 on the E. edge.

Dig pits 18x18x12 ins. in each sec. 5 $\frac{1}{2}$  ft. dist.; and raise mound of stone 4 ft. base, 2 ft. high, W. of cor.

No B.T.'s available.

After diligent search, find no trace of old cor.

Land, level.  
Soil, 2nd rate.  
Brush, dense mesquite.

S. 89° 58' W. on a random line bet. secs. 7 and 18.

20.00 Set temp. 1/16 sec. cor. No. 1.

40.00 Set temp.  $\frac{1}{4}$  sec. cor. bet. secs. 7 and 18.

60.00 Set temp. 1/16 sec. cor. No. 2.

80.00 Fall 4 lks. N. of cor. of secs. 7, 12, 13 and 18, on the W. bdy. of the tp., previously described.

Thence I run

N. 89° 56' E. on a true line bet. secs. 7 and 18,

Over level land, through brush.

5.40 McDowell road, hrs. N. and S.

17.35 Right bank of Verde River, course S.

Set an iron post for M. C. of secs. 7 and 18, with brass cap stamped

Subdivision T. 3 N., R. 7 E.

Chains

M C in E.  
1911 in S.  
T 3 N S 18 in SW. quadrant  
R 7 E S 7 " NW. "  
4 notches on the S.

From which -

Mesquite, 15 ins. in diam., brs. S. 22° 30' W., 42  
lks. dist., mkd. T 3 N R 7 E S 18 M C B T  
Mesquite, 14 ins. in diam., brs. N. 52° 30' W., 20  
lks. dist., mkd. T 3 N R 7 E S 7 M C B T

Descend 4 ft. bank to bed of Verde River, course S.

20.00 Point for 1/16 sec. cor. No. 2 bet secs. 7 and 18, W 1/2,  
falls in river.

25.00 Middle of main channel of Verde River, course S. 5 chs.  
wide, 3 ft. deep.

40.00 Point for 1/4 sec. cor. bet. secs. 7 and 18 falls in river.

51.61 Left bank of Verde River, course S.

Set an iron post for M. C. of secs. 7 and 18, with brass  
cap stamped

M C in W.  
1911 in S.  
T 3 N S 7 in NE. quadrant  
R 7 E S 18 " SE. "  
4 notches on the S.

From which -

Mesquite, 20 ins. in diam., brs. N. 32° 30' E., 45  
lks. dist., mkd. T 3 N R 7 E S 7 M C B T  
Mesquite, 10 ins. in diam., brs. S. 68° 30' E., 32  
lks. dist., mkd. T 3 N R 7 E S 18 M C B T

Thence over level land, through dense mesquite brush.

53.00 Irrigation ditch, 8 lks. wide, course SE.

60.00 Set an iron post for 1/16 sec. cor. No. 1 bet. secs. 7 and  
18, E 1/2, with brass cap stamped

No 1 1/16 S 7 in N.  
S 18 1911 " S.

From which -

Mesquite, 8 ins. in diam., brs. N. 46° 40' E., 87  
lks. dist., mkd. 1/16 S 7 B T  
Mesquite, 6 ins. in diam., brs. S. 30° 30' W., 79  
lks. dist., mkd. 1/16 S 18 B T

80.00 The cor. of secs. 7, 8, 17 and 18.

Land, level.  
Soil, 2nd rate.  
Brush, dense mesquite.

From the 1/16 sec. cor. No. 12 bet. secs. 17 and 18, S 1/2,

**Chains**

I run

S. 89° 58' W. on a random line through S.  $\frac{1}{2}$  of sec. 18.

20.00 Set temp. 1/16 sec. cor. No. 11.

40.00 Set temp. 1/16 sec. cor. No. 10.

60.00 Set temp. 1/16 sec. cor. No. 9.

80.04 Fall 2 lks. N. of 1/16 sec. cor. No. 12 bet. secs. 13 and 18, S  $\frac{1}{2}$ , on the W. bdy. of the tp., previously described.

Thence I run

N. 89° 57' E. on a true line through the S.  $\frac{1}{2}$  of sec. 18, Over rolling land, through brush.

5.90 Drain, course SE.

16.60 McDowell road, hrs. N. and S.

Leave rolling land; enter level land, hrs. N. and S.

19.00 Drain, course NE.

20.01 Set an iron post for 1/16 sec. cor. No. 9 in the center of the SW.  $\frac{1}{4}$  of sec. 18, with brass cap stamped

No 9 in N.  
1/16 S 18 in center  
1911 in S.

From which -

Mesquite, 6 ins. in diam., hrs. N. 76° E., 125 lks. dist., mkd. 1/16 S 18 B T  
Mesquite, 6 ins. in diam., hrs. S. 63° W., 35 lks. dist., mkd. 1/16 S 18 B T

29.10 Right bank of Verde River, course SE.

Set an iron post for M. C. of sec. 18 with brass cap stamped

M C in E.  
1911 in S.  
1/16 S 18 in W.

From which -

Mesquite, 8 ins. in diam., hrs. S. 55° 45' W., 86 lks. dist., mkd. 1/16 S 18 M C B T  
Mesquite, 8 ins. in diam., hrs. N. 89° W., 88 lks. dist., mkd. 1/16 S 18 M C B T

Descend 20 ft. bank to bed of verde River, course SE.

34.00 Middle of main channel of Verde River, 4 chs. wide, 4 ft. deep, course SE.

40.02 Point for 1/16 sec. cor. No. 10 bet. the SE. and SW.  $\frac{1}{4}$ s of sec. 18 falls in river.

49.92 Left bank of Verde River, course SE.

Subdivision T. 3 N., R. 7b E.

Chains

Set an iron post for M. C. of sec. 18, with brass cap stamped

1/16 M C in W.  
1911 in S.  
S 18 in E.

From which -

Cottonwood, 36 ins. in diam., brs. N. 5° 30' E., 386  
lks. dist., mkd. 1/16 S 18 M C B T  
Cottonwood, 18 ins. in diam., brs. S. 46° 25' E., 356  
lks. dist., mkd. 1/16 S 18 M C B T

Thence over level land through mesquite brush.

60.03 Set an iron post for 1/16 sec. cor. No. 11 in the center of the SE. 1/4 of sec. 18, with brass cap stamped

No 11 in N.  
1/16 S 18 in center  
1911 in S.

From which -

Mesquite, 14 ins. in diam., brs. N. 57° 45' E., 173  
lks. dist., mkd. 1/16 S 18 B T  
Mesquite, 18 ins. in diam., brs. S. 12° 15' W., 91  
lks. dist., mkd. 1/16 S 18 B T

80.04 The 1/16 sec. cor. No. 12 bet. secs. 17 and 18, S 1/4.

Land, rolling and level, 16.60 and 63.44 chs., respectively.  
Soil, 2nd and 3rd rate.  
Brush, greasewood, mesquite, and scattered palo verde.

From the 1/16 sec. cor. No. 11 in the center of the SE. 1/4 of sec. 18, I run

South on a true line through the middle of the SE. 1/4 of sec. 18,

Over level land, through mesquite brush.

14.20 Left bank of Verde River, course SE.

Set an iron post for M. C. of sec. 18, with brass cap stamped

M C 1911 in S.  
1/16 S 18 in N.

From which -

Cottonwood, 24 ins. in diam., brs. N. 67° E., 70 lks.  
dist., mkd. 1/16 S 18 M C B T  
Mesquite, 10 ins. in diam., brs. N. 1° 15' W., 145  
lks. dist., mkd. 1/16 S 18 M C B T

Bank 8 ft. high.

Land, level.  
Soil, 2nd rate.  
Brush, greasewood and mesquite. Scattered cottonwood.

Subdivision T. 3 N., R. 7 E.

Chains

From the 1/4 sec. cor. bet. secs. 18 and 19, I run North on a true line through middle of sec. 18, Over level land, through brush.

1.35 Right bank of Verde River, course SE.

Set an iron post for M. C. of sec. 18, with brass cap stamped

1/16 M C in N.  
S 18 1911 in S.

From which -

Mesquite, 8 ins. in diam., brs. N. 42° 30' W., 85 lks. dist., mkd. 1/16 S 18 M C B T  
Mesquite, 8 ins. in diam., brs. N. 68° 30' E., 70 lks. dist., mkd. 1/16 S 18 M C B T

Bank 10 ft. high.

3.35 Edge of water.

Land, level. Soil, 2nd rate.  
Mesquite brush.

From the 1/16 sec. cor. No. 9 in the center of the SW. 1/4 of sec. 18, I run

North on a true line through middle of SW. 1/4 of sec. 18, Over level land, through brush.

1.00 Drain, course NE.

15.25 Right bank of Verde River, course SE.

Set an iron post for M. C. of sec. 18, with brass cap stamped

1/16 M C in N.  
S 18 1911 in S.

From which -

Mesquite, 8 ins. in diam., brs. S. 55° 45' W., 86 lks. dist., mkd. 1/16 S 18 M C B T  
Mesquite, 8 ins. in diam., brs. N. 89° W., 88 lks. dist., mkd. 1/16 S 18 M C B T

Bank 20 ft. high.

15.45 Edge of water.

Land, level. Soil, 2nd rate.  
Brush, greasewood. Mesquite trees.

From the 1/4 sec. cor. bet. secs. 17 and 18, I run

S. 89° 58' W. on a random line through the middle of sec. 18,

Chains

- 20.00 Set temp. 1/16 sec. cor. No. 7.
- 40.00 Set temp. C. 1/4 sec. cor.
- 60.00 Set temp. 1/16 sec. cor. No. 8.
- 80.04 Fall 4 lks. N. of 1/4 sec. cor. bet. secs. 13 and 18, on the  
W. bdy. of the tp., previously described.  
Thence I run  
N. 89° 56' E. on a true line through middle of sec. 18,  
Over rolling land, through brush and scattered palo verde  
trees.
- 10.10 Drain, course NE.
- 12.00 Same drain, course SE.
- 13.00 Same drain, course NE.
- 17.00 McDowell road, brs. N. and S.
- 19.20 Right bank of verde River, course SE.  
set an iron post for M. C. of sec. 18, with brass cap  
stamped  
M C in E.  
1911 in S.  
1/16 S 18 in W.
- from which -  
Mesquite 8 ins. in diam., brs. N. 63° 15' W., 64 lks.  
dist., mtd. 1/16 S 18 M C B T  
Mesquite, 8 ins. in diam., brs. S. 70° 30' W., 90 lks.  
dist., mtd. 1/16 S 18 M C B T
- descend 18 ft. bank to bed of river.
- 20.01 Point for 1/16 sec. cor. No. 8 bet. the NW. and SW. 1/4 of  
sec. 18 falls in river.
- 24.00 Middle of main channel of verde River, 4 chs. wide, 3 ft.  
deep, course SE.
- 26.00 East edge of main channel; thence across sand bar.
- 40.02 Point for C. 1/4 sec. cor. of sec. 18 falls on sand bar,  
unsafe ground.
- 48.35 Left bank of Verde River, course SE.  
Set an iron post for M. C. of sec. 18, with brass cap  
stamped  
1/16 M C in W.  
1911 in S.  
S 18 in E.  
Dig a pit 36x36x12 ins. 8 ft. E. of post and raise mound  
of earth 4 ft. base, 2 ft. high, E. of cor.

Subdivision T. 3 N., R. 7 E.

Chains

No B.T.'s available.

Thence over level land, through dense mesquite brush and timber.

60.03 Set an iron post for 1/16 sec. cor. No. 7 bet. the NE. and SE. 1/4s of sec. 18, with brass cap stamped

No 7 in N.  
1/16 S 18 in center  
1911 in S.

From which -

Mesquite, 10 ins. in diam., brs. S. 55° 45' W., 201 lks. dist., mkd. 1/16 S 18 B T  
Mesquite, 8 ins. in diam., brs. N. 72° 15' W., 90 lks. dist., mkd. 1/16 S 18 B T

70.50 Old irrigation ditch, 10 lks. wide, course SE.

80.04 The 1/4 sec. cor. bet. secs. 17 and 18.

Land, rolling and level.  
Soil, 2nd and 3rd rate.  
Brush, greasewood and mesquite.  
Timber, mesquite, palo verde, and cottonwood.

-----  
From the 1/16 sec. cor. No. 6 bet. secs. 17 and 18, N 1/4, I run

S. 89° 58' W. on a random line through N. 1/4 of sec. 18.

20.00 Set temp. 1/16 sec. cor. No. 5.

40.00 Set temp. 1/16 sec. cor. No. 4.

60.00 Set temp. 1/16 sec. cor. No. 3.

80.00 Intersect the 1/16 sec. cor. No. 6 bet. secs. 13 and 18, N 1/4, on the W. bdy. of the tp., previously described.

Thence I run

N. 89° 58' E. on a true line through the N 1/4 of sec. 18, Over rolling land, through brush.

2.00 Drain, course SE.

10.00 Leave rolling land; enter level land, covered with mesquite brush and timber, brs. N. and S.

12.00 McDowell road, brs. N. and S.

18.50 Right bank of Verde River, course SE.

Set an iron post for M. C. of sec. 18, with brass cap stamped

M C in E.  
1/16 S 18 in W.  
1911 in S.

Subdivision T. 3 N., R. 7 E.

Chains

From which -

Mesquite, 6 ins. in diam., hrs. N. 20° 30' W., 63 lks. dist., mkd. 1/16 S 18 M C B T  
Mesquite, 8 ins. in diam., hrs. N. 20° 30' W., 140 lks. dist., mkd. 1/16 S 18 M C B T

Descend 20 ft. bank to bed of river.

20.00 Point for 1/16 sec. cor. No. 3 in the center of the NW. 1/4 of sec. 18, falls in river.

26.00 Middle of main channel of Verde River, 5 chs. wide, 3 ft. deep, course SE.

28.50 East edge of main channel; thence over sand bar.

40.00 Point for 1/16 sec. cor. No. 4 bet. the NE. and NW. 1/4 of sec. 18 falls in river.

55.00 Left bank of verde River, course SE.

Set an iron post for M. C. of sec. 18, with brass cap stamped

1/16 M C in W.  
1911 in S.  
S 18 in E.

Dig a pit 36x36x12 ins. 8 ft. E. of post and raise mound of earth 4 ft. base, 2 ft. high, E. of cor.

No B.T.'s available.

Thence over level land through dense growth of mesquite brush and trees.

59.00 Old irrigation ditch, 10 lks. wide, course SE.

60.00 Set an iron post for 1/16 sec. cor. No. 5 in the center of the NE. 1/4 of sec. 18, with brass cap stamped

No 5 in N.  
1/16 S 18 in center  
1911 in S.

Dig pits 18x18x12 ins. E. and W. of post 3 ft. dist.; and raise mound of earth 3 1/2 ft. base, 1 1/2 ft. high, N. of cor.

No B.T.'s available.

66.00 Adobe house hrs. South, 150 lks. dist.

80.00 The 1/16 sec. cor. No. 6 bet. secs. 17 and 18, N 1/4.

Land, level and rolling.  
Soil, 2nd and 3rd rate.  
Brush, greasewood and mesquite.  
Scattered palo verde, mesquite and cottonwood trees.  
Rolling land, 10 chs. Level and river bed, 70 chs.

Feb. 21, 1911: Cloudy at noon; no observation for latitude.



Subdivision T. 3 N., R. 7 E.

Chains

February 22, 1911, at 8h., a.m., l.m.t., I set off 33° 37' N. on the latitude arc, 10° 25' S. on the declination arc, and determine a meridian with the solar at the cor. of secs. 7, 8, 17 and 18.

Thence I run

N. 0° 1' E. bet. secs. 7 and 8,

Over level land, through dense growth of mesquite brush and trees.

1.95 Dry wash, 30 lks. wide, course W.

16.00 Road hrs. E. and W.

20.00 Set an iron post for 1/16 sec. cor. No. 12 bet. secs. 7 and 8, S 1/2, with brass cap stamped

No 12 in S.  
1/16 S 7 in W.  
S S " E.  
1911 " S.

From which -

Palo verde, 8 ins. in diam., hrs. S. 75° 30' E., 190 lks. dist., mkd. 1/16 S S B T  
Mesquite, 12 ins. in diam., hrs. N. 42° 30' W., 112 lks. dist., mkd. 1/16 S 7 B T

26.00 Leave level land; enter rolling, rocky land, with greasewood brush and scattered palo verde trees, hrs. N. 20° W. and S. 20° E.

40.00 Set an iron post for 1/4 sec. cor. bet. secs. 7 and 8, with brass cap stamped

1/4 S 7 in W.  
S S " E.  
1911 " S.

Raise mound of stone 2 ft. base, 1 1/2 ft. high, W. of cor.

No B.T.'s available.

60.00 set an iron post for 1/16 sec. cor. No. 6 bet. secs. 7 and 8, N 1/2, with brass cap stamped

No 6 in N.  
1/16 S 7 in W.  
S S " E.  
1911 " S.

From which -

Palo verde, 6 ins. in diam., hrs. S. 21° 15' E., 86 lks. dist., mkd. 1/16 S S B T  
Palo verde, 6 ins. in diam., hrs. S. 5° W., 81 lks. dist., mkd. 1/16 S 7 B T

66.20 Drain, course SW.

70.00 Begin steep descent, hrs. NE. and SW.

## Chains

76.50 Left bank of verde River, course SW.

Set an iron post for N. C. of secs. 7 and 8, with brass cap stamped

M S in N.  
1911 in S.  
T 3 N S 7 in SW. quadrant  
R 7 E S 8 " SE. "  
5 notches on E. edge.

Raise mound of ~~stone~~ 2 ft. base, 1½ ft. high, S. of cor.

No B.T.'s available.

76.70 Bed of river, course SW.

80.00 Point for cor. of secs. 5, 6, 7, and 8 falls on sand bar in bed of Verde River. I set stake for temp. cor., from which to run lines Easterly and Westerly, bet. secs. 5 and 8, and 6 and 7.

Land, level and rolling.  
Soil, 2nd and 4th rate.  
Rolling and rocky, 50.00 chs.  
Level, 26.00 chs.  
Brush, greasewood and mesquite.  
Scattered mesquite and palo verde trees.

From temp. cor. of secs. 5, 6, 7 and 8, on sand bar, I run S. 89° 56' W. on a random line bet. secs. 6 and 7.

20.00 Set temp. 1/16 sec. cor. No. 1.

40.00 Set temp. ¼ sec. cor.

60.00 Set temp. 1/16 sec. cor. No. 2.

80.04 Fall 4 lks. S. of cor. of secs. 1, 6, 7 and 12, on the W. bdy of the tp., previously described.

Thence I run

N. 89° 56' E. on a true line bet. secs. 6 and 7,

Over level land, through greasewood brush and scattered mesquite trees.

8.00 Drain, course SE.

12.70 Fence brs. NE. and SW.

13.50 McDowell road brs. NE. and SW.

16.45 Irrigation ditch, 10 lks. wide, course SW.

16.80 Fence brs. N. and S.

20.01 Set an iron post for 1/16 sec. cor. No. 2 bet. secs. 6 and 7, W½, with brass cap stamped

Subdivision T. 3 N., R. 7 E.

Chains

No 2 1/16 S 6 in N.  
S 7 1911 in S.

Dig pits 18x18x12 ins. E. and W. of post 3 ft. dist.; and raise mound of earth 3 1/2 ft. base, 1 1/2 ft. high, N. of cor.

No B.T.'s available.

40.02 Set an iron post for 1/4 sec. cor. bet. secs. 6 and 7, with brass cap stamped

1/4 S 6 in N.  
S 7 1911 in S.

Mesquite, 14 ins. in diam., brs. N. 63° E., 75 lks. dist., mkd. 1/4 S 6 E T

Mesquite, 20 ins. in diam., brs. S. 51° E., 90 lks. dist., mkd. 1/4 S 7 B T

48.30 Fence brs. NE. and SW.

53.00 Road brs. NE. and SW.

60.03 Set an iron post for 1/16 sec. cor. No. 1 bet. secs. 6 and 7, E 1/2, with brass cap stamped

No 1 1/16 S 6 in N.  
S 7 1911 in S.

From which -

Mesquite, 14 ins. in diam., brs. N. 80° 45' E., 90 lks. dist., mkd. 1/16 S 6 B T

Mesquite, 8 ins. in diam., brs. S. 12° 45' W., 130 lks. dist., mkd. 1/16 S 7 B T

66.37 Right bank of Verde River, course SW.

set an iron post for M. C. of secs. 6 and 7, with brass cap stamped

M C in E.  
1911 in S.  
T 3 N S 7 in SW. quadrant  
R 7 E S 6 " NW. "  
5 notches on the S.

from which -

Mesquite, 30 ins. in diam., brs. S. 22° 15' W., 100 lks. dist., mkd. T 3 N R 7 E S 7 M C B T

Mesquite, 36 ins. in diam., brs. N. 34° W., 39 lks. dist., mkd. T 3 N R 7 E S 6 M C B T

ascend 10 ft. bank to bed of river, course SW.

72.00 Middle of main channel of Verde River, 7 chs. wide, 2 1/2 ft. deep, course SW.

80.04 Temp. cor. of secs. 5, 6, 7 and 8, on sand bar.

Land, level.  
Soil, 2nd rate.  
Brush, greasewood and mesquite.  
Scattered mesquite and cottonwood trees.

## Subdivision T. 3 N., R. 7 E.

## Chains

- From the 1/16 sec. cor. No. 12 bet. secs. 7 and 8, S $\frac{1}{2}$ , I run  
S. 89°56' W. on a random line through S.  $\frac{1}{2}$  of sec. 7.
- 20.00 Set temp. 1/16 sec. cor. No. 11.
- 40.00 Set temp. 1/16 sec. cor. No. 10.
- 60.00 Set temp. 1/16 sec. cor. No. 9.
- 80.00 Fall 2 lks. N. of 1/16 sec. cor. No. 12 bet. secs. 7 and  
12, S $\frac{1}{2}$ , on the W. bdy. of the tp., previously described.  
Thence I run  
N. 89° 55' E. on a true line through S.  $\frac{1}{2}$  of sec. 7,  
Over level land, through brush and scattered mesquite and  
cottonwood timber.
- 9.00 Fence brs. N. and S.
- 10.50 Fence brs. N. 10° E. and S. 10° W.
- 13.60 Fence brs. NE. and SW.
- 20.00 Set an iron post for 1/16 sec. cor. No. 9 in the center  
of the SW.  $\frac{1}{4}$  of sec. 7, with brass cap stamped  
No 9 in N.  
1/16 S 7 in center  
1911 in S.  
Dig pite 18x18x12 ins. E. and W. of post 3 ft. dist.; and  
raise mound of earth 3 $\frac{1}{4}$  ft. base, 1 $\frac{1}{2}$  ft. high, N. of cor.  
No B.T.'s available.
- 25.00 Fence brs. NE. and SW.
- 27.35 Right bank of Verde River, course SW.  
Set an iron post for M. C. of sec. 7, with brass cap  
stamped  
M C in E.  
1911 in S.  
1/16 S 7 in W.
- From which -  
Mesquite, 24 ins. in diam., brs. N. 5° E., 62 lks.  
dist., mkd. 1/16 S 7 M C B T  
Elderberry, 8 ins. in diam., brs. West, 6 lks. dist.,  
mkd. 1/16 S 7 M C B T
- Descend 8 ft. bank to bed of Verde River, course SW.  
Thence over sand bar.
- 38.00 Middle of main channel of Verde River, 6 chs. wide, 2 $\frac{1}{2}$  ft.  
deep, course SW.
- 40.00 Point for 1/16 sec. cor. No. 10 bet. the SE. and SW.  $\frac{1}{4}$ s  
of sec. 7, falls in river channel.

Subdivision T.3 N., R. 7 E.

Chains

44.86 Left bank of Verde River, course SW.  
 Set an iron post for M. C. of sec. 7, with brass cap stamped  
 1/16 M C in W.  
 1911 in S.  
 S 7 in E.

From which -  
 Mesquite, 12 ins. in diam., brs. N. 16° E., 26 lks. dist., mkd. 1/16 S 7 M C B T  
 Mesquite, 10 ins. in diam., brs. S. 79° 15' E., 47 lks. dist., mkd. 1/16 S 7 M C B T

Thence over level land, through dense mesquite brush and scattered mesquite trees.

51.00 Irrigation ditch, 8 lks. wide, course SW.  
 53.10 Drain, course SW.

60.00 Set an iron post for 1/16 sec. cor. No. 11 in the center of the SE. 1/4 of sec. 7, with brass cap stamped  
 No 11 in N.  
 1/16 S 7 in center  
 1911 in S.

From which -  
 Mesquite, 8 ins. in diam., brs. N. 41° E., 146 lks. dist., mkd. 1/16 S 7 B T  
 Mesquite, 10 ins. in diam., brs. S. 4° 30' W., 71 lks. dist., mkd. 1/16 S 7 B T

80.00 The 1/16 sec. cor. No. 12, bet. secs. 7 and 8, St.  
 Land, level.  
 Soil, 2nd rate.  
 Brush, greasewood and mesquite. Scattered cottonwood and mesquite trees.

From the 1/16 sec. cor. No. 9 in the center of the SW. 1/4 of sec. 7, I run  
 South on a true line through middle of the SW. 1/4 of sec. 7,  
 Over level land, through brush and scattered mesquite and cottonwood trees.

4.55 Fence brs. NE. and SW.  
 4.65 Road brs. NE. and SW.  
 17.28 Right bank of Verde River, course SW.  
 Set an iron post for M. C. of sec. 7, with brass cap stamped

Subdivision T. 3 N., R. 7 E.

Chain

M C 1911 in S.  
1/16 S 7 in N.

From which -

Mesquite, 15 ins. in diam., hrs. N. 25° E., 34 lks.  
dist., mkd. 1/16 S 7 M C B T  
Cottonwood, 10 ins. in diam., hrs. S. 88° W., 56 lks.  
dist., mkd. 1/16 S 7 M C B T

bank 4 ft. high, sloping to bed of river, 60 lks. dist.

Brush, greasewood and mesquite.  
Scattered mesquite and cottonwood trees along river.  
Land, level.  
Soil, 2nd rate.

Feb. 22, 1911, at the  $\frac{1}{4}$  sec. cor. bet. secs. 7 and 8, I set off 10° 22' S. on the declination arc, and at 12h. 13m. 46s., p.m., l.m.t., observe the sun on the meridian; the resulting latitude is 33° 37' N., which is within 1' of the correct latitude.

Thence I run

S. 89° 56' W. on a random line through middle of sec. 7.

20.00 Set temp. 1/16 sec. cor. No. 7.

40.00 Set temp.  $\frac{1}{4}$  sec. cor.

60.00 set temp. 1/16 sec. cor. No. 8.

80.00 Fall 2 lks. N. of  $\frac{1}{4}$  sec. cor. bet. secs. 7 and 12, on the W. bdy. of the tp., previously described.

Thence I run

N. 89° 55' E. on a true line through middle of sec. 7,

Over rolling land, through brush and scattered palo verde trees.

2.00 Leave rolling land; enter level land, hrs. N. and S., covered with mesquite brush and scattered mesquite trees.

3.40 McDowell road hrs. N. and S.

3.80 Fence hrs. N. and S.

Leave brush; enter field.

15.50 Irrigation ditch, 10 lks. wide, course S.

20.00 set an iron post for 1/16 sec. cor. No. 8 bet. the NW. and SW.  $\frac{1}{4}$ s of sec. 7, with brass cap stamped

No 8 in N.  
1/16 S 7 in center  
1911 in S.

From which -

Cottonwood, 10 ins. in diam., hrs. S. 13° E., 210 lks. dist., mkd. 1/16 S 7 B T

## Subdivision T. 3 N., R. 7 E.

## Chains

Cottonwood, 8 ins. in diam., brs. S. 47° 15' E., 140  
lks. dist., mkd. 1/16 S 7 B T

22.00 Fence brs. NE. and SW.

Leave field; enter brush and scattered mesquite and cot-  
tonwood trees, br. NE. and SW.

30.50 Drain, course SW.

35.60 Fence brs. NE. and SW.

37.10 Right bank of Verde River, course SW.

Set an iron post for M. C. of sec. 7, with brass cap  
stamped

M C in E.  
1911 in S.  
1/16 S 7 in W.

From which -

Mesquite, 10 ins. in diam., brs. N. 27° 45' E., 92  
lks. dist., mkd. 1/16 S 7 M C B T  
Sycamore, 12 ins. in diam., brs. S. 66° 15' W., 150  
lks. dist., mkd. 1/16 S 7 M C B T

Descend 8 ft. bank to bed of river.

Thence over sand bar.

40.00 Point for C.  $\frac{1}{4}$  sec. cor. of sec. 7 falls in bed of river.

56.00 Middle of main channel of Verde River, course SW., 5 chs.  
wide, 3 ft. deep.

58.65 Left bank of Verde River.

Set an iron post for M. C. of sec. 7, with brass cap  
stamped

1/16 M C in W.  
1911 in S.  
S 7 in E.

From which -

Mesquite, 24 ins. in diam., brs. N. 41° 30' E., 94  
lks. dist., mkd. 1/16 S 7 M C B T  
Mesquite, 24 ins. in diam., brs. S. 20° 35' E., 214  
lks. dist., mkd. 1/16 S 7 M C B T

Thence over level land, through mesquite timber and brush.

60.00 Set an iron post for 1/16 sec. cor. No. 8 bet. the NE.  
and SE.  $\frac{1}{4}$ s of sec. 7, with brass cap stamped

No 7 in N.  
1/16 S 7 in center  
1911 in S.

From which -

BOOK 2806

Subdivision T. 3 N., R. 7 E.

Chains

Catolaw, 8 ins. in diam., brs. S. 83° 30' E., 74 lks.  
dist., mkd. 1/16 S 7 B T  
Mesquite, 8 ins. in diam., brs. N. 75° 45' W., 44 lks.  
dist., mkd. 1/16 S 7 B T

61.07 Irrigation ditch, 20 lks. wide, course S. 15° W.  
72.00 Leave level land; enter rolling, rocky land, brs. N. 20° W.  
and S. 20° E.

80.00 The 1/4 sec. cor. bet. secs. 7 and 8.  
Land, level and rolling.  
Soil, 2nd and 3rd rate.  
Brush, greasewood and mesquite. Scattered palo verde, mes-  
quite and cottonwood trees.  
Rolling and rocky land, 2.00 chs.  
Level and river bed, 78.00 chs.

-----  
From the 1/16 sec. cor. No. 7, bet. the NE. and SE. 1/4 of  
sec. 7, I run

North on a true line through the middle of the NE. 1/4 of  
sec. 7,

Over level land, through mesquite brush and timber.

1.90 Left bank of Verde River, course SW.  
Set an iron post for N. C. of sec. 7, with brass cap  
stamped

1/16 M C in N.  
S 7 1911 in S.

From which -

Mesquite, 14 ins. in diam., brs. N. 35° 45' E., 82  
lks. dist., mkd. 1/16 S 7 M C B T  
Mesquite, 12 ins. in diam., brs. S. 49° 30' E., 186  
lks. dist., mkd. 1/16 E 7 M C B T

Bank 8 ft. high.

2.10 Edge of water.  
Land, level.  
Soil, 2nd rate.  
Brush, mesquite.  
Scattered mesquite trees of sufficient size to be classed  
as timber.

-----  
From the 1/16 sec. cor. No. 6 bet. secs. 7 and 8, N 1/4,  
I run

S. 89° 56' W. on a random line through N. 1/4 of sec. 7.

20.00 Set temp. 1/16 sec. cor. No. 5.

40.00 set temp. 1/16 sec. cor. No. 4.

60.00 set temp. 1/16 sec. cor. No. 3.



Subdivision T. 3 N., R. 7 E.

Chains

80.04 Fall 2 lks. N. of 1/16 sec. cor. No. 6 bet. secs. 7 and 12, N $\frac{1}{2}$ . on the W. bdy. of the tp., previously described.  
 Thence I run  
 N. 89° 55' E. on a true line through N.  $\frac{1}{2}$  of sec. 7,  
 Over rolling land, through greasewood brush and scattered palo verde trees.

6.00 Leave rolling land; enter level land, brs. NW. and SE., covered with mesquite brush and scattered trees.

8.00 McDowell road, brs. NE. and SW.

8.47 Fence brs. NE. and SW.  
 Leave brush and enter field, brs. N. and S.

18.00 Brush hut, brs. S., 1 ch. dist.

20.01 Set an iron post for 1/16 sec. cor. No. 3 in the center of the NW.  $\frac{1}{4}$  of sec. 7, with brass cap stamped  
 NO 3 in N.  
 1/16 S 7 in center  
 1911 in S.  
 Dig pits 18x18x12 ins. E. and W. of post 3 ft. dist.; and raise mound of earth 3 $\frac{1}{2}$  ft. base, 1 $\frac{1}{2}$  ft. high, N. of cor.  
 No B.T.'s available.

20.50 Brush hut, brs. S., 50 lks. dist.

24.20 Irrigation ditch, 8 lks. wide, course S.

31.50 fence brs. NW. and SE.  
 Leave field; enter brush and scattered trees, brs. NW. & SE.

40.02 Set an iron post for 1/16 sec. cor. No. 4 bet. the NE. and NW.  $\frac{1}{4}$ s of sec. 7, with brass cap stamped  
 No 4 in N.  
 1/16 S 7 in center  
 1911 in S.  
 From which -  
 Mesquite, 10 ins. in diam., brs. S. 51° W., 102 lks. dist., mkd. 1/16 S 7 B T  
 Mesquite, 14 ins. in diam., brs. N. 60° W., 97 lks. dist., mkd. 1/16 S 7 B T

40.10 Two brush huts near S., 150 lks. dist.

41.80 Fence brs. N. and S.

43.50 Road brs. N. and S.

56.40 Right bank of Verde River, course SW.  
 Set an iron post for M. C. of sec. 7, with brass cap stamped

Subdivision T. 3 N., R. 7 E.

Chains	<p>M C in E. 1911 in S. 1/16 S 7 in W.</p>
	<p>From which -</p>
	<p>Mesquite, 20 ins. in diam., brs. S. 85° 45' W., 85 lks. dist., mkd. 1/16 S 7 M C B T</p>
	<p>Mesquite, 24 ins. in diam., brs. N. 40° 45' W., 97 lks. dist., mkd. 1/16 S 7 M C B T</p>
	<p>Descend sloping bank, 4 ft. high, to bed of river.</p>
	<p>Thence over sand bar.</p>
60.03	<p>Point for 1/16 sec. cor. No. 5 in the center of the NE. 1/4 of sec. 7, falls in river.</p>
67.00	<p>Middle of main channel of Verde River, 5 chs. wide, 2 1/2 ft. deep, course SW.</p>
69.95	<p>Left bank of Verde River, course SW.</p>
	<p>Set an iron post for M. C. of sec. 7, with brass cap stamped</p>
	<p>1/16 M C in W. 1911 in S. S 7 in E.</p>
	<p>From which -</p>
	<p>Willow, 14 ins. in diam., brs. N. 18° 15' E., 69 lks. dist., mkd. 1/16 S 7 M C B T</p>
	<p>Willow, 18 ins. in diam., brs. S. 46° 45' W., 127 lks. dist., mkd. 1/16 S 7 M C B T</p>
	<p>Thence ascend steep bluff.</p>
72.00	<p>Top of bluff.</p>
	<p>Thence over rolling land, through greasewood brush and scattered pale verde trees.</p>
76.00	<p>Drain, course SW.</p>
80.01	<p>The 1/16 sec. cor. No. 6 bet. secs. 7 and 8, NE 1/4.</p>
	<p>Land, rolling and level. Soil, 2nd and 4th rate.</p>
	<p>Rolling land, 17.05 chs. Level and river bed, 62/99 chs.</p>
	<p>Brush, greasewood and mesquite. Scattered paloverde and mesquite trees.</p>
-----	
	<p>From 1/16 sec. cor. No. 1 bet. secs. 6 and 7, NE 1/4, I run</p>
	<p>South on a true line through middle of NE 1/4 of sec. 7,</p>
	<p>Over level land, through brush and scattered mesquite trees.</p>
13.30	<p>Right bank of Verde River, course SW.</p>
	<p>Set an iron post for M. C. of sec. 7, with brass cap stamped</p>
	<p>M C 1911 in S. 1/16 S 7 in N.</p>

Subdivision T. 3 N., R. 7 E.

Chains

From which -

Mesquite, 10 ins. in diam., brs. S. 70° 45' W., 90  
lks. dist., mkd. 1/16 S 7 M C B T  
Mesquite, 8 ins. in diam., brs. N. 65° 15' W., 106  
lks. dist., mkd. 1/16 S 7 M C B T

Bank 10 ft. high, sloping to

13.50 Edge of river bed, course SW.

Land, level and sandy.  
Brush, greasewood and mesquite, and scattered mesquite  
trees.

From the 1/16 sec. cor. No. 4 bet. the NE. and NW. 1/4s of  
sec. 7, I run

South on a true line through the middle of N 1/2 of sec. 7,  
Over level land, through brush and scattered trees.

1.50 Brush huts bear West, 15 lks. dist.

3.20 Fence brs. E. and W.

13.45 Fence brs. NE. and SW.

15.62 Right bank of Verde River, course SW.

Set an iron post for M. C. of sec. 7, with brass cap  
stamped

M C 1911 in S.  
1/16 S 7 in N.

From which -

Mesquite, 30 ins. in diam., brs. N. 43° 5' E., 25  
lks. dist., mkd. 1/16 S 7 M C B T  
Cottonwood, 30 ins. in diam., brs. S. 32° W., 305  
lks. dist., mkd. 1/16 S 7 M C B T

Bank 4 ft. high, sloping to

16.02 Bed of river.

Land, level.  
Soil, 2nd rate.  
Greasewood brush. Scattered mesquite and cottonwood trees.

I did not attempt to run line bet. secs. 5 and 6, from  
the temp. cor. of secs. 5, 6, 7 and 8, on sand bar, as  
this entire line was in river channel and on sand bar;  
and it was impracticable to up the channel on account  
of high water.

- February 22, 1911.

Subdivision T. 3 N., R. 7 E.

Chains

February 23, 1911, at 8h., a.m., l.m.t., I set off 33° 37' N. on the lat. arc, 10° 4' S. on the decl. arc, and determine a meridian with the solar at the 1/16 sec. cor. No. 12 bet. secs. 1 and 6, S $\frac{1}{4}$ , on the W. bdy. of the tp., previously described.

Thence I run

East on a true line through the S.  $\frac{1}{4}$  of sec. 6

Over level land which has been cultivated in the past, but is now covered with thick growth of mesquite brush, with a few scattered pale verde and mesquite trees.

16.65 Fence brs. N. and S.

20.00 Set an iron post for 1/16 sec. cor. No. 9 in the center of the SW.  $\frac{1}{4}$  of sec. 6, with brass cap stamped

No 9 in N.  
1/16 S 6 in center  
1911 in S.

From which -

Pale verde, 10 ins. in diam., brs. S. 89° 30' E., 220 lks. dist., mkd. 1/16 S 6 B T  
No other B.T. within limits.

Raise mound of stone 2 ft. base, 1 $\frac{1}{2}$  ft. high, N. of cor.

36.00 Fence brs. N. and S.

36.50 McDowell road brs. N. and S.

40.00 Point for 1/16 sec. cor. No. 10 falls in irrigation ditch, 15 lks. wide, course SW. Therefore, at

40.45 Set an iron post for W. C. to 1/16 sec. cor. No. 10 bet. the SE. and SW.  $\frac{1}{4}$ s of sec. 6, with brass cap stamped

No 10 in N.  
1/16 S 6 in center  
W C 1911 in S.

From which -

Pale verde, 8 ins. in diam., brs. S. 83° 30' W., 67 lks. dist., mkd. 1/16 S 6 W C B T  
Mesquite, 10 ins. in diam., brs. S. 63° 45' E., 95 lks. dist., mkd. 1/16 S 6 W C B T

41.12 Fence brs. N. and S.

50.82 Fence brs. N. and S.

58.40 Fence brs. N. and S.

60.00 Set an iron post for 1/16 sec. cor. No. 11 in the center of the SE.  $\frac{1}{4}$  of sec. 6, with brass cap stamped

No 11 in N.  
1/16 S 6 in center  
1911 in S.

Dig pits 18x18x12 ins. E. and W. of post 3 ft. dist.; and raise mound of earth 3 $\frac{1}{2}$  ft. base, 1 $\frac{1}{2}$  ft. high, N. of cor.

Subdivision T. 3 N., R. 7 E.

Chains

71.30 Fence brs. N. and S.

74.50 Road brs. N. and S.

75.63 Right bank of Verde River, course SW.

Set an iron post for M. C. of sec. 6, with brass cap stamped

M C in E.  
1911 in S.  
1/16 S 6 in W.

From which -

Mesquite, 8 ins. in diam., brs. S. 76° 30' W., 159 lks. dist., mkd. 1/16 S 6 M C B T  
Mesquite, 20 ins. in diam., brs. N. 26° W., 38 lks. dist., mkd. 1/16 S 6 M C B T

Bank 8 ft. high.

75.83 Bed of river.

Land, level.  
Soil, 2nd rate.  
Brush, mesquite.  
Scattered palo verde and mesquite trees.

From the 1/4 sec. cor. bet. secs. 1 and 6, on the W. bdy. of the tp., previously described, I run

East on a true line through middle of sec. 6,

Over level land, which has been cultivated but is now overgrown with mesquite brush and a few scattered mesquite trees.

1.80 Shallow drain, course S.

20.00 Set an iron post for 1/16 sec. cor. No. 8 bet. the NW. and SW. 1/4 of sec. 6, with brass cap stamped

No 8 in N.  
1/16 S 6 in center  
1911 in S.

Big pits 18x18x12 ins. E. and W. of post 3 ft. dist.; and raise mound of earth 3 1/2 ft. base, 1 1/2 ft. high, N. of cor.

No B.T.'s available.

21.85 Fence brs. N. and S.

37.38 Fence brs. N. and S.

38.80 McDowell road brs. N. and S.

39.80 Fence brs. N. and S.

Subdivision T. 3 N., R. 7 E.

Chains

40.00 Set an iron post for C. 1/4 sec. cor. of sec. 6, with brass cap stamped

C 1/4 S 6 in center  
1911 in S.

From which -

Mesquite, 10 ins. in diam., brs. N. 75° 45' E., 213 lks. dist., mkd. C 1/4 S 6 B T

Mesquite, 10 ins. in diam., brs. N. 80° E., 177 lks. dist., mkd. C 1/4 S 6 B T

48.90 Irrigation ditch, 8 lks. wide, course S.

55.00 Brush hut brs. S., 1 ch. dist.

55.50 Fence, brs. N. and S.

Leave brush; enter cultivated field, brs. N. and S.

60.00 Set an iron post for 1/16 sec. cor. No. 7 bet. the NE. and SE. 1/4s of sec. 6, with brass cap stamped

No 7 in N.  
1/16 S 6 in center  
1911 in S.

Dig pits 18x18x12 ins. E. and W. of post 3 ft. dist.; and raise mound of earth 3 1/2 ft. base, 1 1/2 ft. high, N. of cor.

No B.T.'s available.

76.40 Fence brs. N. and S.

Leave field; enter brush and mesquite trees, br. N. and S.

76.80 Road brs. N. and S.

77.66 Right bank of verde River, course SE.

Set an iron post for M. C. Of sec. 6, with brass cap stamped

M C in E.  
1911 in S.  
1/16 S 6 in W.

From which -

Mesquite, 20 ins. in diam., brs. N. 80° 30' W., 10 lks. dist., mkd. 1/16 S 6 M C B T

Mesquite, 8 ins. in diam., brs. S. 40° 45' W., 42 lks. dist., mkd. 1/16 S 6 M C B T

Bank 12 ft. high.

77.96 Bed of river, course SE.

Land, level.  
Soil, 2nd rate. Field, 20.90 chs. Brushy, 56.76 chs.  
Brush, greasewood and mesquite.  
Scattered palo verde and mesquite trees.

## Subdivision T. 3 N., R. 7 E

## Chains

February 23, 1911, at the 1/16 sec. cor. No. 6 bet. secs. 1 and 6, N $\frac{1}{2}$ , on the W. bdy. of the tp., previously described, I set off 10° 1' S on the declination arc, and at 12h. 13m. 39s., p.m., l.m.t., observe the sun on the meridian; the resulting latitude is 33° 39' N., which is within 1' of the correct latitude.

Thence I run

East on a true line through N.  $\frac{1}{2}$  of sec. 6,

Over level land, through greasewood brush and scattered palo verde trees.

17.50 Irrigation ditch, 10 lks. wide, course S.

18.50 Fence brs. N. and S.

Leave brush; enter cultivated land.

20.00 Set an iron post for 1/16 sec. cor. No 3, in the center of the NW.  $\frac{1}{4}$  of sec. 6, with brass cap stamped

No 3 in N.  
1/16 S 6 in center  
1911 in S.

Dig pits 18x18x12 ins. E. and W. of post 3 ft. dist.; and raise mound of earth 3 $\frac{1}{2}$  ft. base, 1 $\frac{1}{2}$  ft. high, N. of cor.

No B.T.'s available.

23.00 Church, brs. N., 3.00 chs. dist.

28.16 Fence brs. N. and S.

Leave cultivated land; thence across road, brs. N. and S.

28.76 Fence brs. N. and S.

Leave road; enter lot around Indian Superintendent's quarters.

30.40 SW. cor. of Indian Superintendent's house, on line.

31.22 fence brs. N. and S.

31.42 School house, brs. N., 10 lks. dist.

32.87 Stable, on line.

33.00 Fence, brs. N. and S.

35.30 fence brs. N. and S.

Leave lot around Indian Superintendent's quarters; enter land which has been cultivated, but is now covered with thin brush and scattered mesquite trees.

36.58 W. fork of McDowell road, brs. N. and S.

37.85 E. fork of McDowell road, brs. N. 15° E. and S. 15° W.

## Subdivision T. 3 N., R. 7 E.

## Chains

40.00 get an iron post for 1/16 sec. cor. No. 4 bet. the NE.  
and NW.  $\frac{1}{4}$ s of sec. 6, with brass cap stamped

No 4 in N.  
1/16 S 6 in center  
1911 in S.

From which -

Mesquite, 12 ins. in diam., brs. N. 61° 45' E., 210  
lks. dist., mkd. 1/16 S 6 B T  
Mesquite, 10 ins. in diam., brs. S. 57° 15' W., 17  
lks. dist., mkd. 1/16 S 6 B T

47.74 Fence brs. N. and S.

Leave scattered brush; enter field, brs. N. and S.

51.00 Irrigation ditch, 10 lks. wide, course S.

60.00 get an iron post for 1/16 sec. cor. No. 5 in the center  
of the NE.  $\frac{1}{4}$  of sec. 6, with brass cap stamped

No 5 in N.  
1/16 S 6 in center  
1911 in S.

From which -

Mesquite, 14 ins. in diam., brs. N. 86° W., 300 lks.  
dist., mkd. 1/16 S 6 B T

This tree is the only one within limits, and has  
been saved for shade in the field.

Dig pits 18x18x12 ins. E. and W. of post 3 ft. dist.; and  
raise mound of earth 3 $\frac{1}{2}$  ft. base, 1 $\frac{1}{2}$  ft. high, N. of cor.

62.00 fence brs. N. and S.

69.56 fence brs. N. and S.

Leave field; enter brush and scattered mesquite trees.

69.83 Road brs. N. and S.

72.25 Right bank of verde River, course SE.

Set an iron post for M. C. of sec. 6, with brass cap  
stamped

M C in E.  
1912 in S.  
1/16 S 6 in W. of center

from which -

Mesquite, 14 ins. in diam., brs. S. 82° 30' E., 5  
lks. dist., mkd. 1/16 S 6 M C B T  
Mesquite, 12 ins. in diam., brs. N. 35° 15' W., 65  
lks. dist., mkd. 1/16 S 6 M C B T

Bank 15 ft. high.

72.58 bed of river, course SE.



Book 2896

Subdivision T. 3 N., R. 7 N.

Chains

Land, level.  
Soil, 2nd rate.  
Cultivated land, 34.08 chs. Brush, 33.63 chs. Superintendent's quarters, 4.54 chs.

From the 1/16 sec. cor. N o. 5 in the center of the NE. 1/4 of sec. 6, I run North on a true line through the middle of the NE. 1/4 of sec. 6,

Over level land, through field.

5.80 fence brs. N. and S.

Leave field; enter yard.

8.50 House brs. West, 60 lks. dist.

9.50 Fence brs. E. and W.

Leave yard; enter road, brs. E. and W.

9.60 Middle of road, brs. E. and W.

9.90 Leave road; enter land which has been cultivated in the past but is now vacant and covered with thin brush and scattered trees.

Wind mill and pump bear East, 3 chs. dist.

11.80 Right bank of Verde River, course SE.

Set an iron post for M. C. Of sec. 6, with brass cap stamped

1/16 M C in N.  
S 6 1911 in S.

From which -

Mesquite, 8 ins. in diam., brs. S. 69° E., 89 lks. dist., mkd. 1/16 S 6 M C B T

Mesquite, 8 ins. in diam., brs. N. 60° 30' W., 43 lks. dist., mkd. 1/16 S 6 M C B T

Bank 15 ft. high.

12.10 bed of river.

Land, level.  
Soil, 2nd rate.  
Cultivated land, 5.80 chs.  
Yard and brush, 6.00 chs.

- February 23, 1911.

February 24, 1911, at 8h., a.m., l.m.t., I set off 33° 33' N. on the latitude arc, 9° 41' S. on the declination arc, and determine a meridian with the solar at

Subdivision T. 3 N., R. 7 E.

Chains

the cor. of secs. 4, 5, 32 and 33, on the S. bdy. of the tp., previously described.

Thence I run

N. 0° 1' E. bet. secs. 32 and 33,

Over level land, through greasewood brush and scattered palo verde and mesquite trees.

8.00 Dry wash, 10 lks. wide, course SE.

10.00 Leave level land; enter rolling rocky land, brs. E. and W.

36.00 begin ascent, brs. E. and W.

40.00 Set an iron post for  $\frac{1}{4}$  sec. cor. bet. secs. 32 and 33,  
with brass cap stamped

$\frac{1}{4}$  S 32 in W.  
S 33 " E.  
1911 " S.

Raise mound of stone 2 ft. base,  $1\frac{1}{2}$  ft. high, W. of cor.

No B T.'s available.

54.50 Top of ascent; begin descent, brs. E. and W.

64.00 Foot of descent; begin ascent, brs. E. and W.

74.00 Top of ascent; begin descent, brs. E. and W.

80.00 Set an iron post for cor. of secs. 28, 29, 32 and 33,  
with brass cap stamped

T 3 N S 28 in NE. quadrant  
R 7 E S 33 " SE. "  
S 32 " SW. "  
S 29 " NW. "  
1911 " S.

1 notch on the S. and 4 on the E. edge.

Raise mound of stone 2 ft. base,  $1\frac{1}{2}$  ft. high, W. of cor.

No B.T.'s available.

Land, level and rolling.

Soil, 2nd and 4th rate.

Level land, 10 chs.

Greasewood brush. Scattered palo verde and mesquite trees.

West on a random line bet. secs. 29 and 32.

40.00 get temp.  $\frac{1}{4}$  sec. cor.

60.00 Set temp.  $1/16$  sec. cor. No. 2.

80.00 Intersect temp. cor. of secs. 29, 30, 31 and 32, on sand  
bar in Verde River.

Thence I run

Subdivision T. 3 N., R. 7 E.

Chains

East on a true line bet. secs. 29 and 32,  
 Over sand bar in bed of Verde River, course SW.

5.35 Left bank of Verde River, course SW.  
 Set an iron post for M. C. Of secs. 29 and 32, with brass  
 cap stamped

M C in W.  
 1911 in S.  
 T 3 N S 29 in NE. quadrant  
 R 7 E S 32 " SW. "  
 1 notch on the S.

Dig a pit 36x36x12 ins. 8 ft. E. of post, and raise mound  
 of earth 4 ft. base, 2 ft. high, E. of cor.

No B.T.'s available.

Thence over level land through mesquite brush.

20.00 Set an iron post for 1/16 sec. cor. No. 2 bet. secs. 29  
 and 32, W $\frac{1}{2}$ , with brass cap stamped

No 2 1/16 S 29 in N.  
 S 32 1911 in S.

Dig pits 18x18x12 ins. E. and W. of post 3 ft. dist.; and  
 raise mound of earth 3 $\frac{1}{2}$  ft. base, 1 $\frac{1}{2}$  ft. high, N. of cor.

24.00 Leave level and enter rolling land.  
 begin ascent, brs. NE. and SW.

30.00 Top of ascent, brs. NE. and SW.  
 Thence over rolling, rocky land, through scattered palo  
 verde trees.

40.00 Set an iron post for  $\frac{1}{4}$  sec. cor. bet. secs. 29 and 32,  
 with brass cap stamped

$\frac{1}{4}$  S 29 in N.  
 S 32 1911 in S.

Raise mound of stone 2 ft. base, 1 $\frac{1}{2}$  ft. high, N. of cor.  
 No B.T.'s available.

After diligent search, find no trace of old cor.

46.00 Small wash, 8 lks. wide, course N. 40° W.

57.60 Middle of dry wash, 10 lks. wide, course NW.  
 begin ascent, brs. NE. and SW.

80.00 The cor. of secs. 28, 29, 32 and 33.  
 Land, level and rolling.  
 Soil, 2nd and 4th rate.  
 Brush, mesquite and greasewood, with scattered palo verde  
 trees.

---

## Subdivision T. 3 N., R. 7 E.

## Chains

East on a true line bet. secs. 28 and 33,

Over rolling, rocky land, through greasewood brush and scattered palo verde trees, ascending.

1.00 Top of ascent; begin descent, brs. NE. and SW.

23.00 Drain, course N.

Foot of descent; begin ascent, brs. N. 10° E. and S. 10° W.

37.40 Intersect East bdy. of old Camp McDowell Reservation, at a point from which the SE. cor. of the old Camp McDowell Reservation brs. N. 6° 45' E., 34.61 chs. dist.

Set iron post for C. C. of secs. 28 and 33, with brass cap stamped

C C in W.

1911 in S.

T 3 N 8 33 in SW. quadrant

R 7 E 8 28 " NW. "

1 notch on the S. and 5 on the N. edge.

Raise mound of stone 3 ft. base, 2 ft. high, W. of cor.

No B.T.'s available.

Land, rolling and rocky.

Soil, 4th rate.

Brush, greasewood Scattered palo verde trees.

February 24, 1911, at the cor. of secs. 28, 29, 32 and 33, I set off 9° 38' S. on the declination arc, and at 12h. 13m. 30s., p.m., l.m.t., observe the sun on the meridian; the resulting latitude is 33° 34' N., which is within 1' of the correct latitude.

Thence I run

N. 0° 1' E. bet. secs. 28 and 29,

Over rolling, rocky land,

Through greasewood brush and scattered palo verde trees,

Descending North face of hill.

NOTE: In this mile, at about 27 chs., my line intersects the original South bdy. of the old Camp McDowell Reservation. I make diligent search for 10 chs. in each direction, but fail to find any trace whatever of the 14½ M. P., which should be within less than 10 chs. E. of my line, according to plat I have of original survey. Therefore, I decide that this cor. has been destroyed, and continue N. 0° 1' E., making no tie

## Subdivision T. 3 N., R. 7 E.

## Chains

to this old Reservation bdy. line.

40.00 Set an iron post for  $\frac{1}{4}$  sec. cor. bet. secs. 28 and 29,  
with brass cap stamped

$\frac{1}{4}$  S 28 in W. half  
S 28 " E. "  
1911 " S.

Raise mound of stone 2 ft. base,  $1\frac{1}{2}$  ft. high, W. of cor.

No B.T.'s available.

53.50 Foot of descent.

Drain, course NW.

Thence over rolling land.

70.00 Middle of dry wash, 50 lks. wide, course N.  $70^{\circ}$  W.

80.00 Set an iron post for cor. of secs. 20, 21, 28 and 29,  
with brass cap stamped

T 3 N S 21 in NE. quadrant  
R 7 E S 28 " SE. "  
S 29 " SW. "  
S 20 " NW. "  
1911 " S.

2 notches on the S. and 4 on the E. edge.

Raise mound of stone 2 ft. base,  $1\frac{1}{2}$  ft. high, W. of cor.

No B. T.'s available.

Land, rolling and rocky.

Soil, 4th rate.

Brush, greasewood. Scattered palo verde trees.

After diligent search, find no trace of old cor.

West on a random line bet. secs. 20 and 29.

40.00 Set temp.  $\frac{1}{4}$  sec. cor.

60.00 Set temp.  $1/16$  sec. cor. No. 2.

80.00 Intersect temp. cor. of secs. 19, 20, 29 and 30, on sand  
bar in bed of Verde River.

Thence I run

East on a true line bet. secs. 20 and 29,

Over sand bar.

1.86 Left bank of verde River, course SW.

Set an iron post for M. C. of secs. 20 and 29, with brass  
cap stamped

M C in W.  
1911 in S.

## Subdivision T. 3 N., R. 7 E.

## Chains

T 3 N S 20 in NE. quadrant  
 R 7 E S 29 " SE. "  
 2 notches on the S.

From which -

Mesquite, 10 ins. in diam., brs. S. 50° E., 127 lks.  
 dist., mkd. T 3 N R 7 E S 29 M C B T  
 Mesquite, 12 ins. in diam., brs. S. 27° 15' W., 28  
 lks. dist., mkd. T 3 N R 7 E S 29 M C B T

Thence over rolling land, through dense mesquite brush  
 and scattered trees.

20.00 get an iron post for 1/16 sec. cor. No. 2 bet. secs. 20  
 and 29, W  $\frac{1}{4}$ , with brass cap stamped

No 2 1/16 S 20 in N.  
 S 29 1911 in S.

from which -

Mesquite, 24 ins. in diam., brs. N. 15° 15' W., 20  
 lks. dist., mkd. 1/16 S 20 B T  
 Mesquite, 8 ins. in diam., brs. S. 71° 30' E., 160  
 lks. dist., mkd. 1/16 S 29 B T

20.10 irrigation ditch, 10 lks. wide, course SW.

32.00 Middle of dry wash, 80 lks. wide, course NW.

40.00 get an iron post for  $\frac{1}{4}$  sec. cor. bet. secs. 20 and 29,  
 with brass cap stamped

$\frac{1}{4}$  S 20 in N.  
 S 29 1911 in S.

From which -

Mesquite, 8 ins. in diam., brs. North, 85 lks. dist.,  
 mkd.  $\frac{1}{4}$  S 20 B T  
 Mesquite, 8 ins. in diam., brs. S. 42° W., 235 lks.  
 dist., mkd.  $\frac{1}{4}$  S 29 B T

After diligent search, find no trace of old cor.

46.00 Leave level land; enter rolling land, brs. NW. and SE.,  
 with greasewood brush and scattered palo verde trees.

80.00 The cor. of secs. 20, 21, 28 and 29.

Land, level and rolling.  
 Soil, 2nd and 4th rate.  
 Level, 46.00 chs. Rolling, 34.00 chs.  
 Brush, greasewood and mesquite. Scattered palo verde and  
 mesquite trees.

From the 1/16 sec. cor. No. 2 bet. secs. 29 and 32, W  $\frac{1}{4}$ ,

I run

N. 0° 1' E. on a random line through middle of W.  $\frac{1}{4}$  of

Subdivision T. 3 N., R. 7 E.

Chains	
	sec. 29.
20.00	Set temp. 1/16 sec. cor. No. 9.
40.00	Set temp. 1/16 sec. cor. No. 8.
60.00	Set temp. 1/16 sec. cor. No. 3.
80.00	Intersect 1/16 sec. cor. No. 2 bet. secs. 20 and 29, W $\frac{1}{2}$ . Thence I run S. 0° 1' W. on a true line through middle of the W. $\frac{1}{4}$ of sec. 29, Over level land, through mesquite brush and scattered trees.
0.20	Old irrigation ditch, 8 lks. wide, course SW.
2.00	Leave level land; enter rolling, rocky land. begin ascent, brs. NE. and SW.
15.00	Top of ascent; begin descent, brs. NW. and SE.
19.00	Foot of descent; begin ascent, brs. NW. and SE.
20.00	Set an iron post for 1/16 sec. cor. No. 3 in the center of the NW. $\frac{1}{4}$ of sec. 29, with brass cap stamped  No 3 in N. 1/16 S 29 in center 1911 in S.  Raise mound of stone 2 ft. base, 1 $\frac{1}{2}$ ft. high, W. of cor. No B.T.'s available.
24.00	Top of ascent, brs. NE. and SW. Thence along top of hill.
36.00	Begin descent, brs. NW. and SE.
40.00	set an iron post for 1/16 sec. cor. No. 8 bet. the NW. and SW. $\frac{1}{4}$ s of sec. 29, with brass cap stamped  No 8 in N. 1/16 S 29 in center 1911 in S.  Raise mound of stone 2 ft. base, 1 $\frac{1}{2}$ ft. high, W. of cor. No B.T.'s available.
48.00	Old irrigation ditch, 10 lks. wide, course SE.
56.00	Foot of descent; leave rolling land; enter flat land, cov- ered with dense growth of mesquite brush, brs. NW.& SE.
60.00	Set an iron post for 1/16 sec. cor. No. 9 in the center of the SW. $\frac{1}{4}$ of sec. 29, with brass cap stamped

## Subdivision T. 3 N., R. 7 E.

Chains

No 9 in N.  
 1/16 S 29 in center  
 1911 in S.

Dig pits 18x18x12 ins. N. and S. of post 3 ft. dist.; and raise mound of earth 3 1/2 ft. base, 1 1/2 ft. high, W. of cor.

80.00 The 1/16 sec. cor. No. 2 bet. secs. 29 and 32, W 1/2.

Land, level and rolling.  
 Soil, 2nd and 4th rate,  
 Brush, greasewood and mesquite.

NOTE:

The line bet. secs. 29 and 30 was run at a time when the water in the river was very low, and it was possible to run on the sand bar, and set temp. 1/16 sec. cors. Nos. 6 and 12, and 1/4 sec. cor., bet. secs. 29 and 30. When the lines <sup>through</sup> the S 1/4, middle, and N 1/2 of sec. 29 were run, the high water had come, and it was impossible to reach 1/16 and 1/4 sec. cors.; therefore, these lines were run West, on true lines.

From the 1/16 sec. cor. No. 9, in the center of the SW. 1/4 of sec. 29, I run

West on a true line through middle of the SW. 1/4 of sec. 29,

Over level land, through dense mesquite brush.

6.30 Left bank of Verde River, course S.

set an iron post for M. C. of sec. 29, with brass cap stamped

1/16 M C in W.  
 1911 in S.  
 B 29 in E.

Dig a pit 36x36x12 ins. S ft. E. of post and raise mound of earth 4 ft. base, 2 ft. high, E. of cor.

Bank 6 ft. high.

7.30 Bed of river.

Land, level and sandy.  
 Soil, 2nd rate.  
 Brush, mesquite.

From the 1/16 sec. cor. No. 8 bet. the NW. and SW. 1/4 of sec. 29, I run



Subdivision T. 3 N., R. 7 E.

Chains

West on a true line through middle of sec. 29, W $\frac{1}{4}$ ,  
Over rocky land, on descent, brs. NW. and SE.

4.00 Foot of descent; enter level land, covered with dense  
growth of mesquite brush, brs. NW. and SE.

6.00 Irrigation ditch, 8 lks. wide, course SE.

11.49 Left bank of Verde River, course SE.

Set an iron post for M. C. of sec. 29, with brass cap  
stamped

1/16 M C in W.  
1911 in S.  
S 29 in E.

Dig a pit 36x36x12 ins. 8 ft. E. of post and raise mound  
of earth 4 ft. base, 2 ft. high, E. of cor.

No B.T.'s available.

Bank 8 ft. high.

12.00 Bed of river.

Land, 4 chs. rolling and rocky. 7.49 chs. level and sandy.  
Soil, 2nd and 4th rate.  
Mesquite brush.

From the 1/16 sec. cor. No. 3 in the center of the NW.  $\frac{1}{4}$   
of sec. 29, I run

West on a true line through middle of the NW.  $\frac{1}{4}$  of sec. 29,  
Over level land, through mesquite brush and scattered mes-  
quite and cottonwood trees.

6.80 Irrigation ditch, 8 lks. wide, course S.

16.80 Left bank of Verde River, course S.

Set an iron post for M. C. of sec. 29, with brass cap  
stamped

1/16 M C in W.  
1911 in S.  
S 29 in E.

From which -

Mesquite, 8 ins. in diam., brs. S. 6° 45' E., 70 chs.  
dist., mkd. 1/16 S 29 M C B T  
Mesquite, 8 ins. in diam., brs. N. 8° 15' W., 117 chs.  
dist., mkd. 1/16 S 29 M C B T

Bank, 8 ft. high.

17.00 Bed of river.

## Subdivision T. 3 N., R. 7 E.

## Chains

Land, level.  
Soil, 2nd rate.  
Brush and timber, mesquite.

- February 24, 1911.

February 25, 1911, at 8h., a.m., l.m.t., I set off  $33^{\circ} 35'$  N. on the latitude arc,  $9^{\circ} 19'$  S. on the declination arc, and determine a meridian with the solar at the cor. of secs. 20, 21, 28 and 29.

Thence I run

East on a true line bet. secs. 21 and 28,

Over rolling land, through greasewood brush and scattered palo verde trees.

27.00 Drain, course SW.

37.10 Drain, course SW.

40.00 Set an iron post for  $\frac{1}{4}$  sec. cor. bet. secs. 21 and 28, with brass cap stamped

$\frac{1}{4}$  S 21 in N.  
S 28 1911 in S.

Dig pits  $18 \times 18 \times 12$  ins. E. and W. of post 3 ft. dist.; and raise mound of earth  $3\frac{1}{2}$  ft. base,  $1\frac{1}{2}$  ft. high, N. of cor.

No B.T.'s available.

After diligent search, find no trace of old cor.

45.56 Intersect East bdy. of old Camp McDowell Reservation, at a point from which the  $13\frac{1}{2}$  M. P. hrs. S.  $6^{\circ} 32'$  W., 93 lks. dist.

Set an iron post for C. C. of secs. 21 and 28, with brass cap stamped

C C in W.  
1911 in S.  
T 3 N S 28 in SW. quadrant  
R 7 N S 21 " NW. "  
2 notches on the S. and 4 on the N. edge.

Raise mound of stone 3 ft. base, 2 ft. high, W. of cor.

No B.T.'s available.

Land, rolling.  
Soil, 3rd rate.  
Brush, greasewood. Scattered palo verde trees.

The original C. C. from the E. was destroyed in retracement of E. bdy. of old Camp McDowell Reservation. See Book "A" - Exterior Lines.

## Subdivision T. 3 N., R. 7 E.

## Chains

From the cor. of secs. 20, 21, 28 and 29, I run  
 N. 0° 1' E. bet. secs. 20 and 21,  
 Over rolling land, through greasewood brush and scattered  
 palo verde trees.

14.36 Middle of dry wash, 30 lks. wide, course SW.

40.00 Set an iron post for  $\frac{1}{4}$  sec. cor. bet. secs. 20 and 21,  
 with brass cap stamped

$\frac{1}{4}$  S 20 in W.  
 S 21 " E.  
 1911 " S.

From which -

Palo verde, 6 ins. in diam., brs. S. 84° 30' E., 156  
 lks. dist., mkd.  $\frac{1}{4}$  S 21 B T

No other B.T. available.

Raise mound of stone 2 ft. base,  $1\frac{1}{2}$  ft. high, W. of cor.

From this cor., the old  $\frac{1}{4}$  sec. cor., a stone 18x12x10  
 ins., firmly set, properly mkd. and witnessed, brs. S.  
 61° 30' W., 4.40 chs. dist. I destroy all trace of this  
 old cor.

52.00 Drain, course SW.

58.00 Draw, course SW.

66.00 Drain, course SW.

73.40 Drain, course W.

80.00 Set an iron post for cor. of secs. 16, 17, 20 and 21, with  
 brass cap stamped

T 3 N S 16 in NE. quadrant  
 R 7 E S 21 " SE. "  
 S 20 " SW. "  
 S 17 " NW. "  
 1911 " S.

3 notches on the S. and 4 on the E. edge.

Raise mound of stone 2 ft. base,  $1\frac{1}{2}$  ft. high, W. of cor.

No B.T.'s available.

After diligent search, find no trace of old cor.

Land, rolling.  
 Soil, 3rd rate.  
 Greasewood brush. Scattered palo verde trees.

West on a random line bet. secs. 17 and 20.

40.00 Set temp.  $\frac{1}{4}$  sec. cor.

60.00 Set temp. 1/16 sec. cor. No. 2.

## Subdivision T. 3 N., R. 7 E.

Chains

80.00 Fall 4 lks. S. of cor. of secs. 17, 18, 19 and 20.

Thence I run

S. 89° 56' E. on a true line bet. secs. 17 and 20,

Over level land, through dense mesquite brush, with a few scattered large trees.

9.00 Irrigation ditch, 8 lks. wide, course SE.

20.00 Set an iron post for 1/16 sec. cor. No. 2 bet. secs. 17 and 20, W $\frac{1}{2}$ , with brass cap stampedNo 2 1/16 S 17 in N.  
S 20 1911 in S.

From which -

Mesquite, 18 ins. in diam., brs. S. 48° W., 158 lks. dist., mkd. 1/16 S 20 B T  
Mesquite, 10 ins. in diam., brs. N. 7° 30' W., 108 lks. dist., mkd. 1/16 S 17 B T

28.30 Drain, course SE.

Leave level land; enter rolling land with greasewood brush and scattered palo verde trees, brs. NE. and SW.

40.00 Set an iron post for  $\frac{1}{4}$  sec. cor. bet. secs. 17 and 20, with brass cap stamped $\frac{1}{4}$  S 17 in N.  
S 20 1911 in S.Raise mound of stone 2 ft. base, 1 $\frac{1}{2}$  ft. high, N. of cor.

No B.T.'s available.

From this cor., the old  $\frac{1}{4}$  sec. cor., a stone 18x12x6 ins., witnessed by two B.T.'s, brs S. 62° W., 4.50 chs. dist. I destroy all trace of this old cor. and markings on the B.T.'s.

52.20 Drain course SW.

64.00 Drain, course SW.

80.00 The cor. of secs. 16, 17, 20 and 21.

Land, level and rolling.  
Soil, 2nd and 3rd rate.  
Level land, 28.30 chs. Rolling land, 61.70 chs.  
Brush, greasewood and mesquite.  
Scattered palo verde and mesquite trees.

February 25, 1911: Cloudy at noon; no observation for latitude.

From the 1/16 sec. cor. No. 2 bet. secs. 20 and 29, W $\frac{1}{2}$ ,

I run

Subdivision T. 3 N., R. 7 E.

Chains

N. 0° 1' E. on a random line through middle of W.  $\frac{1}{2}$  of sec. 20.

20.00 Set temp. 1/16 sec. cor. No. 9.

40.00 Set temp. 1/16 sec. cor. No. 8.

60.00 Set temp. 1/16 sec. cor. No. 3.

80.00 Fall 4 lks. W. of 1/16 sec. cor. No. 2 bet. secs. 17 and 20, W $\frac{1}{2}$ .

Thence I run

S. 0° 3' W. on a true line through the middle of the W $\frac{1}{2}$  of sec. 20,

Over rolling land,

Through dense mesquite brush and scattered trees.

6.35 Middle of dry wash, 30 lks. wide, course SW.

14.00 Drain, course SW.

20.00 Set an iron post for 1/16 sec. cor. No. 3 in the center of the NW.  $\frac{1}{4}$  of sec. 20, with brass cap stamped

No 3 in N.  
1/16 S 20 in center  
1911 in S.

From which -

Mesquite, 24 ins. in diam., brs. S. 47° 15' E., 74 lks. dist., mkd. 1/16 S 20 B T  
Mesquite, 18 ins. in diam., brs. N. 20° W., 42 lks. dist., mkd. 1/16 S 20 B T

26.90 Drain, course SW.

32.00 Adobe house brs. West, 2 chs. dist.

32.60 Old irrigation ditch, 10 lks. wide, course SW.

40.00 Set an iron post for 1/16 sec. cor. No. 8 bet. the NW. and SW.  $\frac{1}{4}$ s of sec. 20, with brass cap stamped

No 8 in N.  
1/16 S 20 in center  
1911 in S.

From which -

Mesquite, 12 ins. in diam., brs. S. 27° W., 85 lks. dist., mkd. 1/16 S 20 B T  
Mesquite, 10 ins. in diam., brs. S. 80° 30' W., 50 lks. dist., mkd. 1/16 S 20 B T

42.20 Old irrigation ditch, 10 lks. wide, course SE.

50.00 Leave level land; thence along base of rocky hill brs. N. and S.

Subdivision T. 3 N., R. 7 E.

Chains

60.00 Set an iron post for 1/16 sec. cor. No. 9 in the center of the SW. 1/4 of sec. 20, with brass cap stamped

No 9 in N.  
1/16 S 20 in center  
1911 in S.

From which -

Mesquite, 18 ins. in diam., brs. S. 72° 30' E., 24  
lks. dist., mkd. 1/16 S 20 B T  
Mesquite, 36 ins. in diam., brs. S. 78° 15' W., 42  
lks. dist., mkd. 1/16 S 20 B T

64.00 Leave rolling land; enter level land, brs. NW. and SE.

71.70 Two adobe houses, bear East, 15 lks. dist., and West, 50  
lks. dist.

72.25 Middle of dry wash, 40 lks. wide, course W.

80.00 The 1/16 sec. cor. No. 2 bet. secs. 20 and 29, W 1/2.

Land, level and rolling.  
Soil, 2nd and 3rd rate.  
Brush, mesquite.  
Scattered mesquite and palo verde trees.

From the 1/16 sec. cor. No. 3 in the center of the NW. 1/4  
of sec. 20, I. run

West on a true line through the middle of the NW. 1/4 of  
sec. 20,

Over level land, through dense mesquite brush and scattered  
mesquite and cottonwood trees.

4.50 Old irrigation ditch, 10 lks. wide, course S.

16.90 Left bank of Verde River, course SW.

Set an iron post for M. C. of sec. 20, with brass cap  
stamped

1/16 M C in W.  
1911 in S.  
S 20 in E.

From which -

Cottonwood, 14 ins. in diam., brs. N. 5° 45' W., 106  
lks. dist., mkd. 1/16 S 20 M C B T

No other B. T. available.

Dig a pit 36x36x12 ins. 8 ft. E. of post and raise mound  
of earth 4 ft. base, 2 ft. high, E. of cor.

Bank 10 ft. high.

Subdivision T. 3 N., R. 7 E.

Chains

17.10 ped of river.

Land, level.  
Soil, 2nd rate.  
Brush, mesquite and scattered mesquite and cottonwood trees.

.. February 25, 1911.

February 27, 1911, at 8h., a.m., l.m.t., I set off 33° 36' N. on the latitude arc, 8° 34' S. on the declination arc, and determine a meridian with the solar at the cor. of secs. 16, 17, 20 and 21.

Thence I run

East on a true line bet. secs. 16 and 21,

Over rolling land, through greasewood brush and scattered palo verde trees.

30.45 Draw, drains SW.

38.80 Drain, course SW.

40.00 Set an iron post for  $\frac{1}{4}$  sec. cor. bet. secs. 16 and 21, with brass cap stamped

$\frac{1}{4}$  S 16 in N.  
S 21 1911 in S.

From which -

Palo verde, 6 ins. in diam., brs. S. 13° E., 92 lbs. dist., mkd.  $\frac{1}{4}$  S 21 B T  
palo verde, 8 ins. in diam., brs. N. 61° 45' W., 118 lbs. dist., mkd.  $\frac{1}{4}$  S 16 B T

22. After diligent search, find no trace of old cor.

55.60 Intersect East bdy. of old Camp McDowell Reservation at a point from which the 12 $\frac{1}{2}$  M. P. brs. S. 6° 26' W., 1.18 chs. dist.

Set an iron post for C. C. of secs. 16 and 21, with brass cap stamped

C C in W.  
T 3 N S 21 in SW. quadrant  
R 7 E S 16 " NW. "  
1911 in S.  
3 notches on the S. and 3 on the N. edge.

Raise mound of stone 3 ft. base, 2 ft. high, W. of cor.

No B.T.'s available.

The old C.C. of secs. 16 and 21 was destroyed in retracement of the bdy.

Land, rolling and rocky.

Subdivision T. 3 N., R. 7 E.

Chains

Soil, 4th rate.  
Brush, greasewood.  
Scattered palo verde trees.

From the cor. of secs. 16, 17, 20 and 21, I run  
N. 0° 1' E. bet. secs. 16 and 17,  
Over rolling land,  
Through greasewood brush and scattered palo verde trees.

- 5.20 Drain, course SW.
- 23.65 Drain, course SW.
- 40.00 Set an iron post for  $\frac{1}{4}$  sec. cor. bet. secs. 16 and 17,  
with brass cap stamped

$\frac{1}{4}$  S 17 in W.  
 S 16 " E.  
 1911 " S.

Raise mound of stone 2 ft. base,  $1\frac{1}{2}$  ft. high, W. of cor.  
No B.T.'s available.

From this cor., the old  $\frac{1}{4}$  sec. cor., a stone 12x10x8 ins.  
above ground, witnessed by two B.T.'s badly decayed,  
brs. S. 62° 30' W., 4.50 chs. dist. I destroy all trace  
of this old cor.

- 42.00 Draw, drains SW.
- 51.00 Drain, course SW.
- 61.00 Draw, drains SW.
- 80.00 Set an iron post for cor. of secs. 8, 9, 16 and 17, with  
brass cap stamped

T 3 N S 9 in NE. quadrant  
 R 7 E S 16 " SE. "  
 S 17 " SW. "  
 S 8 " NW. "  
 1911 " S.

4 notches on the S. and 4 on the E. edge.

Raise mound of stone 2 ft. base,  $1\frac{1}{2}$  ft. high, W. of cor.  
No B.T.'s available.

Land, rolling.  
Soil, 4th rate.  
Brush, greasewood.  
Scattered palo verde trees.

After diligent search, find no trace of this cor.

N. 89° 58' W. on a random line bet. secs. 8 and 17.

- 40.00 Set temp.  $\frac{1}{4}$  sec. cor.



## Subdivision T. 3 N., R. 7 E.

Chains

60.00 Set temp. 1/16 sec. cor. No. 2.

80.00 Pull 4 lks. N. of cor. of secs. 7, 8, 17 and 18.

Thence I run

East on a true line bet. secs. 8 and 17,

Over level land,

Through mesquite brush and timber.

12.00 Leave level land and mesquite brush; enter rolling land  
with greasewood brush and scattered palo verde trees,  
brs. NW. and SE.20.00 Set an iron post for 1/16 sec. cor. No. 2 bet. secs. 8 and  
17,  $W\frac{1}{2}$ , with brass cap stampedNo 2 1/16 S 8 in N.  
S 17 1911 in S.Raise mound of stone 2 ft. base,  $1\frac{1}{2}$  ft. high, N. of cor.

No B.T.'s available.

23.00 Draw, drains SW.

36.10 Drain, course SW.

40.00 Set an iron post for  $\frac{1}{4}$  sec. cor. bet. secs. 8 and 17,  
with brass cap stamped $\frac{1}{4}$  S 8 in N.  
S 17 1911 in S.Raise mound of stone 2 ft. base,  $1\frac{1}{2}$  ft. high, N. of cor.

No B.T.'s available,

After diligent search, find no trace of old cor.

45.00 Drain, course S.

58.00 Drain, course SE.

74.00 Drain, course SW.

80.00 The cor. of secs. 8, 9, 16 and 17.

Land, level and rolling.  
Soil, 2nd and 4th rate.  
Greasewood and mesquite brush.  
Scattered palo verde trees.February 27, 1911, at the 1/16 sec. cor. No. 2, bet. secs.  
17 and 20,  $W\frac{1}{2}$ , I set off  $8^{\circ} 31'$  S. on the declination  
arc, and at 12h. 13m., p.m., l.m.t., observe the sun  
on the meridian; the resulting latitude is  $33^{\circ} 36'$  N.,  
which is within  $1'$  of the correct latitude.

Thence I run

N.  $0^{\circ} 1'$  E. on a random line through the middle of the  $W\frac{1}{2}$

## Subdivision T. 3 N., R. 7 E.

## Chains

of sec. 17.

20.00 Set temp. 1/16 sec. cor. No. 9.

40.00 Set temp. 1/16 sec. cor. No. 8.

60.00 Set temp. 1/16 sec. cor. No. 3.

80.00 Fall 2 lks. W. of 1/16 sec. cor. No. 2 bet. secs. 8 and 17,  
W.  $\frac{1}{4}$ .

Thence I run

S. 0° 2' W. on a true line through middle of the W.  $\frac{1}{4}$  of  
sec. 17,

Over rolling land, through greasewood brush and scattered  
palo verde tress.

3.90 Draw, drains SW.

8.50 Drain, course SW.

20.00 Set an iron post for 1/16 sec. cor. No. 3 in the center of  
the NW.  $\frac{1}{4}$  of sec. 17, with brass cap stamped

No 3 in N.  
1/16 S 17 in center  
1911 in S.

Raise mound of stone 2 ft. base, 1 $\frac{1}{2}$  ft. high, W. of cor.

No B.T.'s available.

20.50 Leave rolling land; enter level land, brs. N. 30° W. and  
S. 30' E.

31.50 Drain, course SW.

32.00 Leave level land; enter rolling land, brs. N. 30° E. and  
S. 30° W.

40.00 Set an iron post for 1/16 sec. cor. No. 8 bet. the NW. and  
SW.  $\frac{1}{4}$ s of sec. 17, with brass cap stamped

No 8 in N.  
1/16 S 17 in center  
1911 in S.

Raise mound of stone 2 ft. base, 1 $\frac{1}{2}$  ft. high, W. of cor.

No B.T.'s available.

60.00 Set an iron post for 1/16 sec. cor. No. 9 in the center of  
the SW.  $\frac{1}{4}$  of sec. 17, with brass cap stamped

No 9 in N.  
1/16 S 17 in center  
1911 in S.

## Subdivision T. 3 N., R. 7 E.

## Chains

Raise mound of stone 2 ft. base,  $1\frac{1}{2}$  ft. high, W. of cor.  
No B.T.'s available.

68.00 Leave rolling land; enter level land covered with dense  
mesquite, brs. N.  $30^{\circ}$  W. and S.  $30^{\circ}$  E.

80.00 The  $1/16$  sec. cor. No. 2 bet. secs. 17 and 20, W  $\frac{1}{2}$ .

Land, rolling and level.  
Soil, 2nd and 6th rate.  
Brush, greasewood, mesquite, and scattered palo verde.

From the cor. of secs. 8, 9, 16 and 17, I run  
East on a true line bet. secs. 9 and 16,  
Over rolling land, through greasewood brush and scattered  
palo verde trees.

19.00 Drain, course SW.

24.00 Drain, course S.

38.00 Drain, course SW.

40.00 set an iron post for  $\frac{1}{4}$  sec. cor. bet. secs. 9 and 16, with  
brass cap stamped

$\frac{1}{4}$  S 9 in N.  
S 16 1911 in S.

Raise mound of stone 2 ft. base,  $1\frac{1}{2}$  ft. high, N. of cor.  
No B.T.'s available.

After diligent search, find no trace of old cor.

44.00 Drain, course SW.

64.80 Intersect East bdy. of old Camp McDowell Reservation, at a  
point from which the  $11\frac{1}{2}$  M. P. brs. S.  $6^{\circ} 40'$  W., 1.40  
chs. dist.

Set an iron post for C. C. of secs. 9 and 16, with brass  
cap stamped

C C in W.  
1911 in S.  
T 3 N S 16 in SW. quadrant  
R 7 E S 9 " NW. "  
4 notches on the S. and 2 on the N. edge.

Raise mound of stone 3 ft. base, 2 ft. high, W. of cor.

No trees available large enough for B.T.'s.

Old C.C. destroyed in retracement of bdy.

Land, rolling.

Subdivision T. 3 N., R. 7 E.

Chains

Soil, 4th rate.  
Greasewood brush.  
Scattered palo verde trees.

- February 27, 1911.

February 28, 1911, at 8h., a.m., l.m.t., I set off 33° 37' N. on the latitude arc, 8° 11' S. on the declination arc, and determine a meridian with the solar at the cor. of secs. 8, 9, 16 and 17.

Thence I run

N. 0° 1' N. bet. secs. 8 and 9,

Over rolling land, through greasewood brush and scattered palo verde trees.

9.00 Drain, course W.

28.00 Drain, course SW.

33.60 Dry wash, 30 lks. wide, course W.

40.00 get an iron post for  $\frac{1}{4}$  sec. cor. bet. secs. 8 and 9, with brass cap stamped

$\frac{1}{4}$  S 8 in W.  
S 9 " E.  
1911 " S.

Raise mound of stone 2 ft. base, 1 $\frac{1}{2}$  ft. high, W. of cor.

No B.T.'s available.

After diligent search, find no trace of old cor.

45.80 Drain, course SW.

61.00 Drain, course SW.

80.00 Set an iron post for cor. of secs. 4, 5, 8 and 9, with brass cap stamped

T 3 N S 4 in NE. quadrant  
R 7 E S 9 " SE. "  
S 8 " SW. "  
S 5 " NW. "  
1911 " S.

5 notches on the S. and 4 on the E. edge.

From which -

Palo verde, 8 ins. in diam., brs. S. 70° 45' E., 185 lks. dist., mkd. T 3 N R 7 E S 9 B T

Palo verde, 6 ins. in diam., brs. S. 52° 15' W., 143 lks. dist., mkd. T 3 N R 7 E S 8 B T

Palo verde, 8 ins. in diam., brs. N. 26° 15' W., 274 lks. dist., mkd. T 3 N R 7 E S 5 B T

No tree available for NE. B.T.

Raise mound of stone 2 ft. base, 1 $\frac{1}{2}$  ft. high, W. of cor.

## Subdivision T. 3 N., R. 7 E.

## Chains

After diligent search, find no trace of old cor.

Land, rolling and rocky.

Soil, 4th rate.

Greasewood brush and scattered palo verde trees.

West on a random line bet. secs. 5 and 8.

20.00 Set temp. 1/16 sec. cor. No. 1.

40.00 get temp. 1/4 sec. cor.

60.00 Set temp. 1/16 sec. cor. No. 2.

80.08 Intersect temp. cor. of secs. 5, 6, 7 and 8, on sand bar  
in Verde River.

Thence I run

East on a true line bet. secs. 5 and 8,

On sand bar, within meanders of Verde River.

5.14 Left bank of Verde River, course SW.

get an iron post for M. C. of secs. 5 and 8, with brass  
cap stamped

M C in W.  
1911 in S.  
T 3 N S 5 in NE. quadrant  
R 7 E S 8 " SE. "  
5 notches in S.

Raise mound of stone 2 ft. base, 1 1/2 ft. high, E. of cor.

No B.T.'s available.

Ascend steep rocky hill, hrs. N. 25° E. and S. 25° W.

11.50 Top of ascent of steep hill, hrs. NE. and SW.

Thence over rolling land, through greasewood brush and  
scattered palo verde trees and cactus.

20.02 Set an iron post for 1/16 sec. cor. No. 2 bet. secs. 5 and  
8, W 1/4, with brass cap stamped

No 2 1/16 S 5 in N.  
S 8 1911 in S.

Raise mound of stone 2 ft. base, 1 1/2 ft. high, N. of cor.

No B.T.'s available.

40.04 Set an iron post for 1/4 sec. cor. bet. secs. 5 and 8, with  
brass cap stamped

1/4 S 5 in N.  
S 8 1911 in S.

Subdivision T. 3 N., R. 7 E.

Chains

Dig pits 18x18x12 ins. E. and W. of post 3 ft. dist.; and raise mound of earth 3 1/2 ft. base, 1 1/2 ft. high, N. of cor.

No B.T.'s available.

46.13 Road brs. NE. and SW.

60.06 Set an iron post for 1/16 sec. cor. No. 1 bet. secs. 5 and 8, E 1/4, with brass cap stamped

No 1 1/16 S 5 in N.  
S 8 1911 in S.

From which -

Palo verde, 8 ins. in diam., brs. N. 54° 50' E., 147 lks. dist., mkd. 1/16 S 5 B T  
Palo verde, 10 ins. in diam., brs. S. 75° 15' E., 155 lks. dist., mkd. 1/16 S 8 B T

80.08 The cor. of secs. 4, 5, 8 and 9.

Land, rolling and rocky.  
Soil, 4th rate.  
Greasewood brush. Scattered pale verde trees and cactus.

February 28, 1911: Cloudy at noon; no observation for latitude.

-----  
East on a true line bet. secs. 4 and 9,

Over rolling, rocky land, through greasewood brush, scattered pale verde trees, and cactus.

20.00 get an iron post for 1/16 sec. cor. No. 2 bet. secs. 4 and 9, W 1/4, with brass cap stamped

No 2 1/16 S 4 in N.  
S 9 1911 in S.

From which -

pale verde, 6 ins. in diam., brs. S. 77° 30' E., 115 lks. dist., mkd. 1/16 S 9 B T  
Palo verde, 8 ins. in diam., brs. N. 77° 30' W., 115 lks. dist., mkd. 1/16 S 4 B T

34.00 Drain, course SW.

40.00 Set an iron post for 1/4 sec. cor. bet. secs. 4 and 9, with brass cap stamped

1/4 S 4 in N.  
S 9 1911 in S.

From which -

Palo verde, 8 ins. in diam., brs. N. 20° 30' E., 107 lks. dist., mkd. 1/4 S 4 B T  
Palo verde, 10 ins. in diam., brs. S. 70° 15' W., 211 lks. dist., mkd. 1/4 S 9 B T

## Subdivision T. 3 N., R. 7 E.

## Chains

60.00 set an iron post for 1/16 sec. cor. No. 1 bet. secs. 4 and 9, with brass cap stamped

No 1 1/16 S 4 in N.  
S 9 1911 in S.

Raise mound of stone 2 ft. base, 1 1/2 ft. high, N. of cor.

No B.T.'s available.

74.46 Intersect East bdy. of old Camp McDowell Reservation, at a point from which the 10 1/2 N. P. brs. S. 6° 45' W., 1.80 chs. dist.

Set an iron post for C. C. of secs. 4 and 9, with brass cap stamped

C C in W.  
1911 in S.  
T 3 N S 9 in SW. quadrant  
R 7 E S 4 " NW. "  
5 notches on the S. and 1 on the N. edge.

Raise mound of stone 3 ft. base, 2 ft. high, W. of cor.

No B.T.'s available.

Land, rolling and rocky.

Soil, 4th rate.

Greasewood brush.

Scattered paleverde trees and cactus.

Old C.C. of secs. 4 and 9 destroyed in retracement of bdy. line.

- February 28, 1911.

March 1, 1911, at 8h., a.m., l.m.t., I set off 33° 38' N. on the latitude arc, 7° 49' S. on the declination arc, and determine a meridian with the solar at the cor. of secs. 4, 5, 8 and 9,

Thence I run

N. 0° 1' E. on a random line bet. secs. 4 and 5.

20.00 Set temp. 1/16 sec. cor. No. 12.

40.00 Set temp. 1/4 sec. cor.

60.00 Set temp. 1/16 sec. cor. No. 6.

79.88 Fall 18 lks. E. of cor. of secs. 4, 5, 32 and 33, on the N. bdy. of the tp., previously described.

Thence I run

S. 0° 7' E. on a true line bet. secs. 4 and 5,

Over rocky land, through greasewood brush, scattered pale

Subdivision T. 3 N., R. 7 E.

Chains

verde trees,

Descending slope, brs. N. 80° N. and S. 80° W.

5.08 Right bank of Sycamore Wash, course SW.

Set an iron post for M. C. of secs. 4 and 5, with brass cap stamped

M C 1911 in S.  
T 3 N S 4 in NE. quadrant  
R 7 E S 5 " NW. "  
4 notches on the E. edge.

From which -

Mesquite, 14 ins. in diam., brs. N. 27° 45' E , 170 lks. dist., mkd. T 3 N R 7 E S 4 M C B T  
Mesquite, 20<sup>5</sup> ins. in diam., brs. S. 45° W., 9 lks. dist., mkd. T 3 N R 7 E S 5 M C B T

Descend 8 ft. to foot of descent and bed of Sycamore Wash, course SW.

7.20 Middle of Sycamore Wash, course SW. Dry at time of survey.

9.33 Left bank of Sycamore Wash, course SW.

Set an iron post for M. C. of secs. 4 and 5, with brass cap stamped

M C in N.  
1911 in S.  
T 3 N S 5 in SW. quadrant  
R 7 E S 4 " SE. "  
4 notches on the E. edge.

Raise mound of stone 2 ft. base,  $\frac{1}{2}$  ft. high, S. of cor. No B.T.'s available.

Thence over level land, through sage brush and scattered mesquite trees.

19.88 Set an iron post for 1/16 sec. cor. No. 6 bet. secs. 4 and 5,  $\frac{1}{2}$ , with brass cap stamped

No 6 in N.  
1/16 S 5 in W.  
S 4 " E.  
1911 " S.

From which -

Mesquite, 10 ins. in diam., brs. N. 59° 30' E., 82 lks. dist., mkd. 1/16 S 4 B T  
Mesquite, 10 ins. in diam., brs. N. 70° 30' W., 99 lks. dist., mkd. 1/16 S 5 B T

38.03 Road brs. E. and W.

39.88 Set an iron post for  $\frac{1}{4}$  sec. cor. bet. secs. 4 and 5, with brass cap stamped



## Subdivision T. 3 N., R. 7 E.

## Chains

$\frac{1}{4}$  S 5 in W.  
 S 4 " E.  
 1911 " S.

From which -

Palo verde, 12 ins. in diam., brs. S. 78° 30' E., 60  
 lks. dist., mkd.  $\frac{1}{4}$  S 4 B T

Palo verde, 10 ins. in diam., brs. N. 78° 30' W., 199  
 lks. dist., mkd.  $\frac{1}{4}$  S 5 B T

After diligent search, find no trace of old cor.

Leave level land; enter rolling, rocky land, covered with  
 greasewood brush and scattered palo verde trees.

Begin ascent, brs. N. 70° E. and S. 70° W.

43.40 Top of ascent, brs. NE and SW.

59.88 Set an iron post for 1/16 sec. cor. No. 12 bet. secs. 4 and  
 5, S $\frac{1}{2}$ , with brass cap stamped

No 12 in N.  
 1/16 S 5 in W.  
 S 4 " E  
 1911 " S.

Dig pits 18x18x12 ins. N. and S. of post 3 ft. dist.; and  
 raise mound of earth 3 $\frac{1}{2}$  ft. base, 1 $\frac{1}{2}$  ft. high, W. of cor.

No B.T.'s available.

79.88 The cor. of secs. 4, 5, 8 and 9.

Land, rolling and level.  
 Soil, 2nd and 3rd rate.  
 Brush, greasewood and sage.

From the 1/16 sec. cor. No. 12 bet. secs. 4 and 5, S $\frac{1}{2}$ .

I run

West on a true line through S.  $\frac{1}{2}$  of sec. 5,

Over rolling land, through greasewood brush and scattered  
 palo verde trees.

18.65 Road brs. N. 15° E. and S. 20° W.

20.00 Set an iron post for 1/16 sec. cor. No. 11 in the center  
 of the SE.  $\frac{1}{4}$  of sec. 5, with brass cap stamped

No 11 in N.  
 1/16 S 5 in center  
 1911 in S.

From which -

Palo verde, 8 ins. in diam., brs. N. 18° 45' E., 123  
 lks. dist., mkd. 1/16 S 5 B T

Palo verde, 8 ins. in diam., brs. S. 27° W., 107 lks.  
 dist., mkd. 1/16 S 5 B T

## Subdivision T. 3 N., R. 7 E.

## Chains

- 40.00 Set an iron post for 1/16 sec. cor. No. 10 bet. the SE. and SW.  $\frac{1}{4}$ s of sec. 5, with brass cap stamped
- No 10 in N.  
1/16 S 5 in center  
1911 in S.
- Raise mound of stone 2 ft. base,  $1\frac{1}{2}$  ft. high, N. of cor.
- No B.T.'s available.
- 50.00 Begin steep descent, brs. N. 30° E. and S. 30° W.
- 52.40 Foot of steep descent.
- Leave rolling land; enter level land, with dense growth of mesquite timber, brs. N. 30° E. and S. 30° W.
- 58.65 Left bank of verde River, course SW.
- Set an iron post for M. C. of sec. 5, with brass cap stamped
- 1/16 M C in W.  
1911 in S.  
S 5 in E.
- From which -
- Mesquite, 20 ins. in diam., brs. N. 83° E., 35 lks.  
dist., mkd. T 1/16 S 5 M C B T
- Mesquite, 10 ins. in diam., brs. S. 47° E., 77 lks.  
dist., mkd. T 1/16 S 5 M C B T
- Descend 8 ft. bank to bed of Verde River.
- Land, rolling and level.  
Soil, 2nd and 4th rate.  
Brush, greasewood and mesquite.  
Scattered pale verde and mesquite trees.
- 
- From the 1/16 sec. cor. No. 2 bet. secs. 5 and 8,  $W\frac{1}{2}$ .
- I run
- N. 0° 7' W. on a true line, through the middle of the SW.  $\frac{1}{4}$  of sec. 5,
- Over rolling, rocky land, through greasewood brush and scattered pale verde trees.
- 8.00 Begin steep descent, brs. N. 45° E. and S. 45° W.
- 10.65 Foot of steep descent; leave rolling land; enter level land, covered with dense growth of mesquite trees, brs. N. 45° E. and S. 45° W.
- 11.45 Left bank of Verde River, course SW.

Subdivision T. 3 N., R. 7 E.

Chains

Set an iron post for M. C. of sec. 5, with brass cap stamped

1/16 M C in N.  
1911 in S.  
S 5 in S.

Raise mound of stone 2 ft. base, 1 1/2 ft. high, S. of cor.

No B.T.'s available.

Bank, 8 ft. high.

11.65 Bed of river, course SW.

Land, rolling and level.  
Soil, 2nd and 4th rate.  
Brush, greasewood and mesquite.  
Scattered palo verde.

From the 1/4 sec. cor. bet. secs. 4 and 5, I run West on a true line through middle of sec. 5, Over level land, through sage brush and scattered mesquite trees.

13.80 Road brs. N. 60° E. and S. 60° W.

20.00 Set an iron post for 1/16 sec. cor. No. 7 bet. the NE. and SE. 1/4s of sec. 5, with brass cap stamped

No 7 in N.  
1/16 S 5 in center  
1911 in S.

Raise mound of stone 2 ft. base, 1 1/2 ft. high, N. of cor.

No B.T.'s available.

38.90 Drain, course SW.

Leave mesquite brush; enter cottonwood timber, brs. NE. and SW.

40.00 Set an iron post for C. 1/4 sec. cor. of sec. 5, with brass cap stamped

C 1/4 S 5 in center  
1911 in S.

From which -

- Cottonwood, 12 ins. in diam., brs. N. 28° 30' E., 19 lks. dist., mkd. C 1/4 S 5 B T
- Cottonwood, 8 ins. in diam., brs. S. 18° E., 20 lks. dist., mkd. C 1/4 S 5 B T
- Cottonwood, 10 ins. in diam., brs. S. 43° W., 13 lks. dist., mkd. C 1/4 S 5 B T
- Willow, 12 ins. in diam., brs. N. 65° W., 41 lks. dist., mkd. C 1/4 S 5 B T

## Subdivision T. 3 N., R. 7 E.

## Chains

45.15 Left bank of Sycamore Wash, course SW.

Set an iron post for M. C. of sec. 5, with brass cap  
stamped

1/16 M C in W.  
1911 in S.  
S 5 in E.

From which -

Cottonwood, 12 ins. in diam., brs. N. 61° 15' E., 81  
lks. dist., mkd. 1/16 S 5 M C B T  
Cottonwood, 14 ins. in diam., brs. S. 38° 30' W., 87  
lks. dist., mkd. 1/16 S 5 M C B T

Leave timber, brs. NE. and SW.

Thence across Sycamore Wash, course SW., dry at time of  
survey.

48.50 East bank of small low island, in Sycamore Wash,

Set an iron post for M. C. of sec. 5, with brass cap  
stamped

M C in E.  
1911 in S.  
1/16 S 5 in W.

Raise mound of stone 2 ft. base, 1½ ft. high, W. of cor.

No B.T.'s available.

Thence through sage brush.

60.00 Set an iron post for 1/16 sec. cor. No. 8 bet. the NW. and  
SW. ¼s of sec. 5, with brass cap stamped

No 8 in N.  
1/16 S 5 in center  
1911 in S.

Dig pits 18x18x12 ins. E. and W. of post 3 ft. dist.; and  
raise mound of earth 3½ ft. base, 1½ ft. high, N. of cor.

No B.T.'s available.

64.77 West shore of small island in mouth of Sycamore Wash.

Set an iron post for M. C. of sec. 5, with brass cap  
stamped

1/16 M C in W.  
1911 in S.  
S 5 in E.

Raise mound of stone 2 ft. base, 1½ ft. high, E. of cor.

No B.T.'s available.

Bank 8 ft. high.

## Subdivision T. 3 N., R. 7 E.

## Chains

64.97 East edge of bed of Verde River, course SE.

Land, level.

Soil, 2nd rate.

Brush, sage and greasewood.

Timber, cottonwood, mesquite, and willow.

March 1, 1911, at the 1/16 sec. cor. No. 8 bet. the NW. and SW.  $\frac{1}{4}$ s of sec. 5, on island, I set off  $7^{\circ} 46'$  S. on the declination arc, and at 12h. 13m., p.m., l.m.t., observe the sun on the meridian; the resulting latitude is  $33^{\circ} 39'$  N., which is within 1' of the correct latitude.

Thence I run

S.  $0^{\circ} 7'$  E. on a true line through middle of SW.  $\frac{1}{4}$  of sec.

5,

Over level land,

Through sage brush, over small island in Sycamore Wash.

6.10 South shore of island, and left bank of Verde River.

Set an iron post for M. C. of sec. 5, with brass cap

stamped

M C 1911 in S.

1/16 S 5 in N.

Dig a pit 36x36x12 ins. 8 ft. N. of post and raise mound of earth 4 ft. base, 2 ft. high, N. of cor.

Bank 4 ft. high.

Land, level.

Soil, 2nd rate.

Brush, sage and mesquite.

From the 1/16 sec. cor. No. 6 bet. secs. 4 and 5, N $\frac{1}{2}$ , I run

West on a true line through N.  $\frac{1}{2}$  of sec. 5,

Over level land, through sage brush and scattered mes-

quite trees.

12.80 Left bank of Sycamore Wash, course SW.

Set an iron post for M. C. of sec. 5, with brass cap

stamped

1/16 M C in W.

1911 in S.

S 5 in E.

Raise mound of stone 2 ft. base, 1 $\frac{1}{2}$  ft. high, E. of cor.

No B.T.'s available.

Leave brush; thence over dry and rocky bed of Sycamore

Wash.

## Subdivision T. 3 N., R. 7 E.

## Chains

20.00 Point for 1/16 sec. cor. No. 5 in the center of the NE.  $\frac{1}{4}$  of sec. 5, falls in Sycamore Wash.

Set temp. cor.

40.00 Point for 1/16 sec. cor. No. 4 bet. the NE. and NW.  $\frac{1}{4}$ s of sec. 5, falls in Sycamore Wash.

Set temp. cor.

60.00 Right bank of Sycamore Wash, course S. 80° W.

Set an iron post for 1/16 sec. cor. No. 3 in the center of the NW.  $\frac{1}{4}$  of sec. 5, and also M. C., with brass cap stamped

No 3 in N.  
1/16 M C S 5 in W.  
1911 in S.

From which -

Mesquite, 24 ins. in diam., brs. N. 50° 50' E., 90  
lks. dist., mkd. 1/16 S 5 M C B T  
Mesquite, 24 ins. in diam., brs. N. 62° 30' W., 55  
lks. dist., mkd. 1/16 S 5 M C B T

Thence over level land, through dense mesquite brush and scattered trees.

68.35 Left bank of Verde River, course SE.

Set an iron post for M. C. of sec. 5, with brass cap stamped

1/16 M C in W.  
1911 in S.  
S 5 in E.

From which -

Mesquite, 12 ins. in diam., brs. N. 70° E., 44 lks.  
dist., mkd. 1/16 S 5 M C B T  
Mesquite, 30 ins. in diam., brs. S. 46° 45' E., 7  
lks. dist., mkd. 1/16 S 5 M C B T

Bank 8 ft. high.

Thence across sand bar.

71.35 Edge of water.

Land, level. 21.15 chs. Sycamore wash, 47.20 chs.  
Soil, 2nd rate.  
Brush, sage and mesquite.  
Scattered mesquite trees.

From the 1/16 sec. cor. No. 7 bet. the NE. and SE.  $\frac{1}{4}$ s of sec. 5, I run

Subdivision T. 3 N., R. 7 E.

Chains

N. 0° 7' W. on a true line through middle of NE. 1/4 of sec. 5,

Over level land, through greasewood and sage brush, with scattered mesquite and cottonwood trees.

9.50 Drain, course SW.

Scattered cottonwood trees along drain.

15.00 Left bank of Sycamore Wash, course SW.

Set an iron post for M. C. of sec. 5, with brass cap stamped

1/16 M C in N.  
S 5 1911 in S.

Raise mound of stone 2 ft. base, 1 1/2 ft. high, S. of cor.  
No B.T.'s available.

Land, level.  
Soil, 2nd rate.  
Sage brush and mesquite.  
Scattered cottonwood and mesquite trees.

From the C. 1/4 sec. cor. of sec. 5, I run  
N. 0° 7' W. on a true line through middle of NE 1/4 of sec. 5.  
Over level land, through cottonwood timber.

2.00 Leave cottonwood timber, brs. NE. and SW.

Enter sage brush and scattered mesquite trees.

6.75 Left bank of Sycamore Wash, course SW.

set a n iron post for M. C. of sec. 5, with brass cap stamped

1/16 M C in N.  
S 5 1911 in S.

From which -

Mesquite, 14 ins. in diam., brs. S. 77° E., 68 lks.  
dist., mkd. 1/16 S 5 M C B T  
Mesquite, 14 ins. in diam., brs. S. 4° 30' W., 155  
lks. dist., mkd. 1/16 S 5 M C B T

Raise mound of stone 2 ft. base, 1 1/2 ft. high, S. of cor.  
Bank 3 ft. high.

6.85 Bed of Sycamore Wash, course SW.

Land, level.  
Soil, 2nd rate.  
Sage brush.  
Timber, cottonwood and mesquite.

Subdivision T. 3 N., R. 7 E.

Chains

From the 1/16 sec. cor. No. 8 bet. the NW. and SW.  $\frac{1}{4}$ s of sec. 5, on low island in Sycamore Wash, I run N. 0° 7' W. on a random line through middle of NW.  $\frac{1}{4}$  of sec. 5.

20.00 Intersect 1/16 sec. cor. No. 3, which is also M. C., in the center of the NW.  $\frac{1}{4}$  of sec. 5.

Thence I run

S. 0° 7' E. on a true line through middle of NW.  $\frac{1}{4}$  of sec. 5,

Across course of Sycamore Wash, course SW.

6.26 Northshore of small low island, in Sycamore wash.

Set an iron post for M. C. of sec. 5, with brass cap stamped

M C 1911 in S.  
1/16 S 5 in N.

Dig a pit 36x36x12 ins. 8 ft. N. of post and raise mound of earth 4 ft. base, 2 ft. high, N. of cor.

No B.T.'s available.

Thence over level ground, through sage brush.

20.00 The 1/16 sec. cor. No. 8, bet. the NW. and SW.  $\frac{1}{4}$ s of sec. 5, on low island in Sycamore wash.

Land, level.  
Soil, 2nd rate.  
Sage brush.

From the 1/16 sec. cor. No. 1 bet. secs. 5 and 32, N.  $\frac{1}{4}$  on the N. bdy. of the tp., previously described, I run S. 0° 7' E. on a true line through middle of NE.  $\frac{1}{4}$  of sec. 5,

Over rolling rocky land, through greasewood brush and scattered palo verde trees.

5.80 Leave rolling land, brs. E. and W.

Enter level land, with scattered mesquite trees.

7.50 Draw, drains SE.

11.41 Right bank of Sycamore Wash, course SW.

Set an iron post for M. C. of sec. 5, with brass cap stamped



Subdivision T. 3 N., R. 7 E.

Chains

M C 1911 in S.  
1/16 S 5 in N.

From which -

Mesquite, 36 ins. in diam., brs. N. 42° E., 62 lks.  
dist., mkd. 1/16 S 5 M C B T

Mesquite, 20 ins. in diam., brs. N. 9° 30' W., 60 lks.  
dist., mkd. 1/16 S 5 M C B T

Bank 8 ft. high.

11.61 Bed of wash, course SW.

Land, rolling and level.

Soil, 2nd and 4th rate.

Brush, greasewood.

Scattered palo verde and mesquite trees.

From the 1/4 sec. cor. bet. secs. 5 and 32, on the N. bdy.

of the tp., previously described, I run

S. 0° 7' E. on a true line through middle of the N. 1/2 of  
sec. 5,

Over rolling land, through greasewood brush and scattered  
palo verde trees.

11.00 Leave rolling land, brs. E. and W.

Enter level land, with mesquite brush and trees.

15.12 Right bank of Sycamore Wash, course SW.

Set an iron post for M. C. of sec. 5, with brass cap  
stamped

M C 1911 in S.  
1/16 S 5 " N.

From which -

Mesquite, 10 ins in diam., brs. N. 26° 30' E., 99  
lks. dist., mkd. 1/16 S 5 M C B T

Catelaw, 24 ins. in diam., brs. N. 45° W., 32 lks.  
dist., mkd. 1/16 S 5 M C B T

Bank, 8 ft. high.

15.32 Bed of Sycamore Wash, course SW.

Land, rolling and level.

Soil, 2nd and 4th rate.

Brush, greasewood and mesquite.

Scattered palo verde and mesquite trees.

From the cor. of secs. 3, 4, 33 and 34, on the N. bdy. of  
the tp., previously described,

I run

Subdivision T. 3 N., R. 7 E.

Chains

S. 0° 2' W. on a true line bet. secs. 3 and 4,  
Over rolling, rocky land,  
Through greasewood brush and scattered palo verde trees.

2.65 Middle of dry wash, 30 lks. wide, course NW.

19.88 Set an iron post for 1/16 sec. cor. No. 6 bet. secs. 3 and 4, N $\frac{1}{2}$ , with brass cap stamped

No 6 in N.  
1/16 S 4 in W.  
S 3 " E.  
1911 " S.

Raise mound of stone 2 ft. base, 1 $\frac{1}{2}$  ft. high, W. of cor.  
No B.T.'s available.

33.13 Intersect East bdy. of the old Camp McDowell Reservation,  
at a point from which the 10 M. P. brs. S. 6° 50' W.,  
8.87 chs. dist.

Set an iron post for C. C. of secs. 3 and 4, with brass cap stamped

C C in N.  
1911 in S.  
T 3 N S 3 in NE. quadrant  
R 7 E S 4 " NW. "  
3 notches on the E. and 3 on the W. edge.

Raise mound of stone 3 ft. base, 2 ft. high, N. of cor.  
No B.T.'s available.

Land, rolling and rocky.  
Soil, 4th rate.  
Brush, greasewood, with scattered palo verde trees.

- March 1, 1911.

---

March 2, 1911, at 8h., a.m., 1.m.t., I set off 33° 38' N. on the latitude arc, 7° 26' S. on the declination arc, and determine a meridian with the solar at the 1/16 sec. cor. No. 12, bet. secs. 4 and 5, S $\frac{1}{4}$ .

Thence I run

East on a true line through the S.  $\frac{1}{4}$  of sec. 4,

Over rolling land, through greasewood brush and scattered palo verde trees.

20.00 get an iron post for 1/16 sec. cor. No. 9 in the center of the SW.  $\frac{1}{4}$  of sec. 4, with brass cap stamped

Subdivision T. 3 N., R. 7 E.

Chains

No 9 in N.  
1/16 S 4 in center  
1911 in S.

Raise mound of stone 2 ft. base, 1 1/2 ft. high, North of cor.

No B.T.'s available.

40.00 Set an iron post for 1/16 sec. cor. No. 10 bet. the SE. and SW. 1/4 of sec. 4, with brass cap stamped

No 10 in N.  
1/16 S 4 in center  
1911 in S.

Raise mound of stone 2 ft. base, 1 1/2 ft. high, North of cor.

No B.T.'s available.

60.00 set an iron post for 1/16 sec. cor. No. 11 in the center of the SE. 1/4 of sec. 4, with brass cap stamped

No 11 in N.  
1/16 S 4 in center  
1911 in S.

Raise mound of stone 2 ft. base, 1 1/2 ft. high, North of cor.

No B.T.'s available.

76.83 Intersect East bdy. of the old Camp McDowell Reservation, at a point from which the 10 1/2 M. P. brs. S. 6° 45' W., 21.94 chs. dist.

Set an iron post for C. C. of sec. 4, with brass cap stamped

T 3 N R 7 E S 4 C C in W.  
1911 in S.

Raise mound of stone 3 ft. base, 2 ft. high, W. of cor.

No B. T.'s available.

Land, rolling and rocky.  
Soil, 4th rate.  
Brush, greasewood.  
Scattered palo verde trees and cactus.

From the 1/4 sec. cor. bet. secs. 4 and 5, I run

Subdivision T. 3 N., R. 7 E.

Chains

East on a true line through middle of sec. 4,  
Over rolling, rocky land,  
Through greasewood brush and very scattered palo verde  
trees.

20.00 get an iron post for 1/16 sec. cor. No. 8 bet. the NW.  
and SE.  $\frac{1}{8}$ s of sec. 4, with brass cap stamped

No 8 in N.  
1/16 S 4 in center  
1911 in S.

Raise mound of stone 2 ft. base, 1  $\frac{1}{2}$  ft. high, N. of cor.  
No B.T.'s available.

40.00 get an iron post for C.  $\frac{1}{4}$  sec. cor. of sec. 4, with brass  
cap stamped

C  $\frac{1}{4}$  S 4 in center  
1911 in S.

Raise mound of stone 2 ft. base, 1  $\frac{1}{2}$  ft. high, N. of cor.  
No B.T.'s available.

51.00 Dry wash, 20 lks. wide, course NW.

57.70 Dry wash, 30 lks. wide, course NW.

60.00 get an iron post for 1/16 sec. cor. No. 7 bet. the NE. and  
SE.  $\frac{1}{8}$ s of sec. 4, with brass cap stamped

No 7 in N.  
1/16 S 4 in center  
1911 in S.

Raise mound of stone 2 ft. base, 1  $\frac{1}{2}$  ft. high, N. of cor.  
No B.T.'s available.

79.20 Intersect East bdy. of old Camp McDowell Reservation, at a  
point from which the 10 M. P. hrs. S. 6° 50' W., 1.95  
chs. dist.

Set an iron post for C. C. of sec. 4, with brass cap  
stamped

T 3 N R 7 E S 4 C C in W.  
1911 in S.

Raise mound of stone 3 ft. base, 2 ft. high, W. of cor.  
No B.T.'s available.

Land, rolling and rocky.  
Soil, 4th rate.  
Brush, greasewood, with scattered palo verde trees.

## Subdivision T. 3 N., R. 7 E.

## Chains

March 2, 1911, at the 1/16 sec. cor. No. 6 bet. secs. 3 and 4, N $\frac{1}{2}$ , I set off 7° 23' S. on the declination arc, and at 12h. 12m. 30s., p.m., l.m.t., observe the sun on the meridian; the resulting latitude is 33° 39' N., which is within 1' of the correct latitude.

Thence I run

West on a random line through the N.  $\frac{1}{2}$  of sec. 4.

20.00 Set temp. 1/16 sec. cor. No. 5.

40.00 Set temp. 1/16 sec. cor. No. 4.

60.00 Set temp. 1/16 sec. cor. No. 3.

80.00 Intersect 1/16 sec. cor. No. 6 bet. secs. 4 and 5, N $\frac{1}{2}$ .

Thence I run

East on a true line through the N.  $\frac{1}{2}$  of sec. 4,

Over level land, through sage brush and scattered mesquite trees.

20.00 Set an iron post for 1/16 sec. cor. No. 3 in the center of the NW.  $\frac{1}{4}$  of sec. 4, with brass cap stamped

No 3 in N.  
1/16 S 4 in center  
1911 in S.

From which -

Mesquite, 8 ins. in diam., brs. S. 39° 15' W., 34 lks. dist., mkd. 1/16 S 4 B T  
Mesquite, 12 ins. in diam., brs. N. 31° W., 58 lks. dist., mkd. 1/16 S 4 B T

34.00 Dry wash, 40 lks. wide, course NW.

35.00 Leave level land; enter rolling, rocky land, with grease-wood brush and scattered palo verde trees, brs. NE. and SW.

36.00 Road brs. NE. and SW.

40.00 Set an iron post for 1/16 sec. cor. No. 4 bet. the NE. and NW.  $\frac{1}{8}$ s of sec. 4, with brass cap stamped

No 4 in N.  
1/16 S 4 in center  
1911 in S.

From which -

Palo verde, 6 ins. in diam., brs. S. 16° 45' E., 105 lks. dist., mkd. 1/16 S 4 B T  
Palo verde, 8 ins. in diam., brs. N. 66° 45' W., 80 lks. dist., mkd. 1/16 S 4 B T

54.00 Drain, course NW.

Subdivision T. 3 N., R. 7 E.

Chains

60.00 Set an iron post for 1/16 sec. cor. No. 5 in the center of the NE. 1/4 of sec. 4, with brass cap stamped

No 5 in N.  
1/16 S 4 in center  
1911 in S.

From which-

Palo verde, 8 ins. in diam., brs. N. 52° 30' E., 164 lks. dist., mkd. 1/16 S 4 B T  
Palo verde, 8 ins. in diam., brs. S. 47° E., 50 lks. dist., mkd. 1/16 S 4 B T

80.00 The 1/16 sec. cor. No. 6 bet. secs. 3 and 4, NE 1/4.

Land, level and rolling.  
Soil, 2nd and 4th rate.  
Brush, greasewood.  
Scattered palo verde and mesquite trees.

From the 1/16 sec. cor. No. 4 bet. the NE. and NW. 1/4s of sec. 4, I run

N. 0° 3' W. on a true line through the middle of the N. 1/4 of sec. 4,

Over rolling, rocky land,

Through greasewood brush and scattered palo verde trees.

2.00 begin descent, brs. NE. and SW.

4.20 Foot of descent. brs. NE. and SW.

Enter level land, with greasewood and scattered mesquite trees.

5.85 Read brs. N. 30° E. and S. 30° W.

14.00 Left bank of Sycamore Wash, course SW.

Set an iron post for M. C. of sec. 4, with brass cap stamped

1/16 M C in N. S 4 1911 in S.

From which -

Mesquite, 8 ins. in diam., brs. S. 29° E., 66 lks. dist., mkd. 1/16 S 4 M C B T  
Mesquite, 14 ins. in diam., brs. S. 64° 15' W., 118 lks. dist., mkd. 1/16 S 4 M C B T

Bank 7 ft. high.

14.20 Bed of Sycamore Wash, course SW.

Land, level and rolling.

## Subdivision T. 3 N., R. 7 E.

Chains

Soil, 2nd and 4th rate.  
Brush, greasewood.  
Scattered mesquite and palo verde.

From the 1/16 sec. cor. No. 3 in the center of the NW.  $\frac{1}{4}$   
of sec. 4, I run  
N. 0° 5' W. on a true line through middle of the NW.  $\frac{1}{4}$  of  
sec. 4,

Over level land,

Through sage brush, with scattered mesquite trees.

9.80 Left bank of Sycamore Wash, course NW.

Set an iron post for M. C. of sec. 4, with brass cap  
stamped

1/16 M C in N.  
S 4 1911 in S.

From which -

Catclaw, 15 ins. in diam., brs. S. 41° 30' E., 68 lks.  
dist., mkd. 1/16 S 4 M C B T  
Mesquite, 20 ins. in diam., brs. S. 70° 30' E., 40  
lks. dist., mkd. 1/16 S 4 M C B T

Bank 8 ft. high.

10.00 Bed of Sycamore Wash, dry at time of survey.

Land, level.  
Soil, 2nd rate.  
Brush, sage; and scattered mesquite trees.

From the 1/16 sec. cor. No. 6 bet. secs. 3 and 4, N  $\frac{1}{2}$ ,

I run

East on a true line through N.  $\frac{1}{2}$  of sec. 3,

Over rolling land, through greasewood brush, and scattered  
palo verde trees.

1.62 Intersect East bdy. of old Camp McDowell Reservation, at  
a point from which the 10 M.P. brs. S. 6- 50' W., 22.10  
chs. dist.

Set an iron post for C. C. of sec. 3, with brass cap  
stamped

T 3 N R 7 E S 3 C C in W.  
1911 in S.

Raise mound of stone 3 ft. base, 2 ft. high, W. of cor.

Subdivision T. 3 N., R. 7 E.

Obains

No B.T.'s available.

Land, rolling and rocky.

Soil, 4th rate.

Brush, greasewood.

Scattered palo verde trees.

- March 2, 1911.

---



Meanders of the right bank of Verde River, up stream.

March 3, 1911, at 8h., a.m., l.m.t., I set off 33° 33' N. on the latitude arc, 7° 3' S. on the declination arc, and determine a meridian with the solar at the N. C. bet. secs. 5 and 32, which is 1.46 chs. East of the cor. of secs. 5, 6, 31 and 32, on the S. bdy. of T. 3 N., R. 7 E., both of which corners have been previously described.

Thence I run with meanders in sec. 32,

Over level land,

Through dense willow brush.

N. 23° 30' W. 3.66 chs. to M. C. of secs. 31 and 32, which is 3.36 chs. N. 0° 1' E. of cor. of secs. 5, 6, 31 and 32 on the S. bdy. of tp., previously described.

Land, level.  
Soil, 2nd rate.  
Brush, willow.

-----  
Thence in sec. 31,

Over level land,

Through dense willow brush.

N. 23° 30' W. 13.15 chs. Set iron post for angle point with brass cap stamped A P

N. 32° 30' W. 13.60 " Set iron post for angle point with brass cap stamped A P

N. 42° 30' W. 14.00 " set iron post for angle point with brass cap stamped A P

At 2.00 chs., leave willows; enter rocky land.

N. 34° 15' W. 14.30 " Set iron post for angle point with brass cap stamped A P

N. 7° E., 4.70 " Set iron post for angle point with brass cap stamped A P

At end of this course, leave rocky land; enter level land.

N. 42° 30' E. 22.60 " Set iron post for angle point with brass cap stamped A P

N. 10° 30' E. 9.80 " to M. C. of secs. 30 and 31, which is 7.59 chs. East of 1/16 sec. cor. No. 1 bet. secs. 30 and 31, E<sub>1</sub>.

Land, level and rocky.  
Soil, 2nd and 4th rate.  
Brush, willow, greasewood and mesquite.  
Scattered cottonwood trees along river bank.  
-----

Meanders T. 3 N., R. 7 E.

Thence in sec. 30,

Over level land,

Through sage brush, scattered mesquite and cottonwood trees.

N. 25° 23' W. 17.71 chs. to M. C. of sec. 30, which is 16 chs. North of 1/16 sec. cor. No. 1 bet. secs. 30 and 31, E 1/4.

N. 27° 55' W. 4.52 " to M. C. of sec. 30, which is 17.88 chs. East of 1/16 sec. cor. No. 10 bet. the SE. and SW. 1/4s of sec. 30.

At 50 lks., mouth of drain, course East.

Leave level land; begin ascent of rocky bluff bank, 20 ft. high.

N. 9° 15' E. 13.17 " to M. C. of sec. 30, which is 7.00 chs. South of 1/16 sec. cor. No. 7 bet. the NE. and SE. 1/4s of sec. 30.

At 50 lks., leave high bank; enter level land, with dense growth of cottonwood timber, brs. NW. and SE.

N. 14° 30' E. 7.23 " to M. C. of sec. 30, which is 1.82 chs. East of 1/16 sec. cor. No. 7 bet. the NE. and SE. 1/4s of sec. 30. At 2.00 chs., mouth of old slough, brs. SW. and NE.

N. 1° 39' E. 20.01 " to M. C. of sec. 30, which is 2.40 chs. N. 89° 58' E. of 1/16 sec. cor. No. 5 in the center of the NE. 1/4 of sec. 30.

N. 6° E. 9.50 " Set iron post for angle point with brass cap stamped A P

N. 7° W. 6.60 " Set iron post for angle point with brass cap stamped A P

N. 47° 40' W. 3.50 " to M. C. of sec. 30, which is 18.40 chs. North of 1/16 sec. cor. No. 5 in the center of the NE. 1/4 of sec. 30.

N. 50° W. 2.48 " to M. C. bet. secs. 19 and 30 which is 18.10 chs. East of the 1/4 sec. cor. bet. secs. 19 and 30.

Land, level.  
Soil, 2nd rate.  
Brush, willow and greasewood.  
Timber, mesquite and cottonwood.

-----  
Thence in sec. 19,

Over level land,

Through cottonwood timber.

## Meanders T. 3 N., R. 7 E.

- N. 21° 18' W. 21.45 chs. to M. C. of sec. 19, which is 10.30 chs. N. 89° 58' E. from 1/16 sec. cor. No. 10 bet. the SE. and SW.  $\frac{1}{4}$ s of sec. 19. At 4.00 chs., mouth of slough, 150 lks. wide, brs. SW.
- N. 8° 57' W. 20.25 " to M. C. of sec. 19, which is 7.15 chs. East of the C.  $\frac{1}{4}$  sec. cor. of sec. 19. At 16.00 chs., leave cottonwood timber, brs. SW. Thence through sage brush.
- N. 3° 40' W. 20.04 " to M. C. of sec. 19, which is 5.85 chs. N. 89° 58' E. of 1/16 sec. cor. No. 4 bet. the NE. and NW.  $\frac{1}{4}$ s of sec. 19.
- N. 11° 45' W. 15.20 " Set iron post for angle point with brass cap stamped A P
- N. 22° 32' W. 5.60 " to M. C. bet. secs. 18 and 19, which is 61 lks. N. 89° 58' E. of the  $\frac{1}{4}$  sec. cor. bet. secs. 18 and 19. At 4.00 chs., irrigation ditch, 10 lks. wide, course S.
- Land, level and sandy.  
Soil, 2nd rate.  
Sage brush.  
Cottonwood and mesquite brush.
- 
- Thence in sec. 18,  
Over level land,  
Through mesquite brush and scattered trees.
- N. 25° 0' W. 1.49 chs. to M. C. of sec. 18, which is 1.35 chs. North of  $\frac{1}{4}$  sec. cor. bet. secs. 18 and 19.
- N. 27° 15' W. 6.70 " Set iron post for angle point with brass cap stamped A P
- N. 19° W. 3.70 " set iron post for angle point with brass cap stamped A P
- N. 28° W. 6.50 " Set iron post for angle point with brass cap stamped A P
- N. 46° W. 5.03 " to M. C. of sec. 18 which is 9.10 chs. N. 89° 57' E. of 1/16 sec. cor. No. 9 in the center of the SW.  $\frac{1}{4}$  of sec. 18.
- N. 34° W. 9.30 " Set iron post for angle point with brass cap stamped A P
- N. 27° 15' W. 8.45 " to M. C. of sec. 18 which is 15.25 chs. North of 1/16 sec. cor. No. 9 in the center of the SW.  $\frac{1}{4}$  of sec. 18.
- N. 9° 30' W. 4.82 " to M. C. of sec. 18 which is 19.20

## Meanders T. 3 N., R. 7 E.

chs. N.  $89^{\circ} 56'$  E. of  $\frac{1}{4}$  sec. cor.  
bet. secs. 13 and 18, on W. bdy.  
of tp., previously described.

N.  $2^{\circ} 0'$  W. 20.01 chs. to M. C. of sec. 18, which is  
18.50 chs. N.  $89^{\circ} 58'$  E. of  $1/16$   
sec. cor. No. 6 bet. secs. 13  
and 18,  $N\frac{1}{4}$ , on the W. bdy. of  
the tp., previously described.

N.  $3^{\circ} 15'$  W. 20.03 " Along bank 25 ft. high.  
to M. C. bet. secs. 7 and 18,  
which is 17.35 chs. N.  $89^{\circ} 56'$   
E. of cor. of secs. 7, 12, 13  
and 18, on the W. bdy. of the  
tp., previously described.

Land, level and rolling.

Soil, 2nd rate.

Brush, mesquite, with scattered mesquite and cottonwood  
trees.

March 3, 1911: Cloudy at noon; no observation for lati-  
tude.

March 4, 1911, at 8h., a.m., l.m.t., I set off  $33^{\circ} 37'$  N.  
on the latitude arc,  $6^{\circ} 40'$  S. on the declination arc,  
and determine a meridian with the solar at the M. C. bet.  
secs. 7 and 18, which is 17.35 chs. N.  $89^{\circ} 56'$  E. of the  
cor. of secs. 7, 12, 13 and 18, on the W. bdy. of the  
tp., previously described.

Thence I run with meanders in sec. 7,

Over level land,

Through dense mesquite brush and scattered cottonwood  
trees.

N.  $44^{\circ} 15'$  E. 3.80 chs. to M. C. of sec. 7, which is 17.28  
chs. South of  $1/16$  sec. cor. No.  
9 in the center of the SW.  $\frac{1}{4}$  of  
sec. 7.  
At 2.00 chs., middle of dry wash,  
100 lks. wide, course SE.

N.  $23^{\circ}$  E. 18.78 " to M. C. of sec. 7, which is 7.35  
chs. N.  $89^{\circ} 55'$  E. from the  $1/16$   
sec. cor. No. 9 in the center of  
the SW.  $\frac{1}{4}$  of sec. 7.  
At 14.50 chs., road bra. E. and W.

N.  $17^{\circ}$  E. 8.30 " Set iron post for angle point  
with brass cap stamped A P

N.  $31^{\circ} 15'$  E. 14.16 " to M. C. of sec. 7, which is 17.10  
chs. N.  $89^{\circ} 55'$  E. of  $1/16$  sec.  
cor. No. 8 bet. the NW. and SW.  
 $\frac{1}{4}$ s of sec. 7.

N.  $33^{\circ} 30'$  E. 5.26 " to M. C. of sec. 7, which is 15.62  
Chs. South of  $1/16$  sec. cor. No.  
4 bet. the NE. and NW.  $\frac{1}{4}$ s of sec.  
7.  
At 4.26 chs., road bra. SE. and NW.

Meanders F. 3 N., R. 7 E.

- N. 40° 30' E. 6.90 chs. Set iron post for angle point with brass cap stamped A P
- N. 54° 30' E. 8.90 " Set iron post for angle point with brass cap stamped A P
- N. 42° E. 7.00 " to M. C. of sec. 7, which is 16.40 chs. N. 89° 55' E. of 1/16 sec. cor. No. 4 bet. the NE. and NW. 1/4s of sec. 7.
- N. 28° 15' E. 7.60 " to M. C. of sec. 7, which is 13.30 chs. South of 1/16 sec. cor. No. 1 bet. secs. 6 and 7, E 1/4.
- N. 25° 30' E. 14.74 " to M. C. bet. secs. 6 and 7, which is 6.34 chs. N. 89° 58' E. of 1/16 sec. cor. No. 1 bet. secs. 6 and 7, E 1/4.

Land, level.  
 Soil, 2nd rate.  
 Brush, greasewood, sage, and mesquite.  
 Scattered cottonwood, willow, and mesquite trees.

March 4, 1911, at M. C. of secs. 6 and 7, which is 6.34 chs. N. 89° 58' E. of 1/16 sec. cor. No. 1 bet. secs. 6 and 7, E 1/4, I set off 6° 37' S. on the declination arc, and at 12h. 12m., p.m., l.m.t., observe the sun on the meridian; the resulting latitude is 33° 38', which is within 1' of the correct latitude.

Thence I run with meanders in sec. 6,

Over level land,

Through sage brush and scattered mesquite and cottonwood trees.

- N. 24° 45' E. 22.00 chs. to M. C. of sec. 6, which is 15.63 chs. East of 1/16 sec. cor. No. 11 in the center of the SE. 1/4 of sec. 6.
- N. 28° 30' E. 3.10 " set iron post for angle point with brass cap stamped A P
- N. 11° 30' E. 9.50 " Set iron post for angle point with brass cap stamped A P
- N. 9° 30' W. 8.10 " to M. C. of sec. 6, which is 17.66 chs. East of 1/16 sec. cor. No. 7 bet. the NE. and SE. 1/4s of sec. 6.
- N. 4° 30' W. 4.00 " Set iron post for angle point with brass cap stamped A P
- N. 20° W. 4.40 " Set iron post for angle point with brass cap stamped A P
- N. 16° 45' W. 12.40 " to M. C. of sec. 6, which is 12.25 chs. East of 1/16 sec. cor. No. 5 in the center of the NE. 1/4 of sec. 6.
- N. 34° 45' W. 4.00 " Set iron post for angle point with brass cap stamped A P  
At 1 ch/, road brs. NE. and SW.

## Meanders T. 3 N , R. 7 E.

- N. 43° 0' W. 9.80 chs. Set iron post for angle point with brass cap stamped A P
- N. 68° W. 3.55 " to M. C. of sec. 6, which is 11.80 chs. North of 1/16 sec. cor. No. 5 in the center of the NE.  $\frac{1}{4}$  of sec. 6. At 1.00 ch., windmill and artesian well, bear West, 30 lks. dist.
- N. 52° 15' W. 7.70 " get iron post for angle point, with brass cap stamped A P
- N. 31° 30' W. 4.10 " to M. C. of secs. 6 and 31, which is 11.80 chs. East of the  $\frac{1}{4}$  sec. corner bet. secs. 6 and 31, on the N. bdy. of the tp., both cors. previously described.

Land, level.  
Soil, 2nd rate.  
Brush, sage and mesquite.  
Scattered mesquite and cottonwood trees.

- March 4, 1911.

March 6, 1911. -

Meanders of left bank of Verde River, up stream:

March 6, 1911, at 8h., a.m., l.m.t., I set off 33° 33' N. on the latitude arc, 5° 54' S. on the declination arc, and determine a meridian with the solar at the M. C. bet. secs. 5 and 32, which is 65.67 chs. West of the cor. of secs. 4, 5, 32 and 33, on the S. bdy. of T. 3 N., R. 7 E., both cors. previously described.

Thence I run with meanders in sec. 32,

Along 20 ft. bank,

Over rocky land.

- N. 24° 30' W. 14.23 chs. Set iron post for angle point with brass cap stamped A P
- N. 36° W. 9.30 " Set iron post for angle point with brass cap stamped A P
- N. 64° 20' W. 3.30 " to M. C. bet. secs. 31 and 32, which is 21.90 chs. N. 0° 1' E. of the cor. of secs. 5, 6, 31 and 32, on the S. bdy. of the tp., previously described. At 2.00 chs., leave rocky land and 20-ft. bank; enter level land with greasewood brush and mesquite trees.

Land, level and rolling.  
Soil, 2nd and 4th rate.  
Brush, greasewood, scattered palo verde, and cactus.

Thence in sec. 31,

Meanders T. 3 N., R. 7 E.

Over level land,

Through dense mesquite and willow brush, with scattered cottonwood trees.

- N. 32° 45' W. 12.20 chs. Set iron post for angle point with brass cap stamped A P
- N. 11° E. 8.40 " Set iron post for angle point with brass cap stamped A P
- N. 7° 30' E. 10.20 " Set iron post for angle point with brass cap stamped A P
- N. 15° 45' E. 8.90 " Set iron post for angle point with brass cap stamped A P
- N. 3° W. 9.50 " Set iron post for angle point with brass cap stamped A P
- N. 51° 40' E. 2.25 " to M. C. of secs. 31 and 32, which is 30.00 chs. N. 0° 1' E. of the  $\frac{1}{4}$  sec. cor. bet. secs. 31 and 32.

Land, level.  
 Soil, 2nd rate.  
 Brush, greasewood and willow.  
 Scattered cottonwood and mesquite trees.

Thence in sec. 32,

Over level land,

Through brush.

- N. 34° 15' E. 6.31 chs. Set iron post for angle point with brass cap stamped A P
- N. 20° 30' E. 5.10 " to M. C. of secs. 29 and 32, which is 14.65 chs. West of  $\frac{1}{16}$  sec. cor. No. 2 bet. secs. 29 and 32,  $W\frac{1}{2}$ .

Land, level.  
 Soil, 2nd rate.  
 Brush, mesquite.  
 Scattered cottonwood trees.

Thence in sec. 29,

Over level land,

Through dense mesquite brush, with scattered cottonwood trees.

- N. 29° 15' E. 11.47 chs. Set iron post for angle point with brass cap stamped A P
- N. 10° E. 8.00 " Set iron post for angle point with brass cap stamped A P
- N. 32° 30' E. 2.50 " to M. C. of sec. 29, which is

## Meanders T. 3 N., R. 7 E.

6.30 chs. West of the 1/16 sec. cor. No. 9 in the center of the SW.  $\frac{1}{4}$  of sec. 29.

N. 32° 30' W. 3.00 chs. Set iron post for angle point with brass cap stamped A P

N. 8° 15' W. 8.40 " Set iron post for angle point with brass cap stamped A P

N. 14° 33' W. 9.45 " to M. C. of sec. 29, which is 11.49 chs. West of 1/16 sec. cor. No. 8 bet. the NW. and SW.  $\frac{1}{4}$ s of sec. 29.

N. 25° 30' W. 10.70 " Set iron post for angle point with brass cap stamped A P

N. 3° 52' W. 10.36 " to M. C. of sec. 29, which is 16.80 chs. West of 1/16 sec. cor. No. 3 in the center of the NW.  $\frac{1}{4}$  of sec. 29.

N. 3° 50' W. 20.05 " to M. C. of secs. 20 and 29, which is 18.14 chs. West of 1/16 sec. cor. No. 2 bet. secs. 20 and 29, W $\frac{1}{4}$ .

Land, level.

Soil, 2nd rate.

Brush, greasewood and mesquite.

Scattered mesquite and cottonwood trees.

Thence in sec. 20,

Over level land,

Through dense mesquite brush.

N. 15° 15' W. 7.15 chs. to M. C. of secs. 19 and 20, which is 13.10 chs. S. 0° 1' W. of 1/16 sec. cor. No. 12 bet. secs. 19 and 20, S $\frac{1}{4}$ .

At 6.50 chs., mouth of dry wash, 60 lks. wide, course SW.

Land, level.

Soil, 2nd rate.

Brush, greasewood.

Scattered cottonwood and mesquite trees.

March 6, 1911: Cloudy at noon; no observation for latitude.

Thence in sec. 19,

Over level land,

Through mesquite brush and cottonwood trees.

N. 14° 15' W. 13.50 chs. to M. C. of sec. 19, which is 3.31 chs. S. 89° 58' W. of 1/16 sec. cor. No. 12 bet. secs. 19 and 20, S $\frac{1}{4}$ .



## Meanders T. 3 N., R. 7 E.

- N. 4° 0' E. 5.32 chs. Set iron post for angle point  
with brass cap stamped A P
- N. 7° 45' W. 9.00 " Set iron post for angle point  
with brass cap stamped A P
- N. 19° E. 6.10 " to M. C. of sec. 19, which is 2.10  
chs. West of  $\frac{1}{4}$  sec. cor. bet.  
secs. 19 and 20.
- N. 17° 15' E. 7.02 " to M. C. of secs. 19 and 20,  
which is 6.70 chs. N. 0° 1' E.  
of  $\frac{1}{4}$  sec. cor. bet. secs. 19  
and 20.

Land, level.  
Soil, 2nd rate.  
Timber, mesquite and cottonwood.

Thence in sec. 20,

Over level land,

Through dense mesquite brush.

- N. 22° 45' E. 8.00 chs. Set iron post for angle point  
with brass cap stamped A P
- North 5.90 " to M. C. of sec. 20, which is  
16.90 chs. West of  $\frac{1}{16}$  sec. cor.  
No. 3 in the center of the NW.  
 $\frac{1}{4}$  of sec. 20.
- N. 9° 30' W. 3.56 " Set iron post for angle point  
with brass cap stamped A P
- N. 28° 15' W. 5.30 " to M. C. of secs. 19 and 20,  
which is 11.83 chs. S. 0° 1' W.  
of the cor. of secs. 17, 18, 19  
and 20.

Land, level.  
Soil, 2nd rate.  
Brush, mesquite and scattered cottonwood trees.

Thence in sec. 19,

Over level land,

Through mesquite brush and trees.

- N. 45° 0' W. 16.70 chs. to M. C. of secs. 18 and 19,  
which is 11.80 chs. S. 89° 58' W.  
of the cor. of secs. 17, 18, 19  
and 20.

Land, level.  
Soil, 2nd rate.  
Mesquite brush and trees.

- March 6, 1911.

March

## Meanders T. 3 N., R. 7 E.

March 7, 1911, at 8h., a.m., l.m.t., I set off  $33^{\circ} 36'$  N. on the latitude arc,  $5^{\circ} 31'$  S. on the declination arc, and determine a meridian with the solar at the M. C. of secs. 18 and 19, which is 11.80 chs. S.  $89^{\circ} 58'$  W. of the cor. of secs. 17, 18, 19 and 20.

Thence I run with meanders in sec. 18,

Over level land,

Through mesquite brush and trees.

N.  $54^{\circ} 45'$  W. 10.04 chs. to M. C. of sec. 18, which is 14.20 chs. South of  $1/16$  sec. cor. No. 11 in the center of the SE.  $\frac{1}{4}$  of sec. 18.

N.  $49^{\circ} 45'$  W. 8.00 " Set iron post for angle point with brass cap stamped A P

N.  $24^{\circ}$  W. 9.90 " to M. C. of sec. 18, which is 10.12 chs. S.  $89^{\circ} 57'$  W. of  $1/16$  sec. cor. No. 11 in the center of the SE.  $\frac{1}{4}$  of sec. 18.

N.  $20'$  W. 7.60 " Set iron post for angle point with brass cap stamped A P

N.  $26^{\circ} 45'$  W. 6.80 " Set iron post for angle point with brass cap stamped A P

N.  $30^{\circ} 45'$  E. 7.90 " to M. C. of sec. 18 which is 11.68 chs. S.  $89^{\circ} 56'$  W. of  $1/16$  sec. cor. No. 7 bet. the NE. and SE.  $\frac{1}{8}$  of sec. 18.

N.  $30^{\circ} 30'$  E. 7.80 " Set iron post for angle point with brass cap stamped A P

N.  $12^{\circ} 30'$  E. 8.90 " Set iron post for angle point with brass cap stamped A P

N.  $10^{\circ} 15'$  E. 4.70 " to M. C. of sec. 18 which is 5.00 chs. S.  $89^{\circ} 58'$  W. of  $1/16$  sec. cor. No. 5 in the center of the NE.  $\frac{1}{4}$  of sec. 18.

North 11.95 " Set iron post for angle point with brass cap stamped A P

N.  $22^{\circ} 45'$  W. 8.70 " to M. C. of secs. 7 and 18, which is 8.39 chs. S.  $89^{\circ} 56'$  W. of  $1/16$  sec. cor. No. 1 bet. secs. 7 and 18,  $3\frac{1}{2}$ .

Land, level.

Soil, 2nd rate.

Brush, sage and mesquite.

Scattered mesquite and cottonwood trees.

Thence in sec. 7,

Over level, sandy land,

Through dense mesquite brush, with scattered mesquite and cottonwood trees.

## Meanders T. 3 N., R. 7 E.

- N. 26° 35' W. 17.35 chs. Set iron post for angle point with brass cap stamped A P
- N. 12° 15' E. 4.60 " to M. C. of sec. 7, which is 15.14 chs. S. 89° 55' W. of the 1/16 sec. cor. No. 11 in the center of the SE.  $\frac{1}{4}$  of sec. 7. At 60 lks., road, brs. E. and W.
- N. 34° 35' E. 24.30 " to M. C. of sec. 7, which is 1.35 chs. S. 89° 55' W. of 1/16 sec. cor. No. 7 bet. the NE. and SE.  $\frac{1}{4}$ s of sec. 7.
- N. 35° 24' E. 2.33 " to M. C. of sec. 7 which is 1.90 chs. North of 1/16 sec. cor. No. 7 bet. the NE. and SE.  $\frac{1}{4}$ s of sec. 7.
- N. 28° 45' E. 20.66 " to M. C. of sec. 7 which is 10.09 chs. S. 89° 55' W. of 1/16 sec. cor. No. 6 bet. secs. 7 and 8, N $\frac{1}{4}$
- N. 28° E. 3.30 " Set iron post for angle point with brass cap stamped A P
- N. 26° 5' E. 10.00 " get an iron post for angle point with brass cap stamped A P
- N. 41° 45' E. 6.17 " to M. C. of secs. 7 and 8, which is 16.50 chs. N. 0° 1' E. of 1/16 sec. cor. No. 6 bet. secs. 7 and 8, N $\frac{1}{4}$ .  
Last course along base of 40-ft. bluff, brs. NE. and SW.

Land, level and rolling.  
Soil, 2nd and 4th rate.  
Brush, sage and mesquite.  
Scattered willow, cottonwood and mesquite trees.

-----

Thence in sec. 8,

Along base of 40-ft. bluff, brs. NE. and SW.,

Through mesquite, greasewood and scattered pale verde trees.

N. 65° 20' E. 6.15 chs. to M. C. of secs. 5 and 8, which is 14.88 chs. West of 1/16 sec. cor. No. 2 bet. secs. 5 and 8, W $\frac{1}{4}$ .

Land, rolling.  
Soil, 4th rate.  
Brush, greasewood.  
Scattered pale verde trees.

March 7, 1911, at this M. C., I set off 5° 28' S. on the declination arc, and at 12h. 11m. 30s., p.m., observe the sun on the meridian; the resulting latitude is 33° 38' N., which is within 1' of the correct latitude.

-----

Thence In sec. 5,

Over rolling land,

## Meanders T. 3 N., R. 7 E.

Through greasewood brush and scattered palo verde trees.

N. 52° 40' E. 18.80 chs. to M. C. of sec. 5, which is 11.40 chs. N. 0° 7' W. of 1/16 sec. cor. No. 2 bet. secs. 5 and 8, N $\frac{1}{2}$ .  
At 10.00 chs., leave bluff, brs. NE. and SW. Enter level land, with dense growth of mesquite and cottonwood trees.

N. 8° 55' E. 8.71 " to M. C. of sec. 5, which is 18.65 chs. West of 1/16 sec. cor. No. 10 bet. the SE. and SW.  $\frac{1}{4}$ s of sec. 5.

N. 8° 45' W. 8.85 " Set an iron point for angle point with brass cap stamped A P  
This point is junction of left bank of Sycamore Wash with left bank of Verde River.

Thence with meanders of left bank of Sycamore Wash, up stream.

In sec. 5.

N. 64° 30' E. 12.00 chs. Set an iron post for angle point with brass cap stamped A P

N. 33° 30' E. 7.30 " to M. C. of sec. 5 which is 5.15 chs. West of C.  $\frac{1}{2}$  sec. cor. of sec. 5.  
At 1.00 ch., mouth of drain, course W.

N. 37° 20' E. 8.49 " to M. C. of sec. 5 which is 6.75 chs. N. 0° 7' W. of C.  $\frac{1}{4}$  sec. cor. of sec. 5.

N. 67° 35' E. 21.63 " to M. C. of sec. 5, which is 15.00 chs. N. 0° 7' W. of 1/16 sec. cor. No. 7 bet. the NE. and SE.  $\frac{1}{4}$ s of sec. 5.

N. 55° 5' E. 8.73 " to M. C. of sec. 5, which is 12.80 chs. West of 1/16 sec. cor. No. 6 bet. secs. 4 and 5, N $\frac{1}{2}$ .

N. 50° 30' E. 15.58 " to M. C. of secs. 4 and 5, which is 10.55 chs. N. 0° 7' W. of 1/16 sec. cor. No. 6 bet. secs. 4 and 5, N $\frac{1}{2}$ .

Land, level.

Soil, 2nd rate.

Brush, mesquite and sage.

Willow, cottonwood, and mesquite trees.

Thence in sec. 4,

Over level land,

Through sage and mesquite brush, with a few scattered trees.

Meanders T. 3 N., R. 7 E.

S. 87° 51' E. 20.02 chs. to M. C. of sec. 4, which is 9.80 chs. N. 0° 5' W. of 1/16 sec. cor. No. 3 in the center of the NW. 1/4 of sec. 4.

East 8.40 " Set an iron post for angle point with brass cap stamped A P

N. 61° 15' E. 6.10 " Set an iron post for angle point with brass cap stamped A P

N. 78° 45' E. 6.41 " to M. C. of sec. 4, which is 14.00 chs. N. 0° 3' W. of 1/16 sec. cor. No. 4 bet. the NE. and NW. 1/4s of sec. 4.

N. 57° 15' E. 10.90 " to M. C. of secs. 4 and 33, ~~SW~~ which is 10.80 chs. West of the 1/16 sec. cor. No. 1 bet. secs. 4 and 33, E 1/4, on the N. bdy. of the tp., both cors. previously described.  
At 8.00 chs., road brs. N. and S.  
At 9.50 chs., road brs. N. and S.

Land, level.  
Soil, 2nd rate.  
Brush, mesquite and sage.  
Scattered mesquitetrees.

- March 7, 1911.

-----  
March 8, 1911, at 8h., a.m., l.m.t., I set off 33° 39' N. on the latitude arc, 5° 8' S. on the declination arc, and determine a meridian with the solar at the M. C. of secs. 4 and 33, which is 11.40 chs. East of the cor. of secs. 4, 5, 32 and 33, on the N. bdy. of the tp., both cors. previously described.

Thence I run with meanders of the right bank of Sycamore Wash, down stream,

In sec. 4,  
Over rolling land,  
Through greasewood brush and scattered palo verde trees,  
Along 30- ft. bank.

S. 66° W. 12.48 chs. to M. C. of secs. 4 and 5, which is 5.08 chs. S. 0° 7' E. of cor. of secs. 4, 5, 32 and 33.

Land, rolling.  
Soil, 3rd rate.  
Brush, greasewood.  
Scattered palo verde trees.

-----  
Thence in sec. 5,  
Over rolling land,  
Through greasewood and scattered mesquite brush.

Meanders, T. 3 N., R. 7 E.

S. 72° 26' W. 20.98 chs. to M. C. of sec. 5, which is 11.41 chs. S. 0° 7' E. of the 1/16 sec. cor. No. 1 bet. secs. 5 and 32, on the N. bdy. of the tp., previously described.

S. 79° 30' W. 20.34 " to M. C. of sec. 5, which is 15.12 chs. S. 0° 7' E. of the 1/16 sec. cor. bet. secs. 5 and 32, on the N. bdy. of the tp., previously described.

At 8.00 chs., leave rolling land, brs. NW. and SE. Thence over level land, through dense mesquite.

S. 76° 17' W. 20.54 " to M. C. of sec. 5, which is also 1/16 sec. cor. No. 3 in the center of the NW. 1/4 of sec. 5.

S. 82° 30' W. 1.50 " Set an iron post for angle point with brass cap stamped A P

N. 88° 45' W. 6.86 " to M. C. of sec. 5, which is 8.35 chs. West of 1/16 sec. cor. No. 3 in the center of the NW. 1/4 of sec. 5.

This M. C. is at the junction of the right bank of Sycamore Wash with the left bank of Verde River.

Thence with meanders of the left bank of verde River.

up stream.

In sec. 5.

N. 18° 40' W. 21.11 chs. to M. C. of secs. 5 and 32, which is 15.10 chs. West of 1/16 sec. cor. No. 2 bet. secs. 5 and 32, W 1/2, on the N. bdy. of the tp., both cors. previously described. At 18.00 chs., road brs. NE. and SW.

Land, level.  
Soil, 2nd rate.  
Brush, mesquite.

- March 8, 1911.

Meanders of Island in Sycamore Wash, in sec. 5:

March 9, 1911, at 8h., a.m., l.m.t., I set off 33° 38' N. on the latitude arc, 4° 44' S. on the declination arc, and determine a meridian with the solar at the M. C. of sec. 5, which is 11.50 chs. East of 1/16 sec. cor. No. 8 bet. the NW. and SW. 1/4s of sec. 5. This M. C. is on the East shore of low island in Sycamore wash, in sec. 5, T. 3 N., R. 7 E.

Thence I run with meanders in sec. 5,

Along low bank,

Through sage brush.

S. 28° 0' W.	5.70	chs.	Set an iron post for angle point with brass cap stamped A P
S. 59° 15' W.	3.50	"	get an iron post for angle point with brass cap stamped A P
N. 83° W.	5.86	"	to M. C. of sec. 5, which is 6.10 chs. S. 0° 7' E. of 1/16 sec. cor. No. 8 bet. the NW. and SW. $\frac{1}{4}$ s of sec. 5.
N. 69° 30' W.	2.00	"	get an iron post for angle point with brass cap stamped A P
N. 28° 15' W.	6.12	"	to M. C. of sec. 5, which is 4.77 chs. West of 1/16 sec. cor. No. 8 bet. the NW. and SW. $\frac{1}{4}$ s of sec. 5.
N. 25° 45' W.	5.20	"	Set an iron post for angle point with brass cap stamped A P
N. 8° 30' E.	4.40	"	Set an iron post for angle point with brass cap stamped A P
N. 31° 15' E.	5.20	"	Set an iron post for angle point with brass cap stamped A P
N. 85° 45' E.	3.70	"	to M. C. of sec. 5, which is 13.74 chs. N. 0° 7' W. of 1/16 sec. cor. No. 8 bet. the NW. and SW. $\frac{1}{4}$ s of sec. 5.
S. 76° 30' E.	4.00	"	Set an iron post for angle point with brass cap stamped A P
S. 62° 30' E.	4.00	"	get an iron post for angle point with brass cap stamped A P
S. 52° E.	9.00	"	Set an iron post for angle point with brass cap stamped A P
S. 29° 15' W.	6.22	"	to M. C. of sec. 5, which is 11.50 chs. East of the 1/16 sec. cor. No. 8 bet. the NW. and SW. $\frac{1}{4}$ s of sec. 5, the place of beginning.

Land, level.  
Soil, 2nd rate.  
Brush, sage.

March 9, .1911: Cloudy at noon; no observation for latitude.

---

## Meanders, T. 3 N., R. 7 E.

Meanders of the right bank of Salt River, up stream.

March 9, 1911, I commence at the meander cor. of secs. 4 and 33, which M. C. is 1 ch. East of cor. of secs. 4, 5, 32 and 33, on the S. bdy. of the tp., both corners previously described.

Thence I run with meanders in sec. 33,

Along the right bank of Salt River (which river is part of the South and East bdy. of Salt River Indian Reservation), up stream,

Over level land, through brush, along bank 5 ft. high.

N. 28° 0' E. 9.00 chs. Set an iron post for angle point with brass cap stamped A P

N. 49° 30' E. 11.50 " Set an iron post for angle point with brass cap stamped A P

N. 53° 30' E. 13.00 " Set an iron post for angle point with brass cap stamped A P

N. 75° 30' E. 6.62 " to M. C. on East bdy. of old Camp McDowell Reservation, which is 55.63 chs. S. 6° 45' W. from C. C. of secs. 28 and 33, both corners previously described.

Land, level.  
Soil, 2nd and 3rd rate.  
Mesquite brush.

- March 9, 1911.



## General description, T. 3 N., R. 7 E.

## GENERAL DESCRIPTION.

The portion of T. 3 N., R. 7 E., which is within the Salt River Indian Reservation, contains two kinds of land, rolling and rocky, 4th rate, and flat and sandy along river, 2nd rate.

Verde River runs Southerly through secs. 5, 6, 7, 8, 18, 19, 20, 29, 30, 31, 32. At the time of survey it was very low, being from  $2\frac{1}{2}$  to 4 ft. deep.

Sycamore Wash runs Westerly through secs. 4 and 5, into Verde River. At time of survey, it was dry.

There is very little land East of the Verde River fit for cultivation, but almost all of the land West of the river, except sec. 31 and the S.  $\frac{1}{2}$  of sec. 30, can be cultivated when cleared.

There are groups of Indian huts all along the West side of the river, but none on the East side.

The quarters of the Indian Superintendent are in the North  $\frac{1}{2}$  of sec. 6. An artesian well and windmill are in the NE.  $\frac{1}{4}$  of sec. 6.

There is a fringe of cottonwood trees along the West bank of the river, but on the East side the mesquite extends to edge of the bank.

Robert A. Farmer,

Topographer and U. S. Surveyor.

**CERTIFICATE OF ASSISTANTS.**

We, the undersigned, hereby certify upon honor that we assisted, to the best of our skill and ability, **Robert A. Farmer, Topographer**, U. S. Surveyor, during the periods and in the capacities stated opposite our several signatures, in surveying all those parts or portions of **Salt River Indian Reservation (including old Camp McDowell Reservation)** **Arizona,**

**Subdivision and meanders T. 3 N., R. 7 E.,**

of the **Gila & Salt River Principal** Meridian, in the State of **Arizona** which are represented in the foregoing field notes as having been executed by him, and under his direction; and that said survey has been, in all respects, to the best of our knowledge and belief, well and faithfully executed.

NAME.	PERIOD OF SERVICE.		CAPACITY.
	BEGUN.	ENDED.	
<b>A. H. Greene</b>	<b>Dec. 5, 1910</b>	<b>Mar. 29, 1911</b>	<b>Instrumentman.</b>
<b>T. H. Biedenkopf</b>	<b>do.</b>	<b>do.</b>	<b>Chainman.</b>
<b>Joe H. Walker,</b>	<b>Jan. 23, 1911</b>	<b>do.</b>	<b>do.</b>
<b>Frank Cable,</b>	<b>Feb. 10, 1911,</b>	<b>do.</b>	<b>Flagman.</b>
<b>Ed Hurwits,</b>	<b>Dec. 5, 1910</b>	<b>do.</b>	<b>Moundman.</b>
<b>John B. Smith,</b>	<b>Jan. 23, 1911</b>	<b>Mar. 22, 1911</b>	<b>Axman.</b>

Subscribed and certified to before me on the dates of the final service as shown above.

**Robert A. Farmer, Topographer.**  
U. S. Surveyor.

104  
180  
BOOK 2395

FINAL OATH OF UNITED STATES SURVEYOR.

I, **Robert A. Farmer, Topographer**, <sup>GLO</sup> U. S. Surveyor, do solemnly swear that, in pursuance of special instructions received from the ~~U. S. Surveyor General for~~ <sup>Commissioner of the</sup> **General Land Office** bearing date of the 11th day of October, 1910, I have well, faithfully, and truly, in my own proper person, and in strict conformity with said instructions, the Manual of Surveying Instructions, and the laws of the United States, surveyed all those parts or portions of

Salt River and Camp McDowell Reservations

of the Gila and Salt River ~~Principal~~ Meridian, in the State of Arizona, which are represented in the foregoing field notes as having been ~~executed~~ <sup>surveyed</sup> by me, and under my direction; and I do further solemnly swear that all the corners of said survey have been established and perpetuated in strict accordance with the Manual of Surveying Instructions, ~~and the special written instructions of the U. S. Surveyor General for~~ and in the specific manner described in the field notes, and that the foregoing are the original field notes of such survey.

Robert A. Farmer, Topographer  
U. S. Surveyor.

Subscribed by said Robert A. Farmer, and sworn to before me }  
this 15th day of May, 1911.



Frank S. Ingalls  
Surveyor-General of Arizona.

APPROVAL.

**Commissioner of the General Land Office**  
**OFFICE OF THE UNITED STATES SURVEYOR GENERAL**

March 29th, 1913.

The foregoing field notes of the survey of subdivision and meanders of T. 3 N., R. 7 E., Salt River Indian Reservation, Arizona,

executed by Robert A. Farmer, Topographer and U.S. Surveyor, under supervision of A. P. Dunnington, Topographer in Charge of Indian Surveys, under his special instructions dated October 11-, 1910, having been critically examined, and the necessary corrections and explanations made, the said field notes, and the surveys they describe, are hereby approved.

(Signed) Fred Dennett

<sup>U. S. Surveyor General</sup>  
**Commissioner of the General Land Office**, Salt River

I certify that the foregoing transcript of the field notes of the above-described surveys in Indian Res'n, Arizona,, has been correctly copied from the original notes on file in this office.

Fred Dennett  
U. S. Surveyor General.

**Commissioner of the General Land Office**

105  
BOOK 2396

Washington, D. C., July 15

1911

I hereby certify that the survey of the subdivision and meanders of T. 3 N., R. 7 E., Salt River Indian Reservation, Arizona, was made under my direction and supervision, and to the best of my knowledge and belief the field work was executed in strict accordance with the special instructions given me, dated October 11, 1910, and the Manual of Surveying Instructions, and that these field notes are a correct representation thereof.

*A. F. Drumming, Jr.*

Topographer in Charge.