

10



EDITH













EDITH

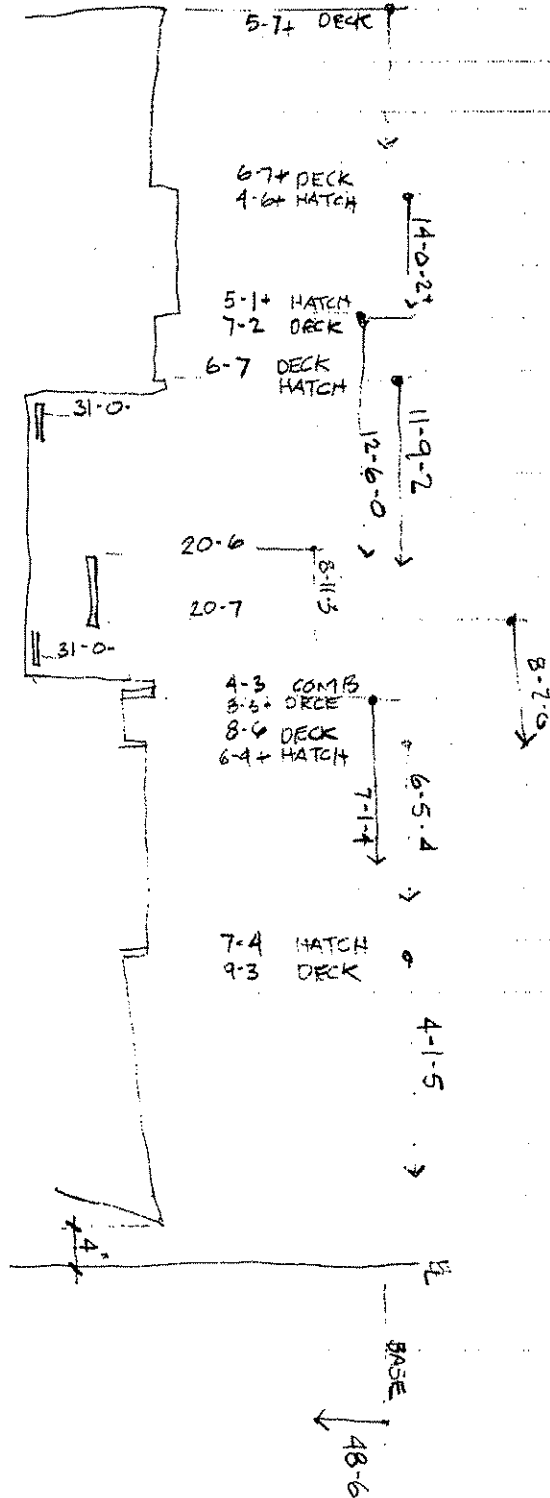





















Grand Canyon National Park – Small Craft Collection  
 Documentation Project – August 8 – 13, 2003

Boat Name: EDITH

Catalog No.: \_\_\_\_\_

Acq. No.: GRCA -

**Station No.:** 15  
 AFT 2<sup>7</sup>/<sub>8</sub>"

Station Notes:

BASE OFFSET = 27.3

Point	Vert.	Horz.		C	L
T.O. DECK	47-6-	4			
T.O. SHR	39-6	9-3	18		
BTM SHR	32-4+	10-1-	17.25		
2	28-1-	11-5+	15.75		
3	24-2+	13-4+	13.875		
CHINE	21-2+	15-6	11.625		
Rabbit					
Keel		0-0			

Base

Measurement Notes:

Measured by: \_\_\_\_\_ Date: \_\_\_\_\_



EDITH  
 T. BLOCH  
 8-12-03

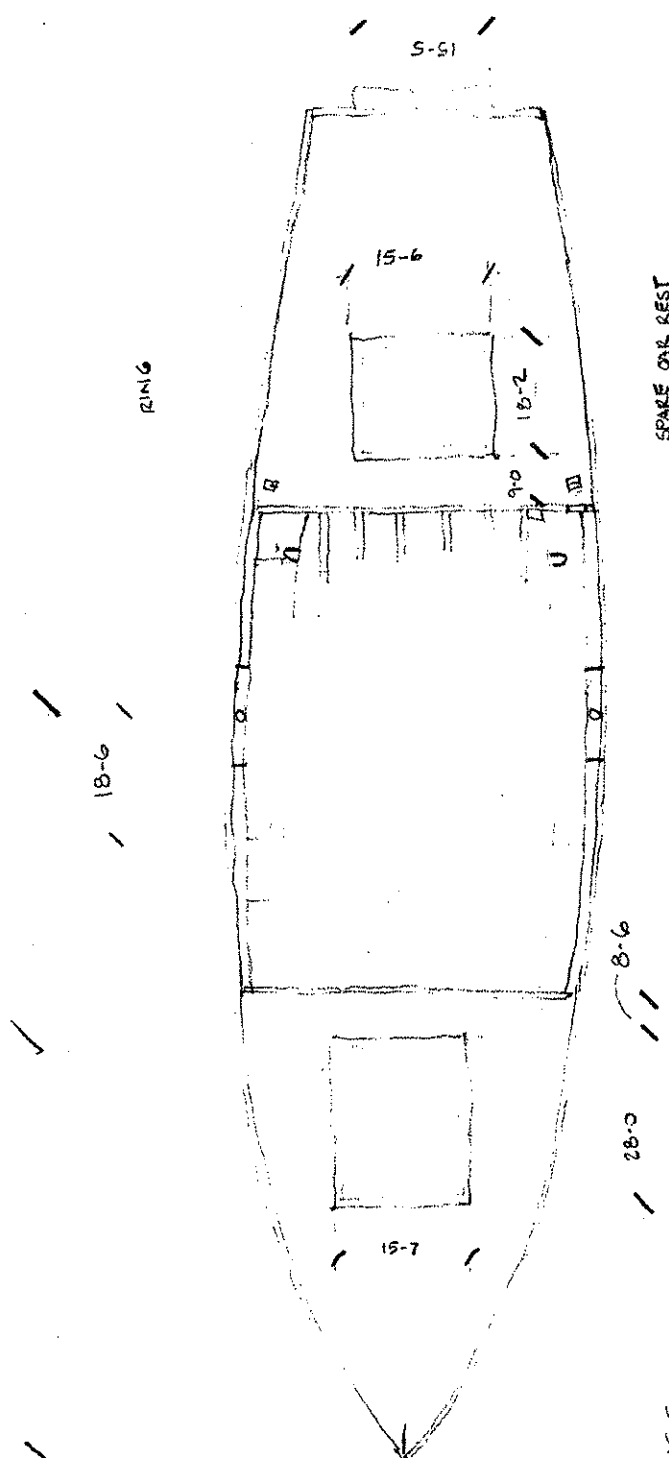

- SCANTLINGS
- FRAMES  $1/8 \times 7/8$
  - DECK BEAMS  $1/2 \times 7/8$
  - DECK PLANKING  $3/8$
  - COMINGS  $5/8$
  - RUB RAIL  $1/8 \times 1/2$
  - PLANKING  $1/2$
  - RISE  $1/8 \times 1/8$
  - SHEAR CLAMP  $2/8 \times 1/8$
  - SHELF  $2/4 \times 1/2$
  - BTM PLANKING
  - THICKART  $7/8$
  - FLOORS  $1/8 \times 7/8$
  - CHINE LOG  $2 \times 1/4$

EDITH  
T. BLOCH  
8-18-03

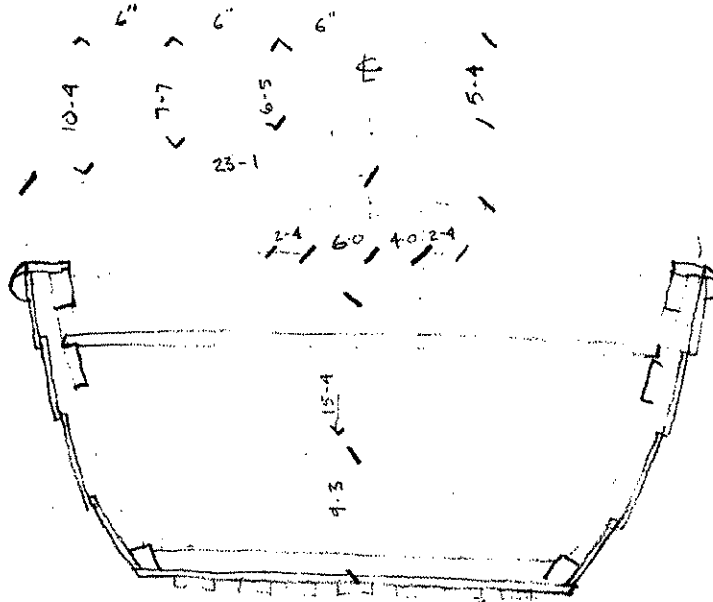

SECTION AFT OF THWART - VIEW FRWD

3/4 x 1/4

CENTERED OVER  
PLANK JOINTS.

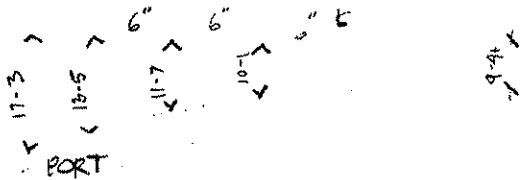

DECK CROWN FRWD. OF FRWD SPLASH GUARD

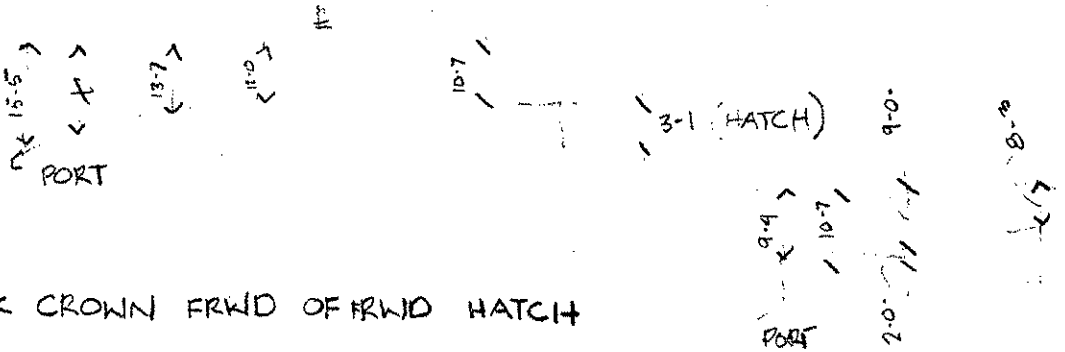

DECK CROWN FRWD OF FRWD HATCH

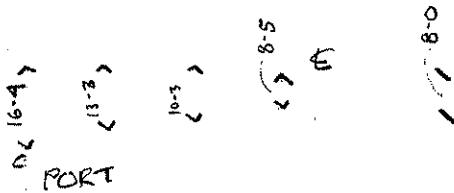

DECK CROWN AFT OF AFT SPLASH GUARD

EDITH  
T. BLOCH  
8-12-03

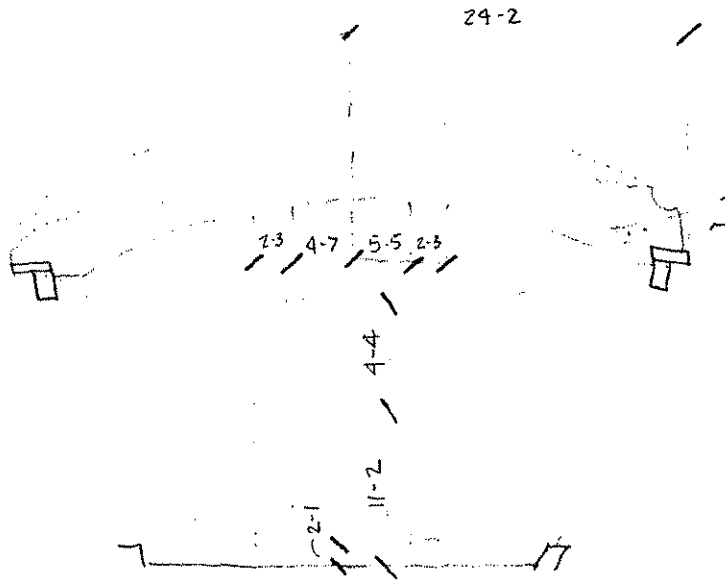

SECTION AFT OF THWART, VIEW AFT

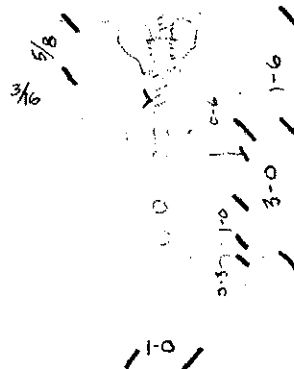
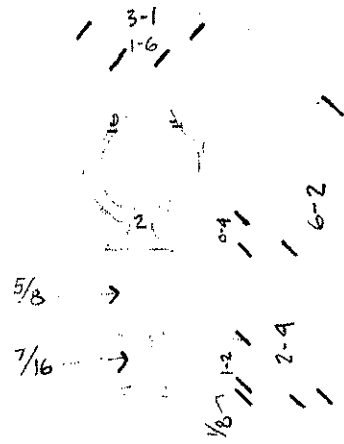
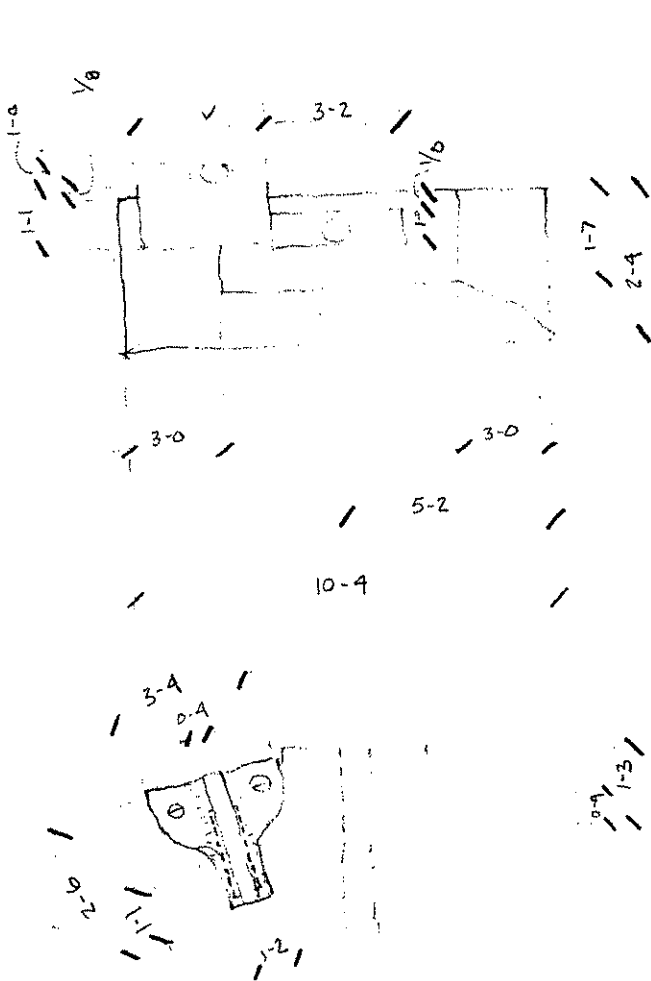

LATCH

EDITH  
T. BLOCH  
8-12-03

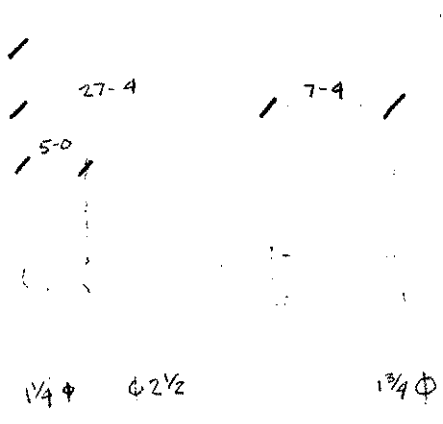
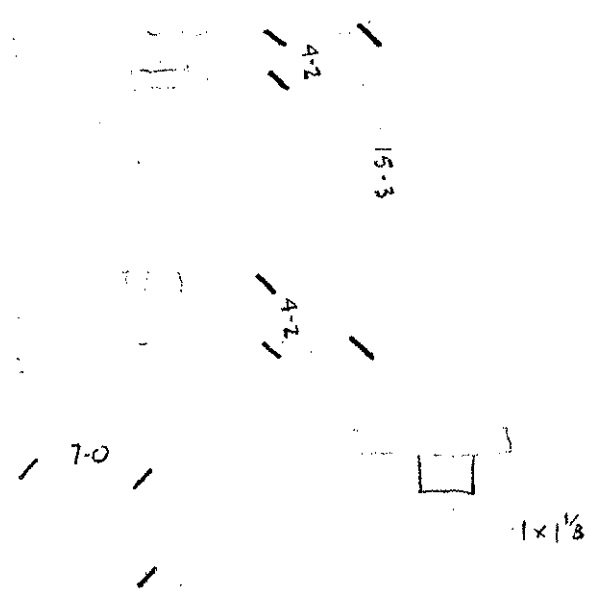
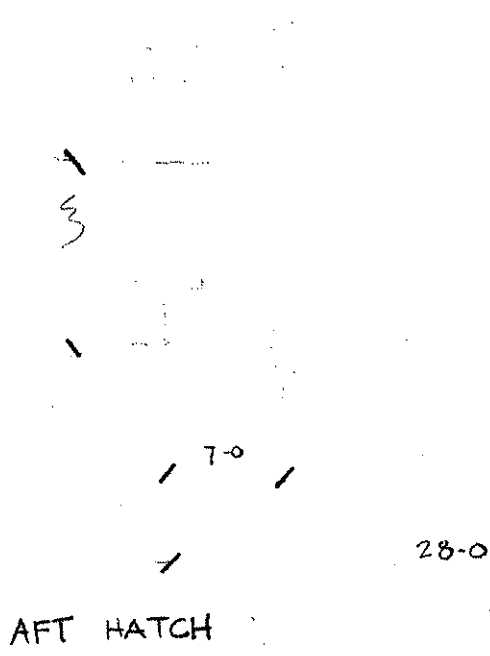

OAR (STONE)





EDITH  
T. BLOCH  
8.12.03

3-2 5-4

AT AFT COMING

DECK PLANKING - AFT

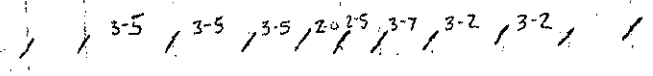

BOTTOM PLANKING

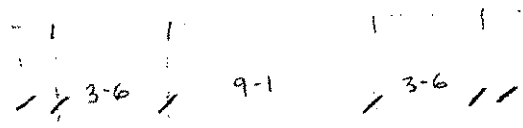

FORWARD HATCH COVER

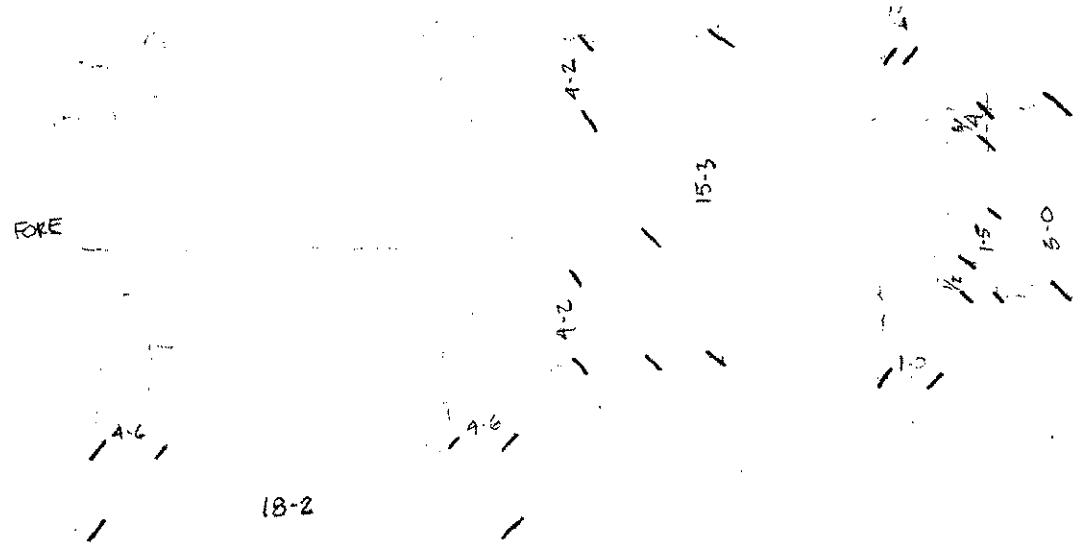

EDITH  
T. BLOCH  
8.12.03

MEASURED ON CURVE

7.2 10.0 /

6.0  
4.4  
4.0

1.1.4

1.10.4

2.7.4

3.5.0

4.1.0

4.10.0

5.7.5

6.4.6

MEASURED ON CURVE

8.3.0

6.0

4.2

4.2

11.0.0

5.6

4.6

4.2

19.6

9.0

8.6

9.1

9.6

9.4

MEASURED ON CURVE

STARBOARD  
REPAIR AREA

4.0

10.2

2.14

2.15

5.0

2.0

5.0

19.4

EDITH  
T. BLOCH  
8-12-03

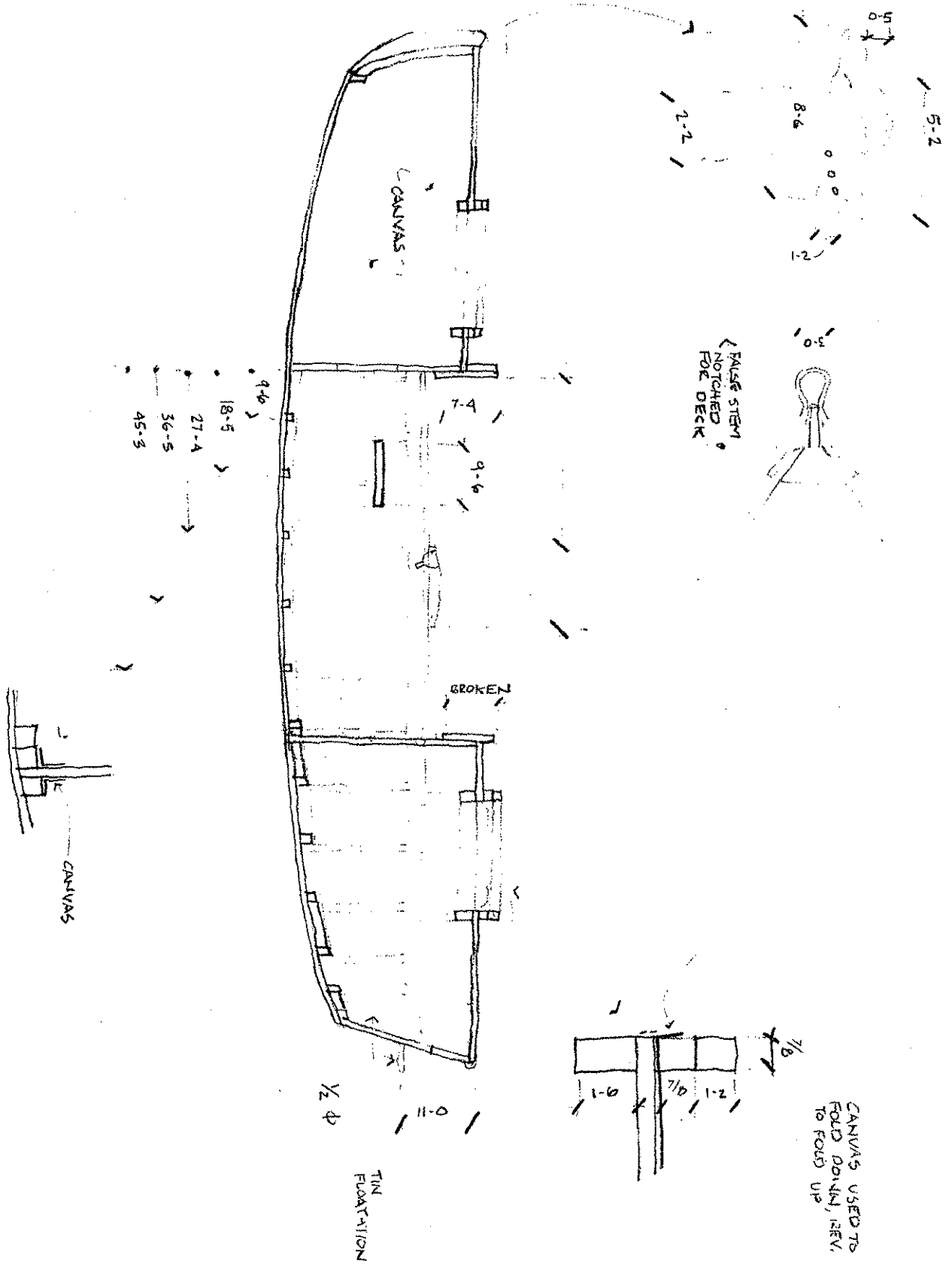

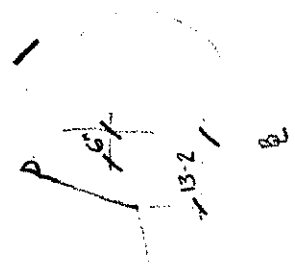
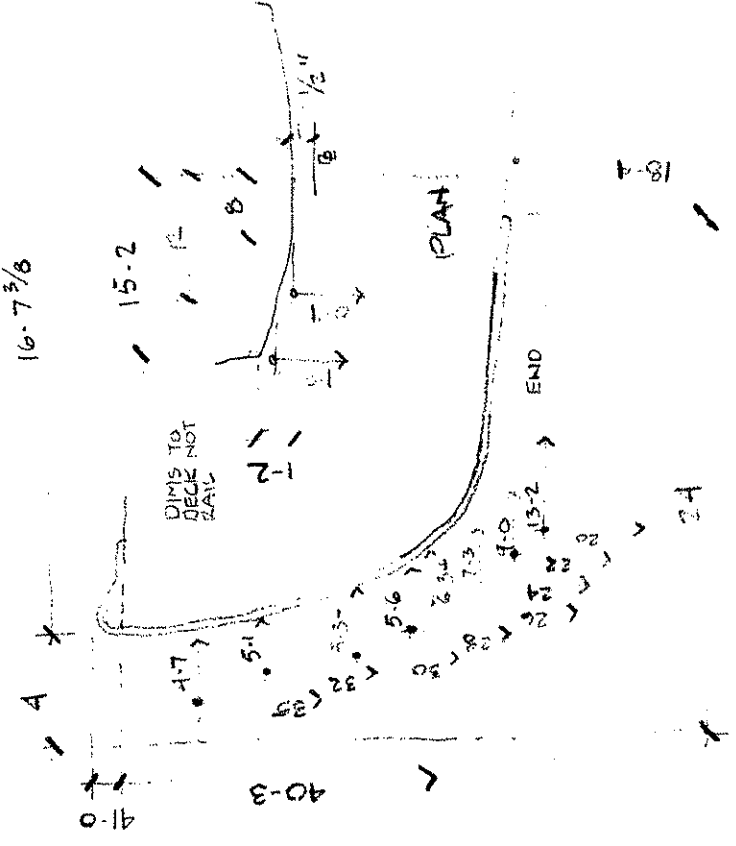
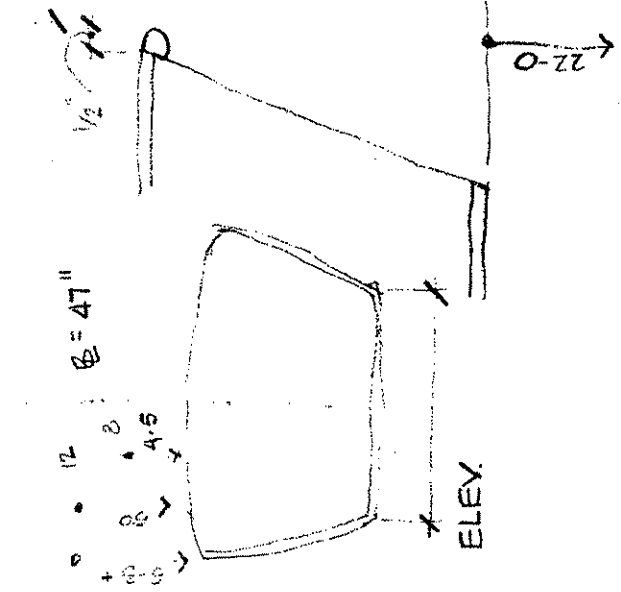

TO SHR PROJECTED  
TO STEM 40-3

**GLEN**











GLEN



51-12 = T.O. OF STEM (HALF ROUND)

STEM

V	H
44-1	4-3
45	4-4+
42	4-5
41	4-6-
40	4-6+
38	5
36	5-4
34	6-2-
32	7-3+
30	9-4
28-5+	12-5

V = 28-7

H = 13-7

OFFSET

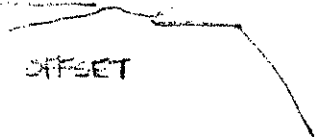

Grand Canyon National Park – Small Craft Collection  
Documentation Project – August 8 – 13, 2003

Boat Name: GLENI

Catalog No.: \_\_\_\_\_

Acq. No.: GRCA -

Station No.: 1

Station Notes:

\_\_\_\_\_  
\_\_\_\_\_  
\_\_\_\_\_

Ø 36"

Point	H Vert	V Horz
TO. SHEAR	31-0	47-2
BTM SHEAR	31-0	40-6
2	30-7	36-1+
3	32-0	32-0+
CHINE		

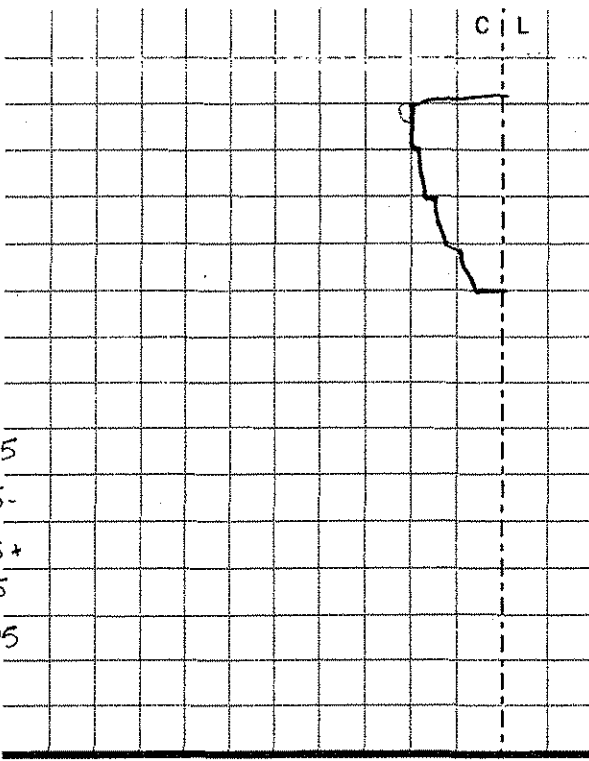

TO. DECK @ 4	44-3	
TO SHEAR	7-2	47-4-
B. SHEAR	7-4-	40-7+
4	7-4+	36-3
3	8-6	31-3
CHINE Rabbit	11-1	27-5+
<del>CHINE</del>		0-0

5.75  
5.5-  
5.5+  
4.25  
1.875

H.  
BASE @  
13"

Base

Measurement Notes:

\_\_\_\_\_  
\_\_\_\_\_  
\_\_\_\_\_

Measured by: \_\_\_\_\_

Date: \_\_\_\_\_























GLEN  
T. BLOCH  
8-13-03

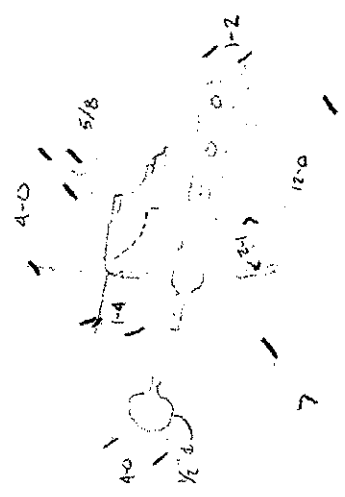

LETTERS - 8 1/2"

14-0 10-4

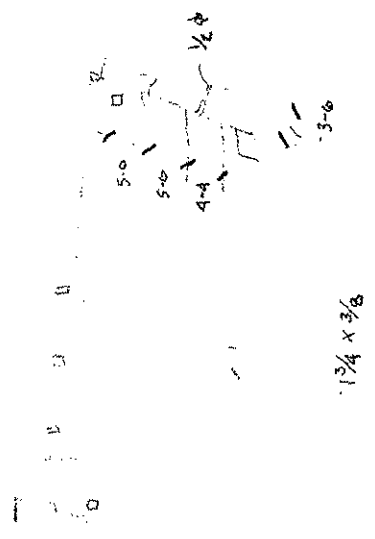
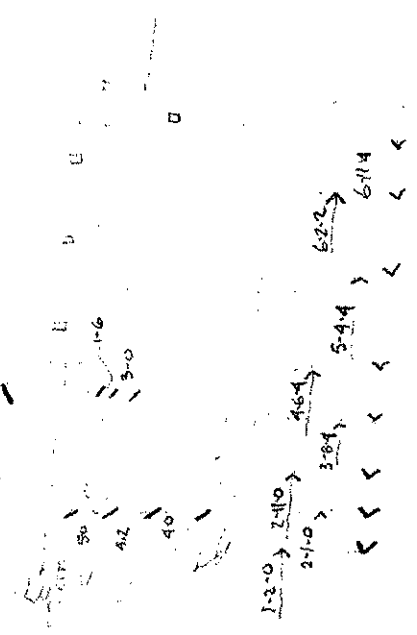

5-0  
4-4  
4-3

GLEN  
T. BLOCH  
8.13.03

HATCH BEAM IS CONT.  
DECK BM. FRAMES INTO  
HATCH BM.

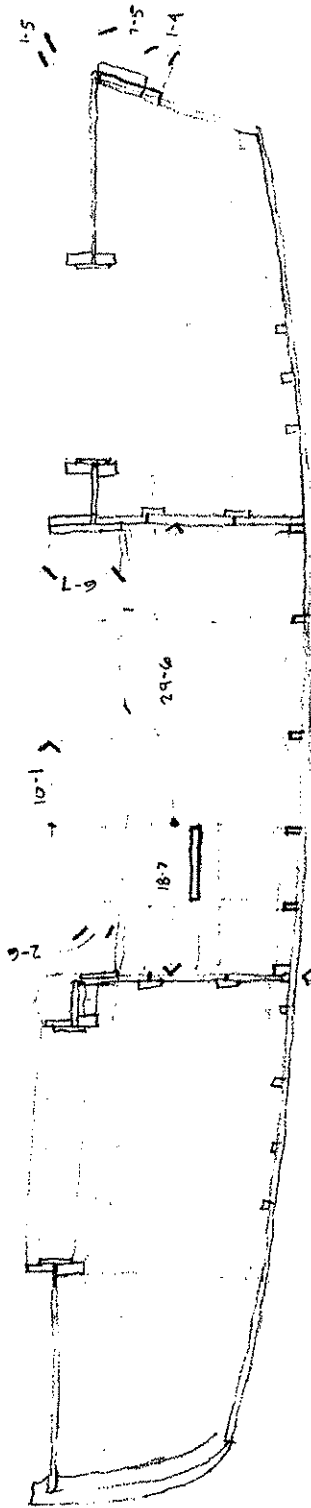

SCANTLINGS

PLANKING = 1/2"

RUBRAL = 3/4 x 1/4

DECK = 1 3/8" WIDE

TIMBER = 7/8"

FRAMES 1/4 x 7/8

FLOORS 1/4 x 7/8

CHINE /

PR BDS, 5" x 5/8" (3/4" SPACING)

RISE = 2 1/4 x 3/4

SHELF = 3" x 3/8"

CLAMP = 3 x 1 1/4

~~DECK PLANKS~~

DECK BEAM = 7/8"

CANVAS SIM.  
TO EDITA

↑  
↓

↑  
↓

SPLASH GUARD

↑  
↓

GLEN  
T. BLOCH  
8.13.03

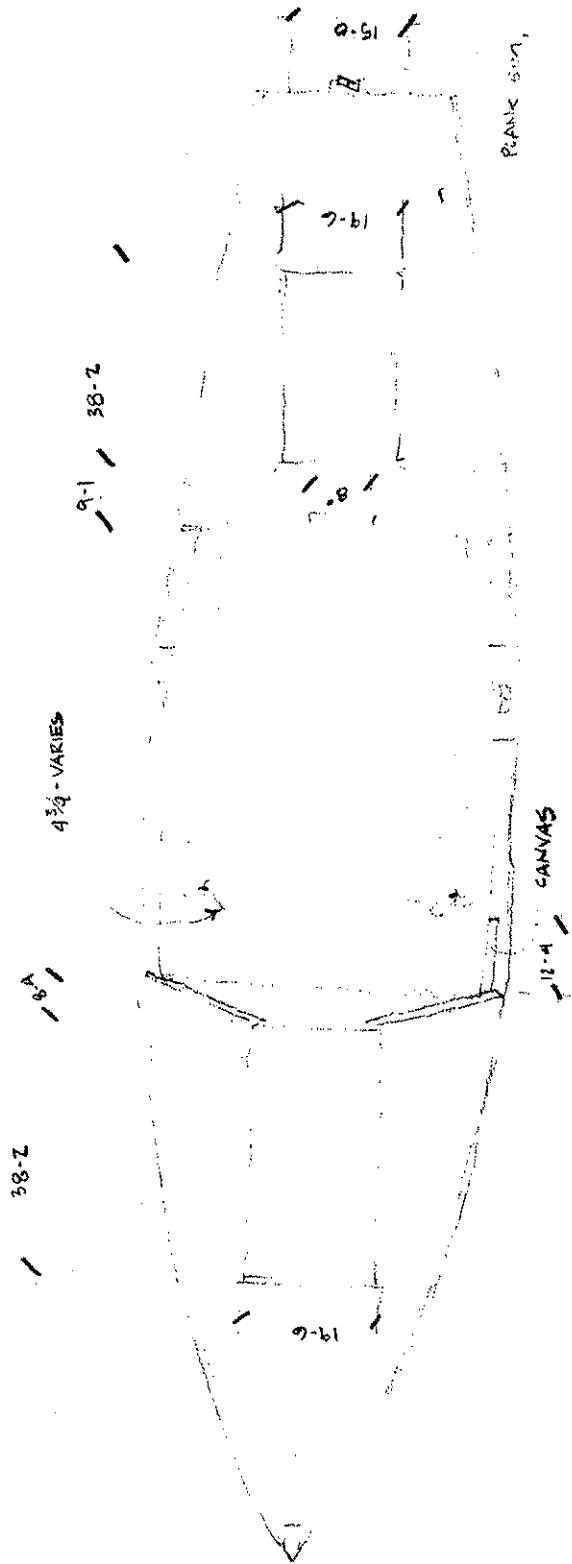



GLEN  
T. BLOCH  
8-13-03

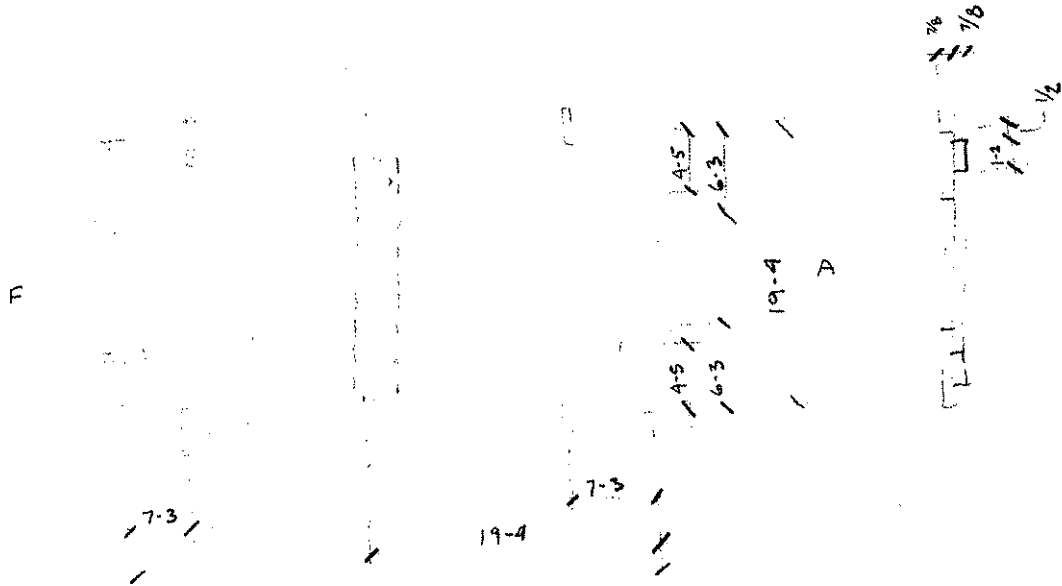

FORWARD HATCH COVER

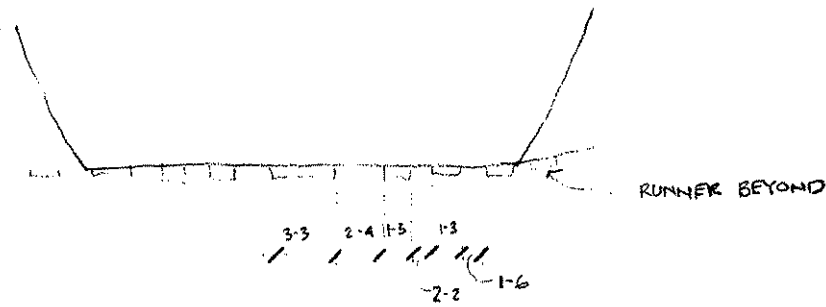

BOTTOM RUNNERS

GLEN  
 T. BLOCH  
 8-13-03

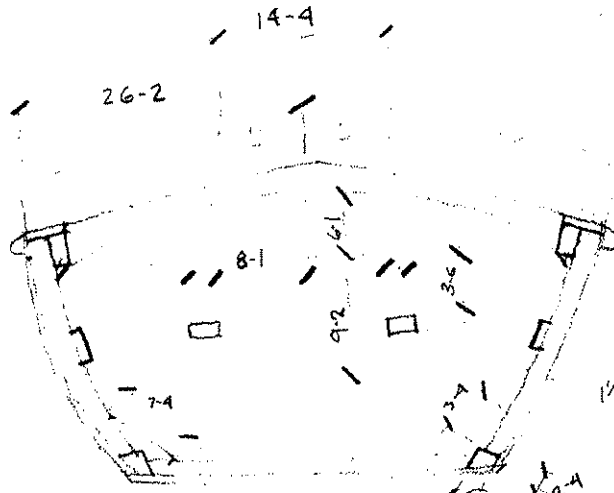

2-0 x 3/4 (BEVELLED EDGES)

1/2 x 2 1/2 x 3/8 3/8 7/8

SECTION FRWD OF THWART, VIEW FRWD.

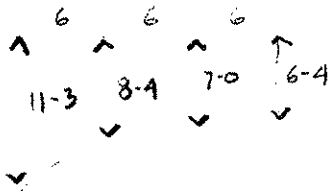

DECK FRWD OF FRWD HATCH

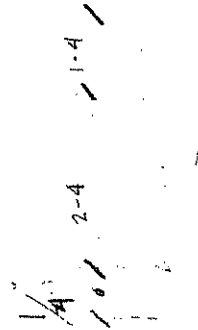

HATCH

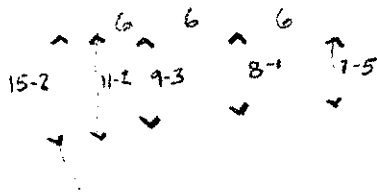

DECK AT FRWD. BKHD.

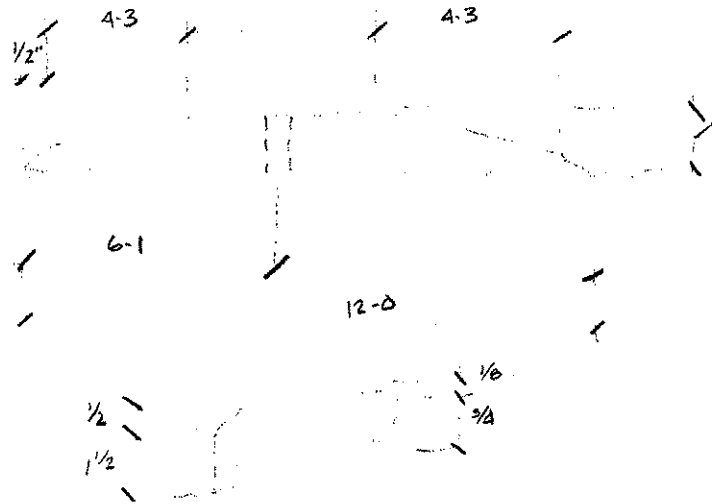

OAR LOCK PAD

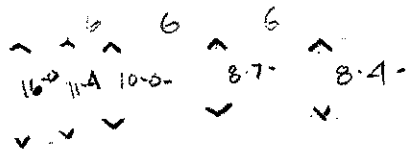

DECK AT AFT BKHD.

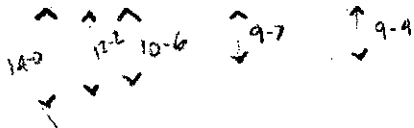

DECK AT AFT HATCH

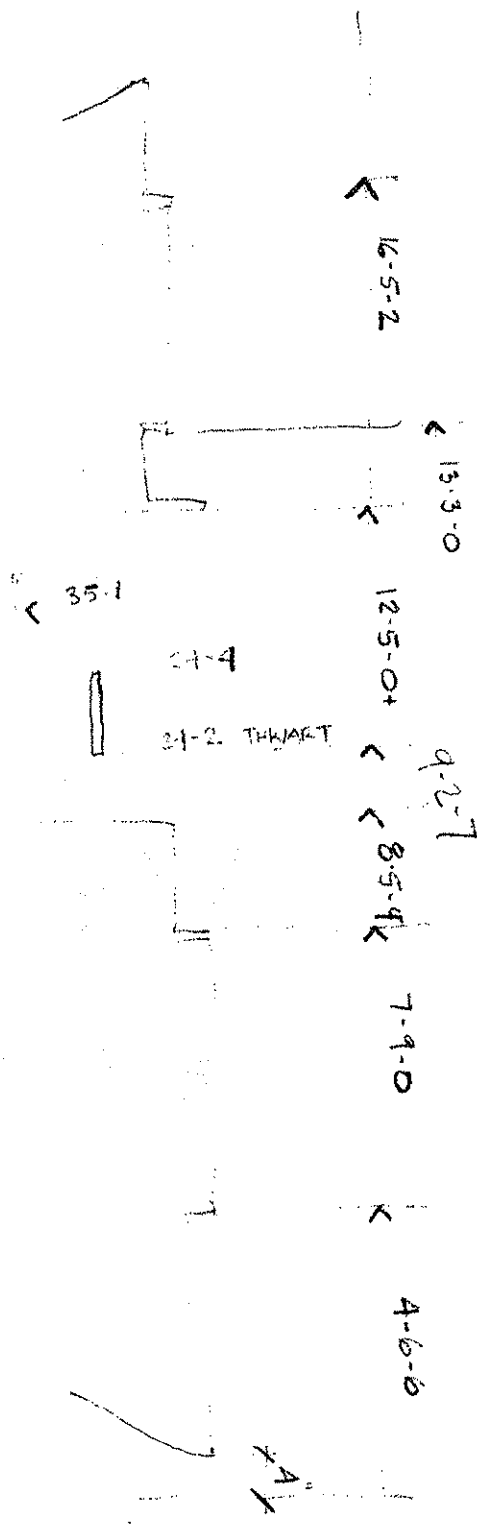

12-4 DECK

12-2 DECK  
9-7 HATCH

9-2 HATCH  
11-3 COMBING  
11-2 DECK  
7-1 COMBING

10-1X DECK

9-7 DECK  
7-5 HATCH

6-5 HATCH  
8-5 DECK

55-4

**STONE**





**NOTES**

- 1. THE STONE BOAT WAS DESIGNED BY THE OWNER.
- 2. THERE WAS NO KNOWLEDGE OF WINDSHIELD ON THE BOAT.
- 3. THE BOAT WAS CONSTRUCTED FROM STEEL AND WOOD.
- 4. THE BOAT WAS CONSTRUCTED IN THE SUMMER OF 1924.
- 5. THE BOAT WAS CONSTRUCTED IN THE SUMMER OF 1924.
- 6. THE BOAT WAS CONSTRUCTED IN THE SUMMER OF 1924.

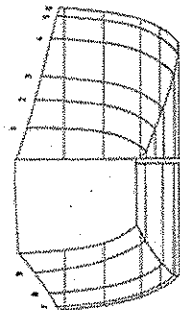
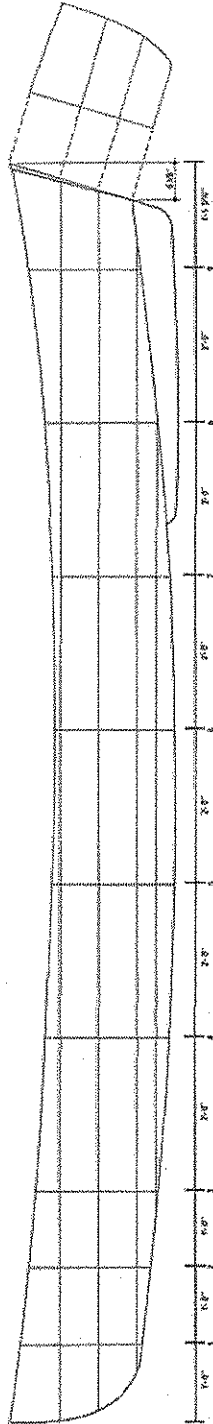
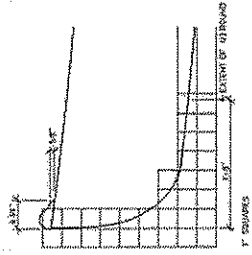

FIG. 11  
FIG. 12  
FIG. 13  
FIG. 14  
FIG. 15

**TABLE OF DIMENSIONS**

STATION	1	2	3	4	5	6	7	8	9	10	11	12	13	14	15	16	17	18	19	20	
Overall Length	0.0	2.0	4.0	6.0	8.0	10.0	12.0	14.0	16.0	18.0	20.0	22.0	24.0	26.0	28.0	30.0	32.0	34.0	36.0	38.0	40.0
Hull Breadth	0.0	1.0	2.0	3.0	4.0	5.0	6.0	7.0	8.0	9.0	10.0	11.0	12.0	13.0	14.0	15.0	16.0	17.0	18.0	19.0	20.0
Hull Depth	0.0	0.5	1.0	1.5	2.0	2.5	3.0	3.5	4.0	4.5	5.0	5.5	6.0	6.5	7.0	7.5	8.0	8.5	9.0	9.5	10.0
Deck Height	0.0	0.2	0.4	0.6	0.8	1.0	1.2	1.4	1.6	1.8	2.0	2.2	2.4	2.6	2.8	3.0	3.2	3.4	3.6	3.8	4.0
Windshield Height	0.0	0.0	0.0	0.0	0.0	0.0	0.0	0.0	0.0	0.0	0.0	0.0	0.0	0.0	0.0	0.0	0.0	0.0	0.0	0.0	0.0
Weight	0.0	100	200	300	400	500	600	700	800	900	1000	1100	1200	1300	1400	1500	1600	1700	1800	1900	2000

Drawn by [Name], 10/24/24  
 A.S. [Name], 10/24/24  
 10/24/24





STONE

HEIGHTS

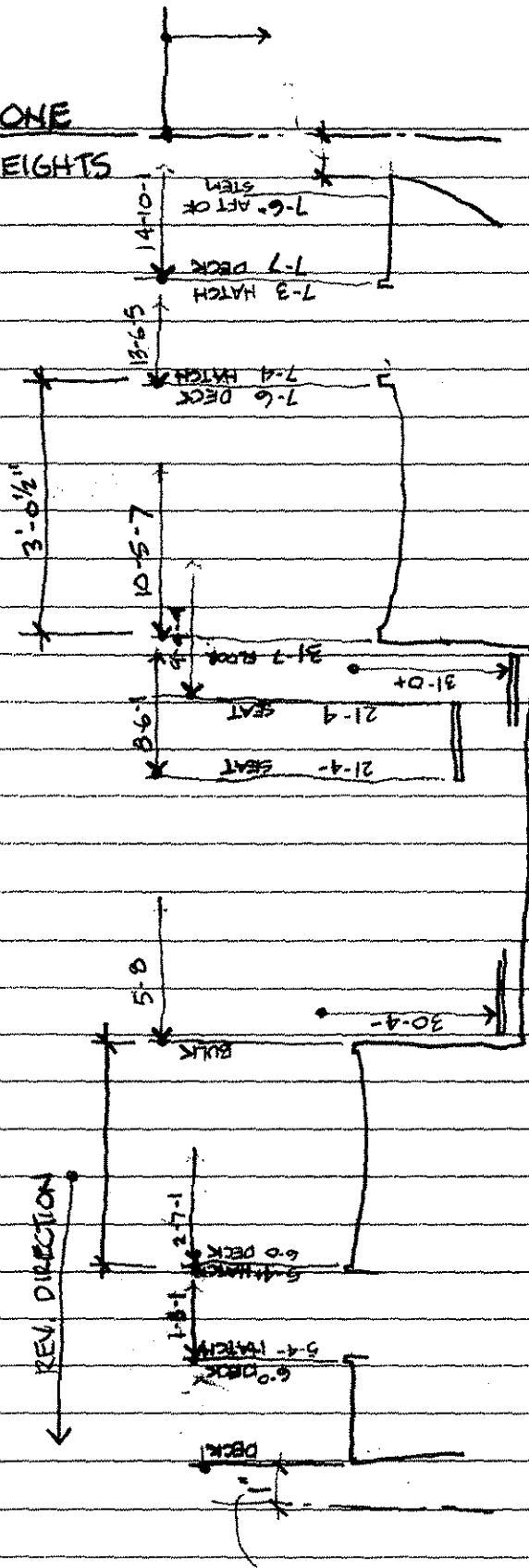

Grand Canyon National Park – Small Craft Collection  
Documentation Project – August 8 – 13, 2003

Boat Name: STONE

Catalog No.: \_\_\_\_\_

Acq. No.: GRCA-

Station No.: 1

Station Notes:

BASE OFFSET = 25-5

Point	Vert.	Horz.
<del>T.O. DECK</del>	<del>41-3-</del>	
<del>T.O. SHR</del>	<del>40-3-</del>	<del>21-2</del>
<del>BTM SHR.</del>	<del>34-3</del>	<del>20-7</del>
<del>2</del>	<del>29-5+</del>	<del>21-1</del>
<del>3(PLT)</del>	<del>25-4-</del>	<del>22-1-</del>
<del>CHINE</del>	<del>20-4</del>	<del>24-6+</del>
T.O. DECK	41-3	
T.O. SHR	40-0+	20-6 (4.875)
BTM SHR	34-3-	20-6 (4.875)
2	29-5	21-0- (4.625)
3(PLT)	25-4	21-7 (5.75)
CHINE	20-3	24-4 (1.125)
Rabbit		
Keel		0-0

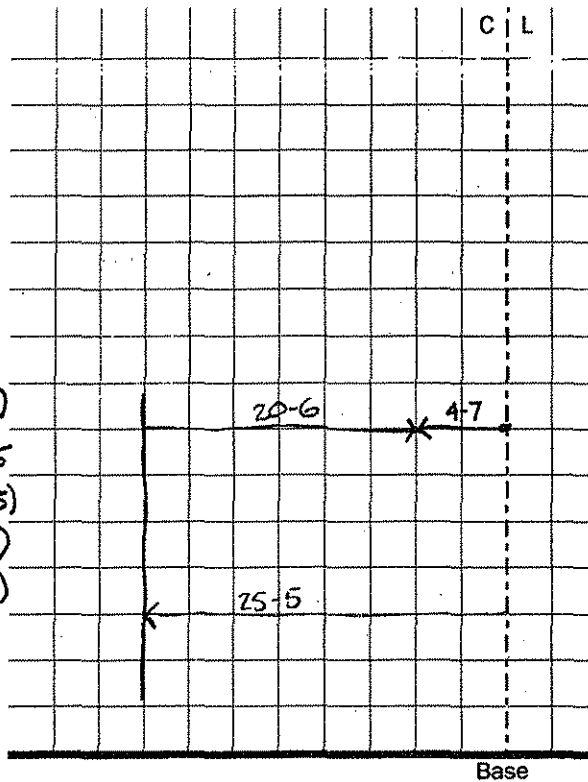

Measurement Notes:

Measured by: \_\_\_\_\_ Date: \_\_\_\_\_























STONE  
T. BLOCH  
8.13.03

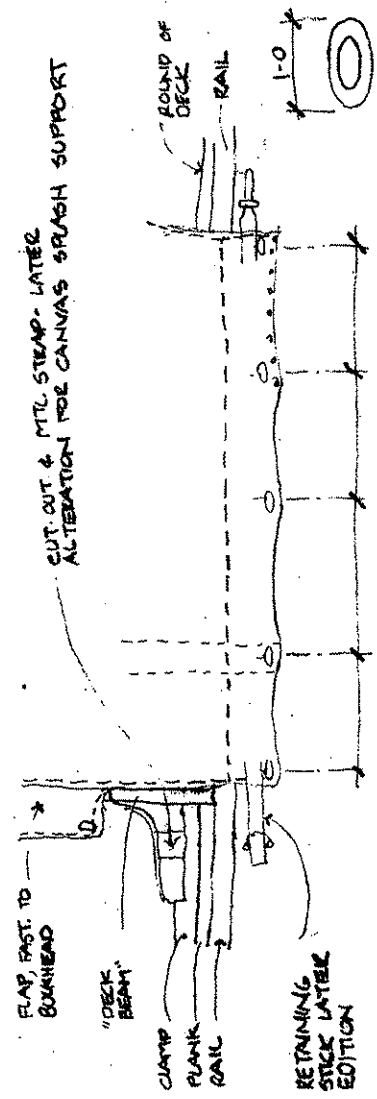
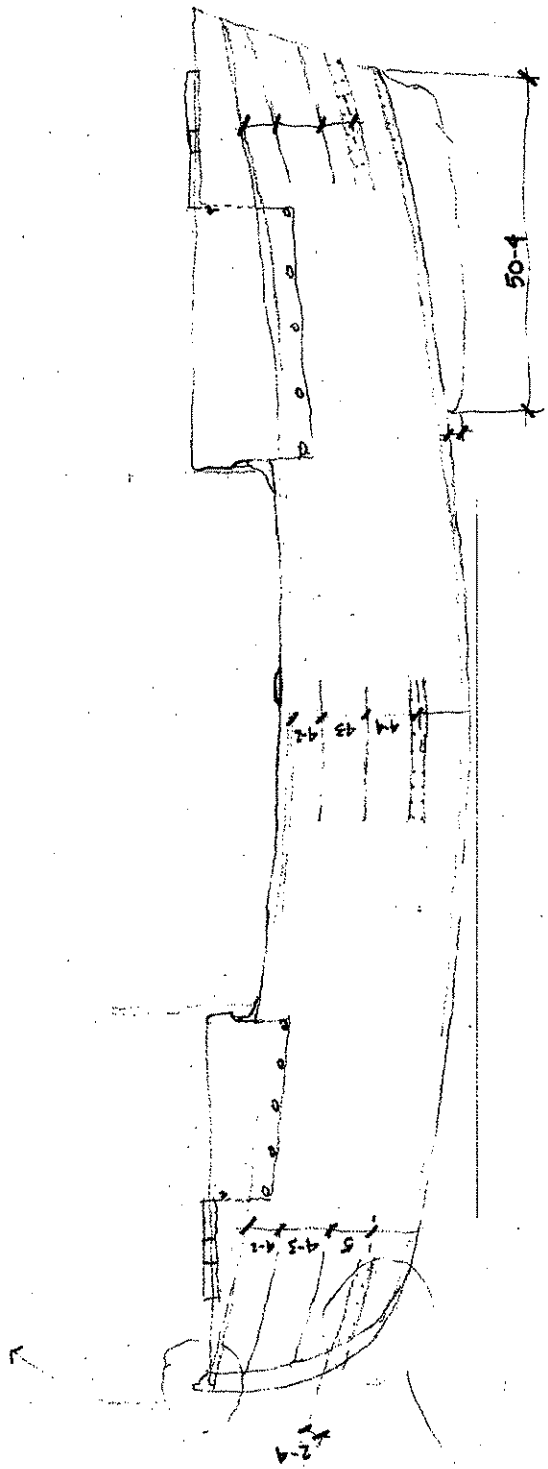
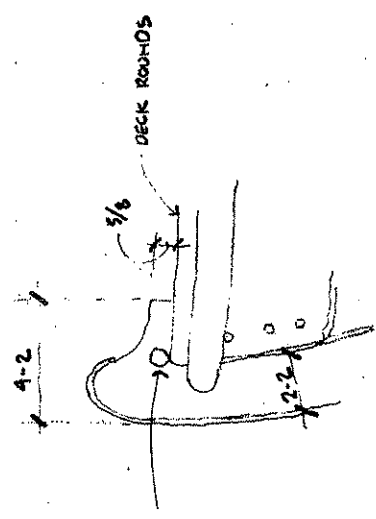

CANNAS CONNECTION, PORT, AFT

STONE  
T. BLOCH  
8-15-03

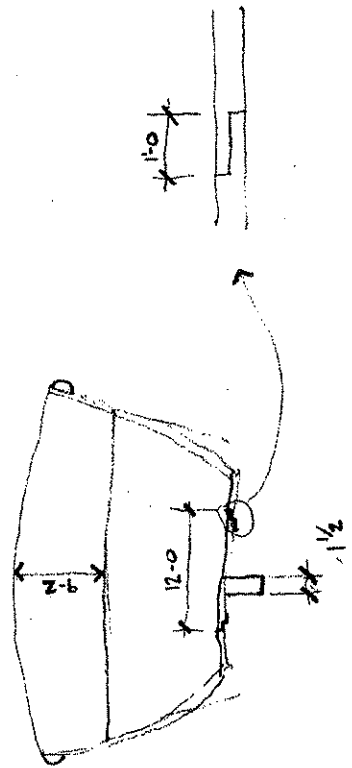
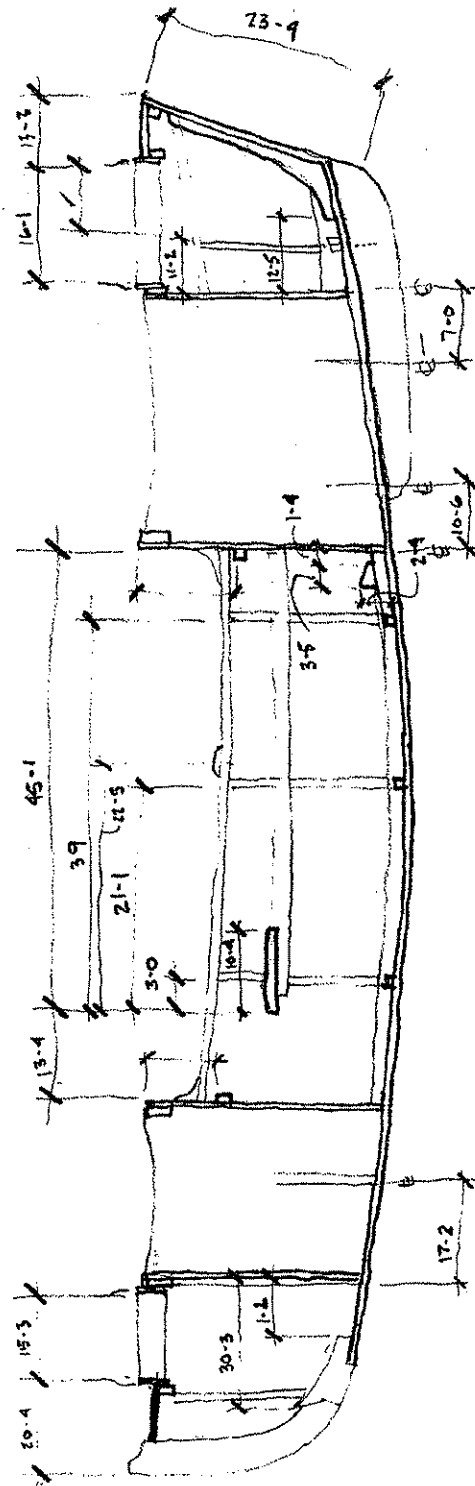

STONE  
T. BLOCH  
8.13.03

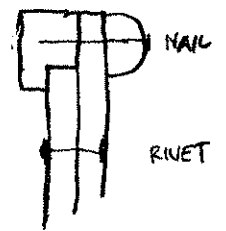
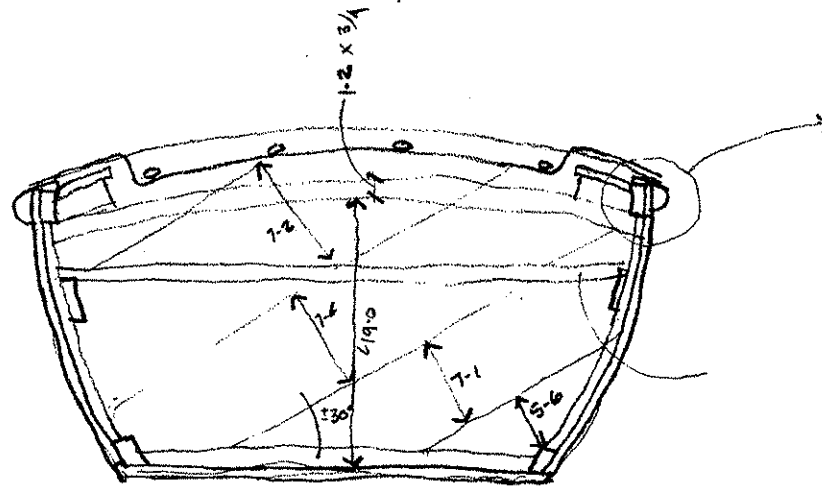

SECTION AFT OF THWART LOOKING FORWARD

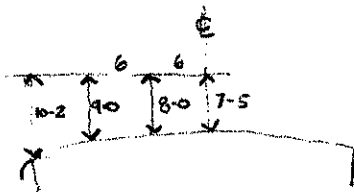
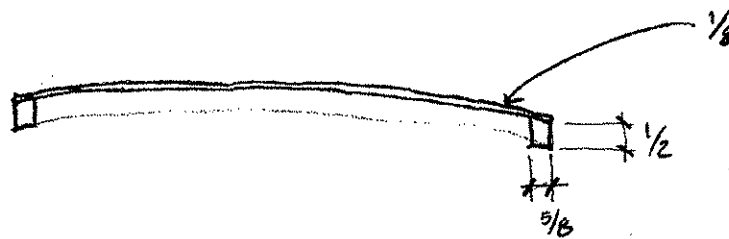

DECK CROWN AFT OF  
AFT HATCH

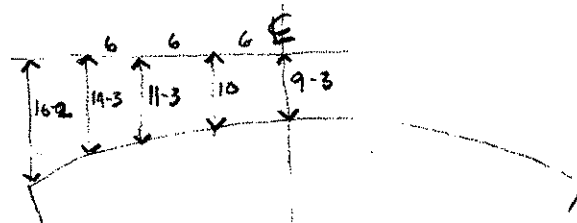

FRWD BULKHD,

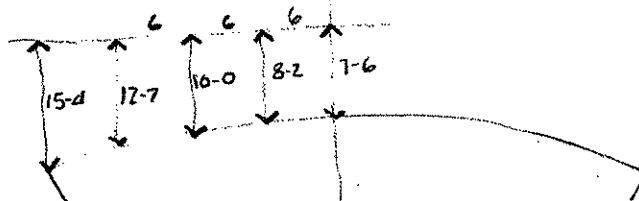
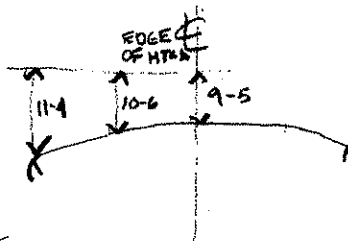

AFT BULKHD.

STONE  
8-13-03  
T. BLOCH

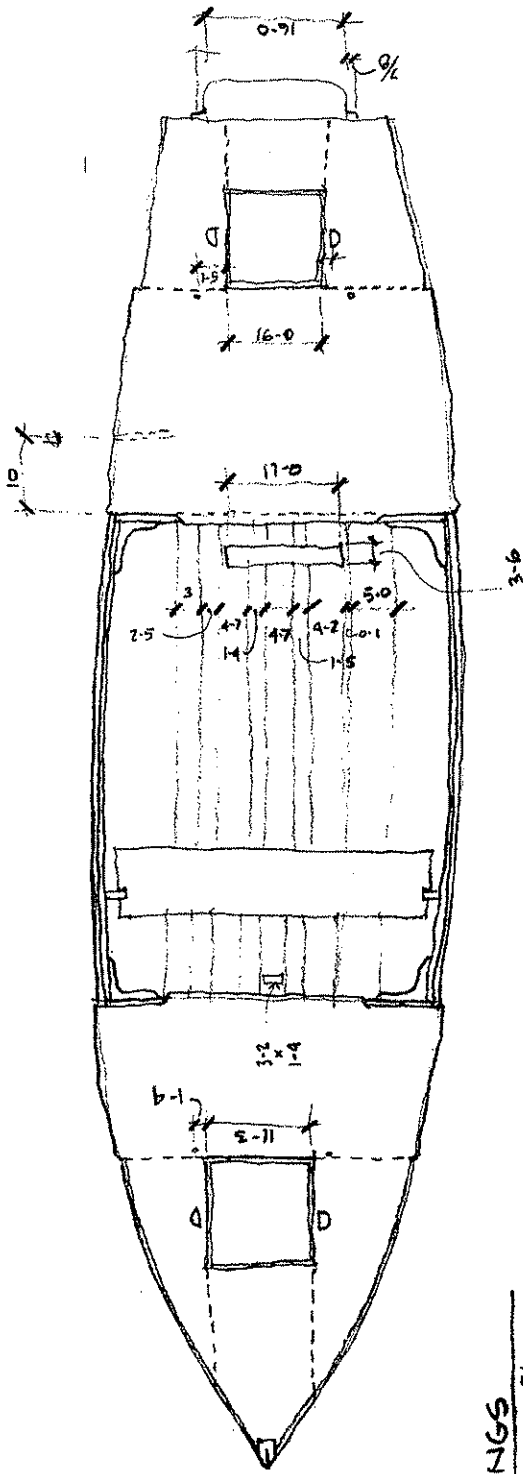

**SCANTLINGS**

PLANKING	5/8
RUB RAIL	1/4 x 3/4
DECK BEAMS	1/4 x 3/4
FRAMES	7/8 x 3/4
FLOORS	7/8 x 3/4
DECK	?
BOTTOM	5/8
FLOORBO	5/8
THWART	5/8
SWEEP	5/8
CLAMB	1/8 x 1 1/4"
RISER	2 1/4 x 1/2
BUSHHEADS	2 1/4
CHINE	2 1/4 x 1 1/8



STONE  
T. BLOCH  
S.B.03

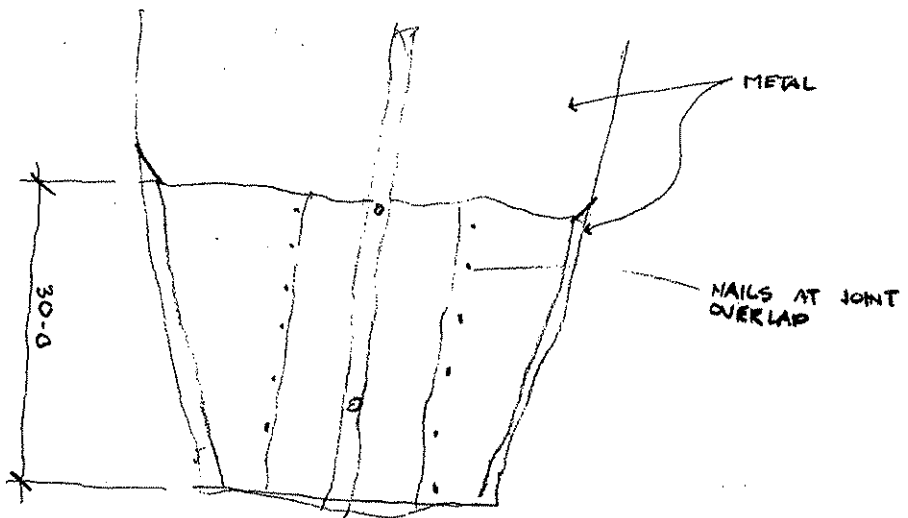

BOTTOM AT STERN

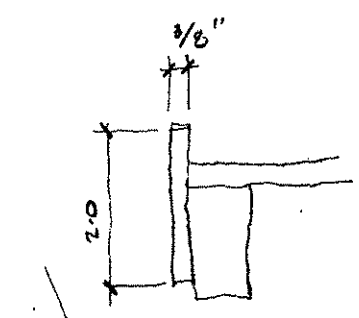

HATCH TRIM

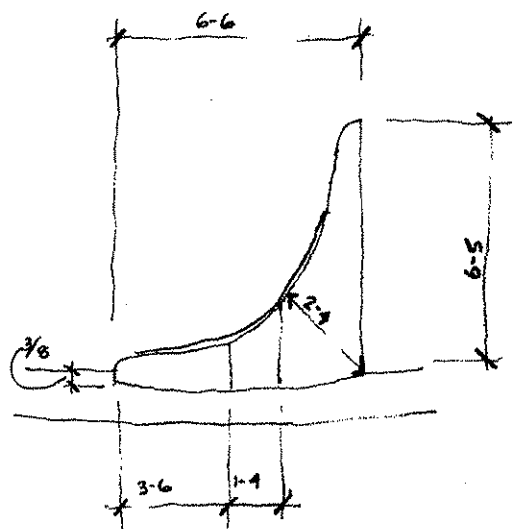

KNEE

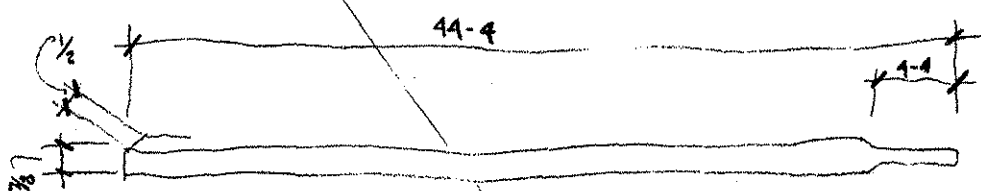

BATTEN

